

SKU

2STFR8RS (Singed Sided)
2STFR8RD (Double Sided)

CAUTION

Before starting the assembly, wear gloves to protect your hands.



Connect tubes by matching the numbers on the ends.

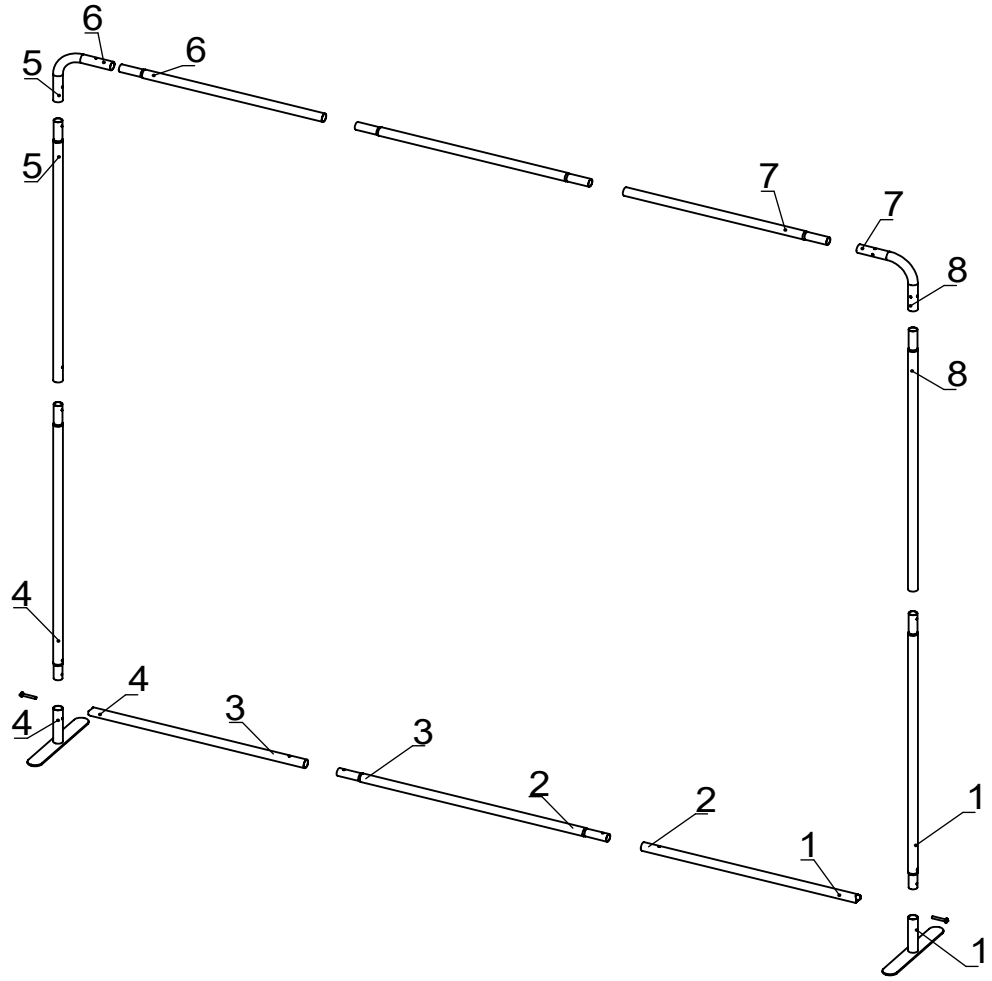
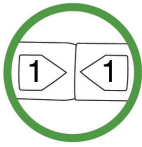
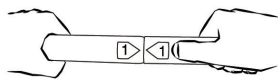
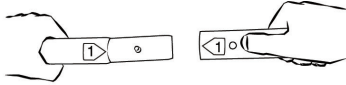

1. Snap and connect frame tubes with corner tubes by matching labels at the end of each tube.
Connect the bottom tubes with the frame assembly by using screws from both sides.

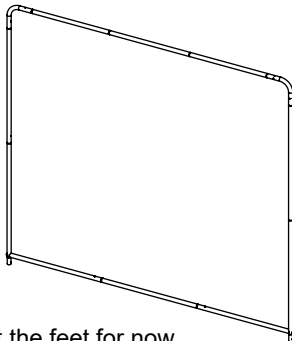

NOTE: Do not connect the feet for now.

3. Zip the fabric along the tubes on the opening at bottom.
Stretch out the fabric if any wrinkle shows. Assemble the feet at bottom on both ends.

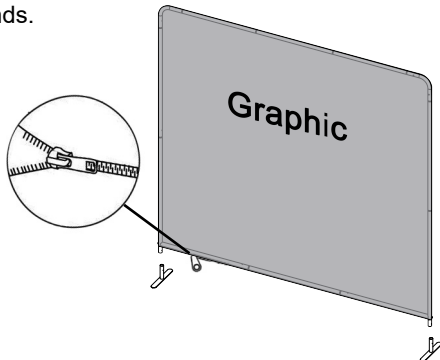

2. Carefully lay the assembled frame on a clean surface.
Slide the printed fabric to cover the frame from the top like a pillow case.

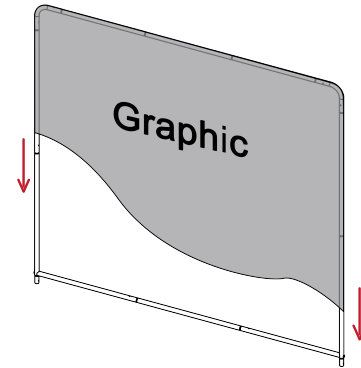

4. The assembly is finished.

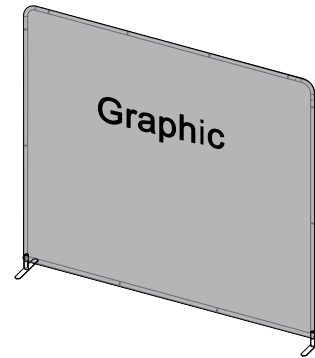

Scan QR code to visit the product page:

