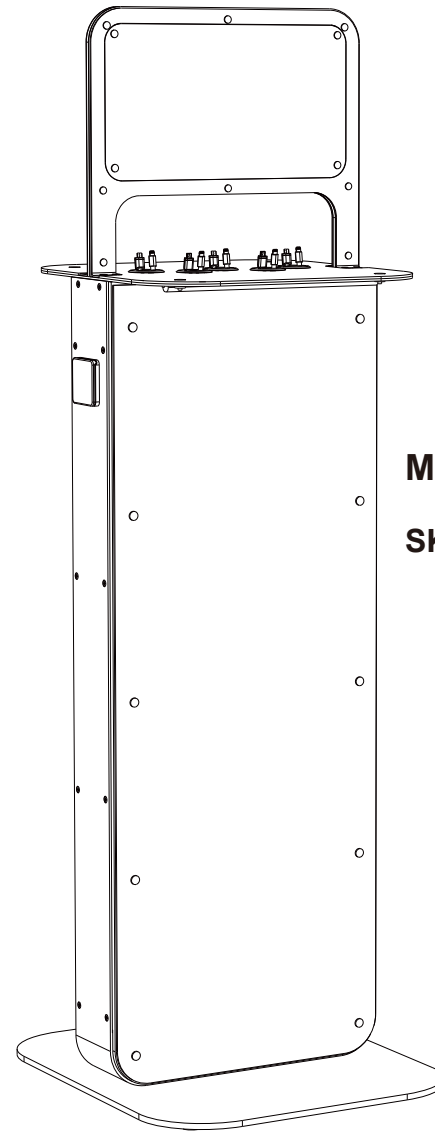

**ATTENTION!**

Please read the user manual completely and carefully. It is part of the product and includes important information for proper installation and use. Keep this guide in a safe place for reference and provide to any additional users or new owners of the product.

If you have any questions regarding our products, please visit us at www.displays2go.com or contact our customer service at 1-844-221-3388.

**Mighty Floor Charging Kiosk****SKU: CHRFLMIGCP**

Scan QR code to visit
the product page:



Contents

A . Description and Function:	1
B . Intended Use:	2
C . Safety Instructions:	2
D . Package Contents:	2
E . Installation:	3
F . Replacing Charging Cables:	5
G . Care, Maintenance, Storage and Transport:	6
H . Specifications:	6
I . Troubleshooting:	6

A . Description and Function:

The Mighty Charging Kiosk charges 10 devices simultaneously. It also provides 2 universal type power outlets for charging any laptop computers and other devices.

G . Care, Maintenance, Storage and Transport:



WARNING!

Please follow these instructions to avoid risk of electric shock and/or short circuit.

- The product is self-service, i.e. users do not require assistance to recharge their device.
- Always disconnect the power cord from the main power outlet first.
- Do not clean the product until the unit is powered off and unplugged from the main power outlet. Once unplugged, clean using a dry or slightly damp cloth. Avoid using cleaning products and do not allow liquid to enter the device.
- Do not install in a location where a person could potentially trip on the power cord or Charging Station.
- During care, maintenance, storage and/or transport, avoid places that are wet, humid or have a high temperature.
- Carefully read and abide by the Safety Instructions for care, maintenance, storage and transport.
- We recommend using the original packaging for transportation to protect the product from dust and humidity.

H . Specifications:

SKU	CHRFLMIGCP
Input	100-240V/50-60 Hz 10A
Output	DC: 10x 5V/2.1 A
	AC: 2x 100-240V/3A

I . Troubleshooting:

The device does not charge	<ul style="list-style-type: none">- Ensure the power outlet is turned on and working.- Ensure the thick black power cord is plugged into the AC adapter properly.- Ensure the thin black power cord is plugged into the underside of the charging station properly.- Unscrew the cover and ensure the cable is plugged into the USB outlet properly.- Replace the charging cable in the same USB port with a new one and test if it can charge properly.
The charging port is damaged	Try multiple cables in the charging port to ensure that it is damaged. If it is still not working, please contact us.
Other problems	Contact us.

F. Replacing Charging Cables:

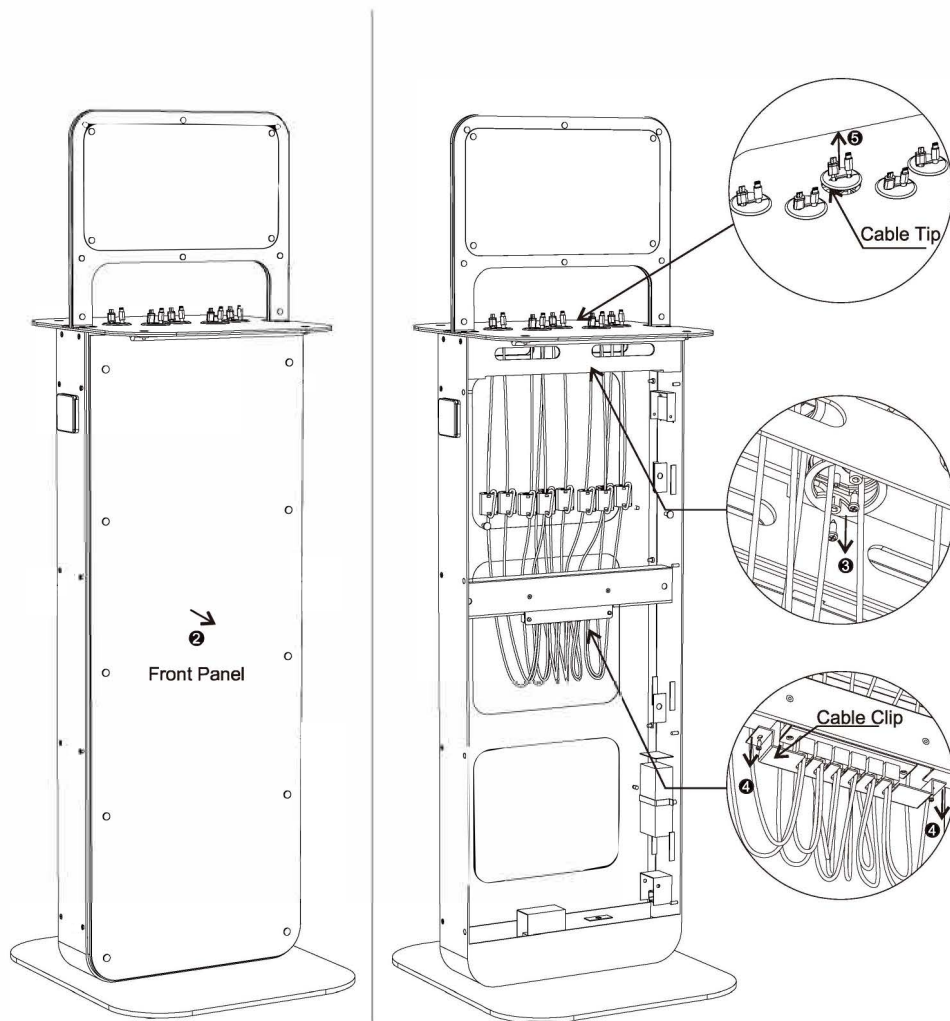

❶ Remove 10x screws from the Front Panel.

❷ Take off the Front Panel.

❸ Identify the cable to be replaced and remove the respective screws.

❹ Remove the 2x screws and take off the Cable Clip.

❺ Take off the Cable Tip and replace cable.

❻ Replace all parts and screws.

B. Intended Use:



This charging station is for indoor use only in a dry area. Do not position in any location near water. Positioning this product outdoor, or in a location near water may cause damage or injury to persons or property. Please ensure you carefully read and abide by the 'Safety Instructions'.

C. Safety Instructions:



WARNING!

We recommend a skilled electrician is used to assemble and disassemble the housing of the product to avoid risk of electric shock or electrical damage to the product.

- This product is not a toy and should not be used by children at any time. It contains small parts which can be swallowed and cause serious injury.
- Ensure the charging station is assembled and installed in a way that prevents a person tripping over the power cable or the unit falling from its location.
- Please ensure the packing materials are disposed of completely to prevent injury to children
- Do not install in an area with high temperature, high humidity or areas where the charging station may come into contact with water.
- Do not install near air conditioners, or in areas with excessive dust, smoke or vibration.
- The charging station should be installed on a horizontal, flat surface to ensure it does not fall.
- Do not modify or alter the product in any way.
- Do not use the product, or any parts, if they are damaged.
- All cables and adaptors should be connected and disconnected slowly and carefully.
- Ensure suitable packaging for transport of the product based on its 'Specifications'.

D. Package Contents:

- 1 pc Power Cord
- 1 pc Mighty Floor Charging
- 1 pc Kiosk Manual
- 1 pc Drill Template
- 1 set Expansion bolts

E . Installation:

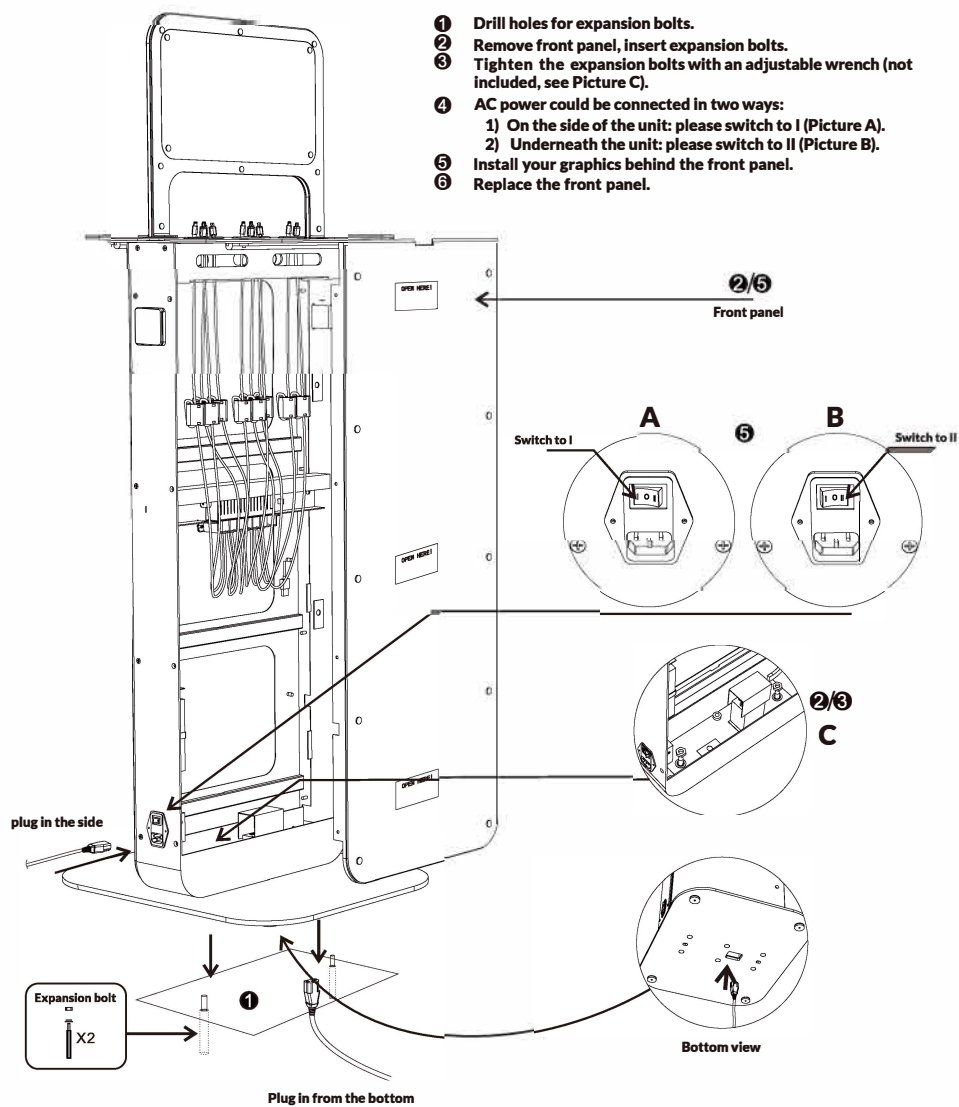

Installing Graphics:

1. Remove 10x screws from the front panel.
2. Take the front panel off.
3. Remove protective film attached to the front panel.
4. Place graphic behind the front panel.
5. Replace 10x screws to re-attach the front panel.
6. Repeat steps 1-5 for the back panel.



7. To replace the header graphics, use the same method as in above steps.