



YOUR **MESSAGE** IS OUR **MISSION**



SKU: STPRZWHLCP

CUSTOM PRINTED FLOOR STANDING PRIZE WHEEL

Assembly Instructions

PARTS LIST

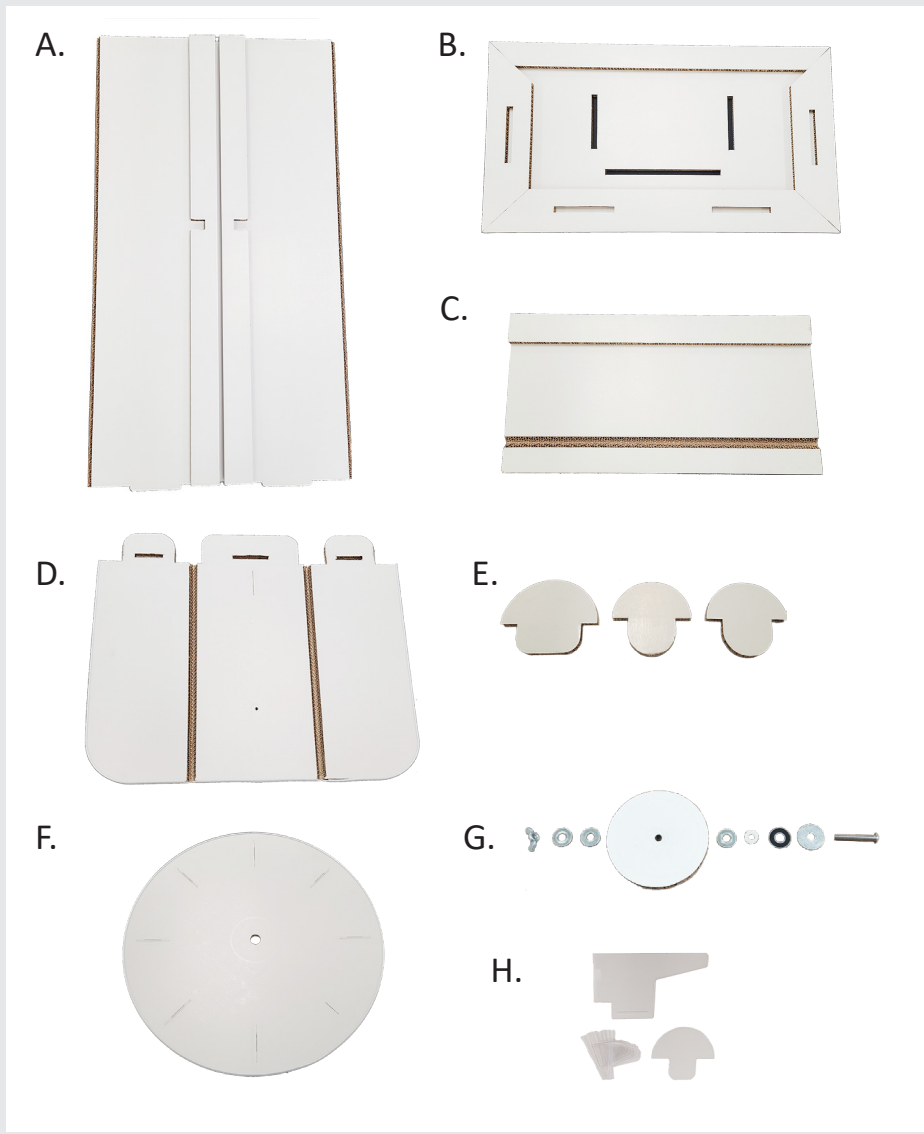

Part	Quantity
A. Base	1
B. Countertop	1
C. Shelf	1
D. Prize Wheel Stand	1
E. Tabs.....	3
F. Prize Wheel.....	1
G. Hardware Kit.....	1
H. 8 Pegs and Pointer Set	1

Remove all parts from the package and check to make sure all parts are present.

If you have any questions regarding our products, please visit us at www.postupstand.com or contact our customer service at 1-800-935-3534.

1. Expand the Base (A) and fold both sides backwards, with the tabs at top.

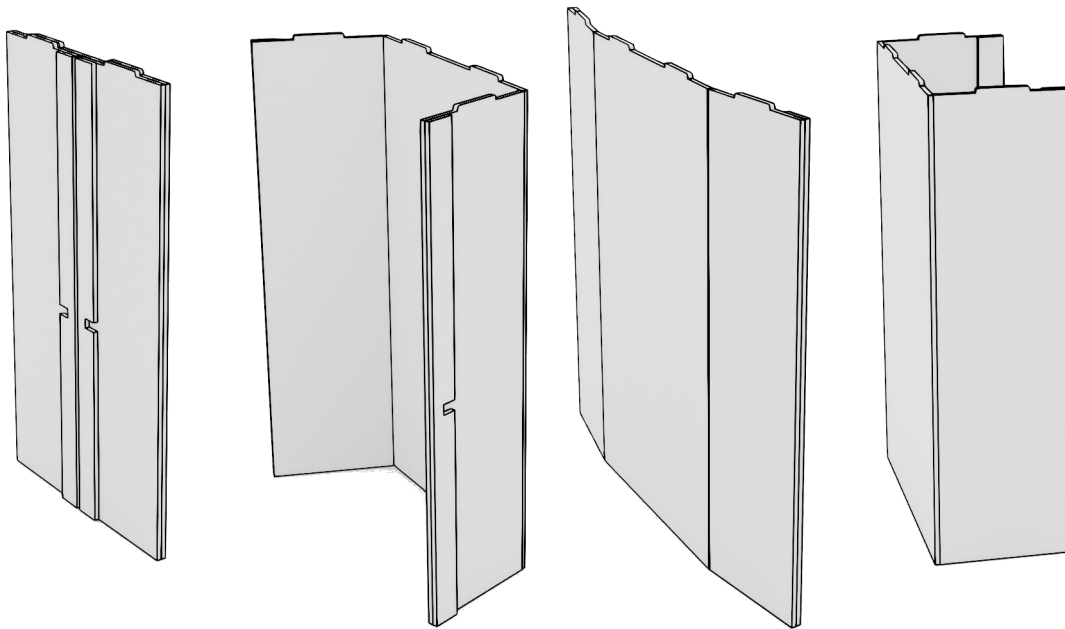

2. Fold the flap down along the cut on the Shelf (C). Place the shelf at the cutouts inside the base, and the front will rest onto the support.

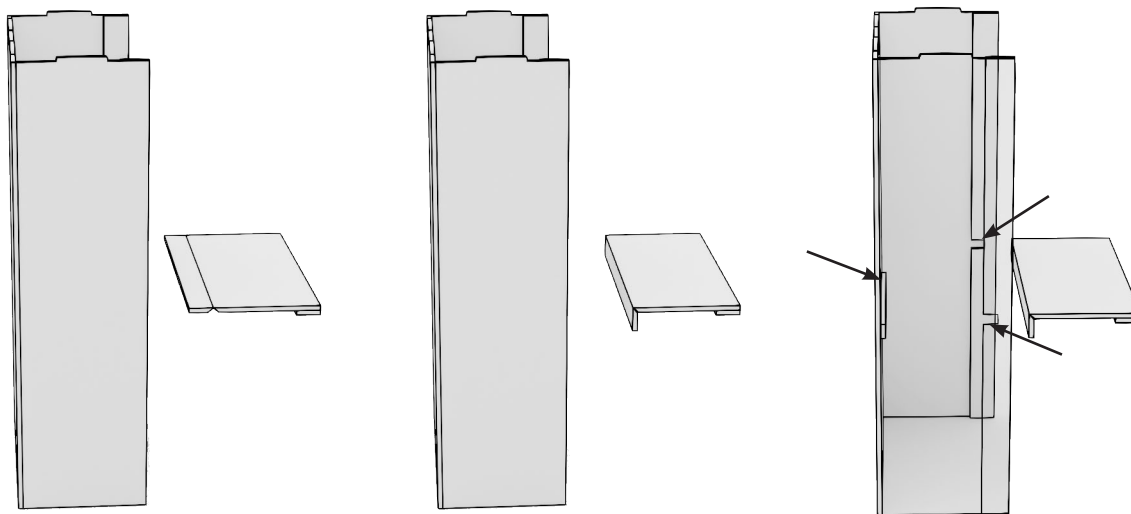

3. Place the Countertop (B) onto the base and insert tabs into the cutouts at bottom of the countertop.

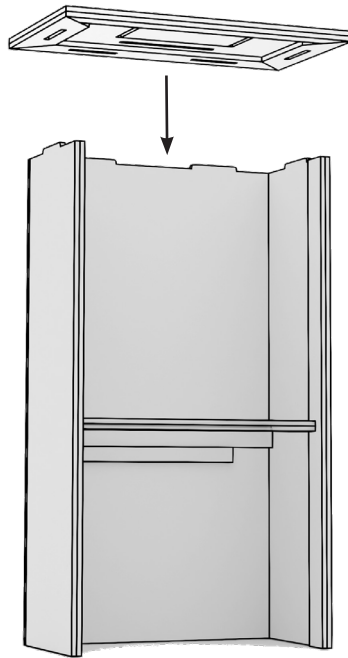

4. Fold the Prize Wheel Stand (D) and fully insert tabs into the cutouts on top of the countertop. Insert the 3 Tabs (E) from the bottom to secure the Stand in place.

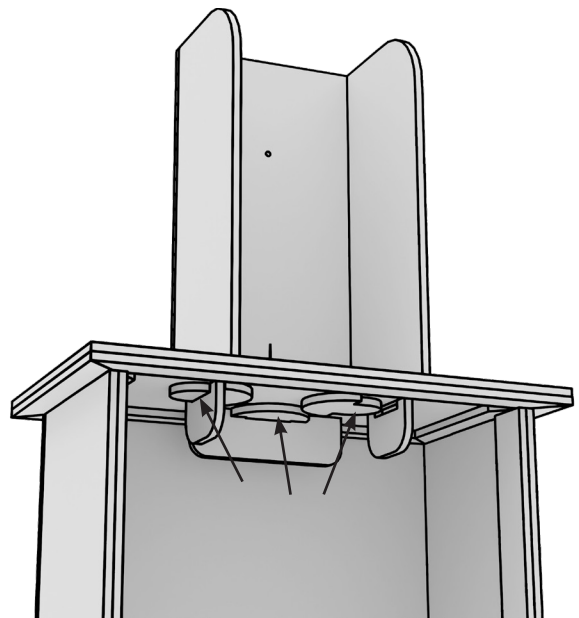
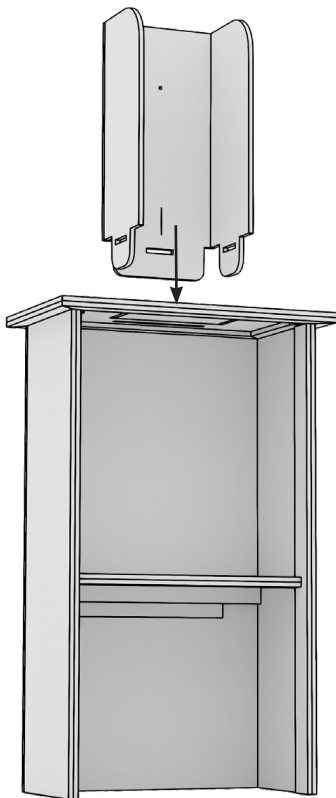

5. Connect the Prize Wheel (F) and the Stand with the Hardware Kit (G) supplied.

The Screw should connect with other parts in sequence as below.

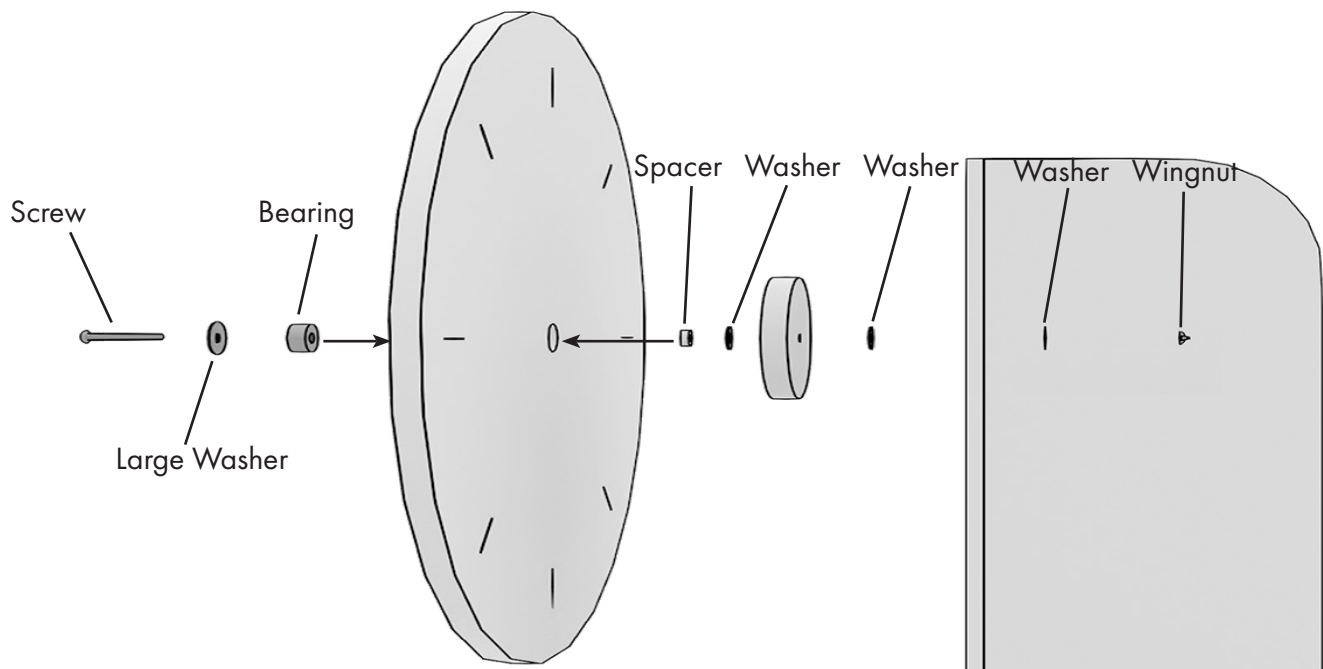

6. Insert 8 clear Tabs (H) from the back of the Prize Wheel into the cutouts as shown.

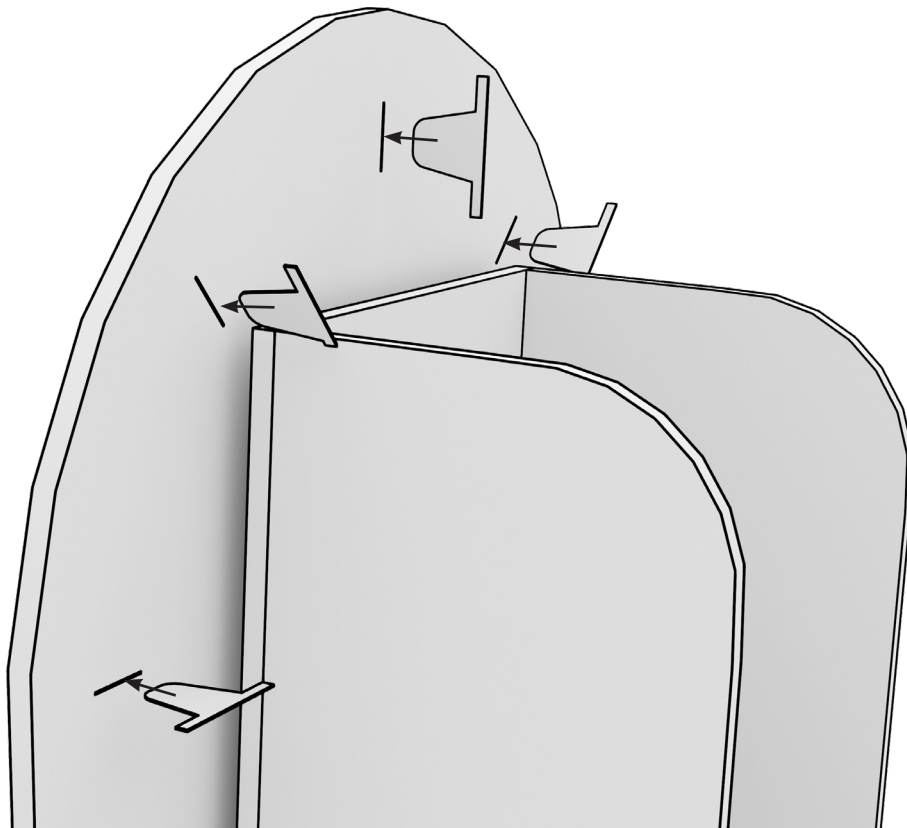

7. Insert the Pointer (H) into the cutout at the bottom of the Prize Wheel Stand.

Insert the clear Tab (H) into the Pointer at the back to stabilize it.

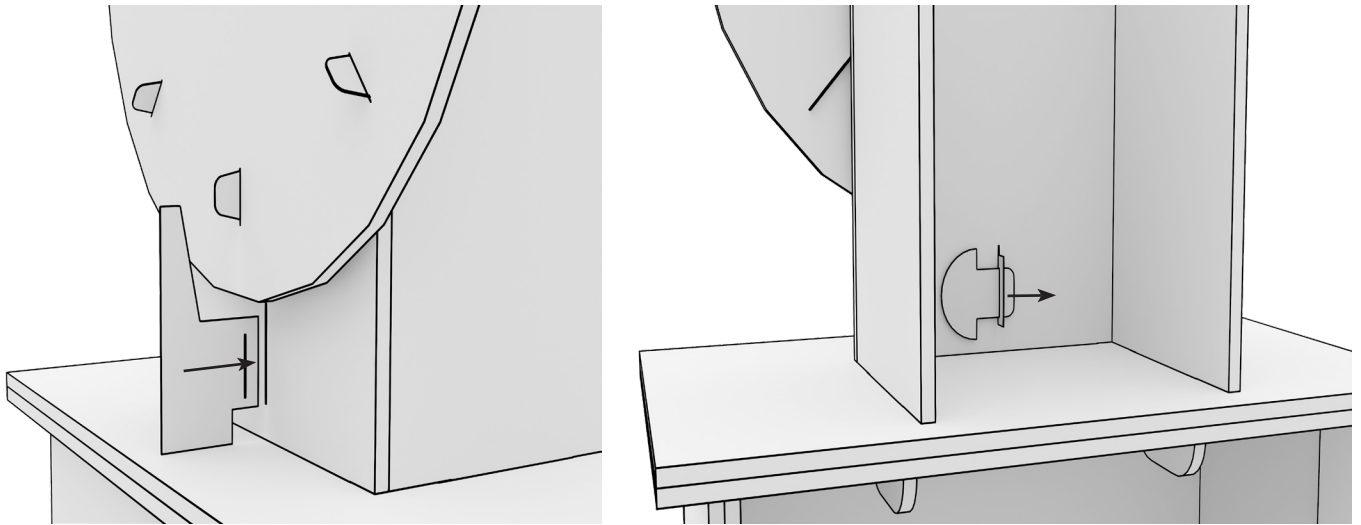

8. Your floor-standing prize wheel is fully assembly.

