

IPRO-SERIES

TABLET ARM USER'S MANUAL

1 Base Mount Installation

A 2 in 1

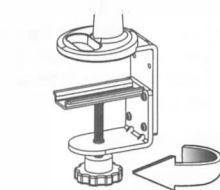

1 Loosen hand screw clockwise

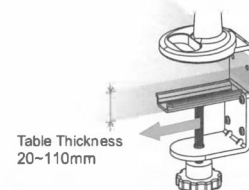

2 Clamp base mount to the table

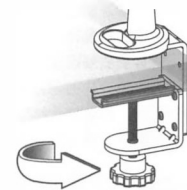

3 Tighten hand screw counter-clockwise

B C-Clamp

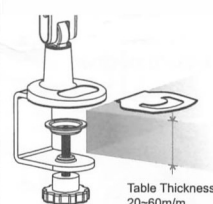
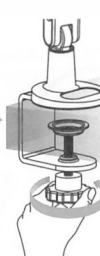
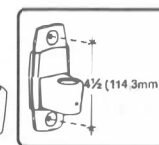
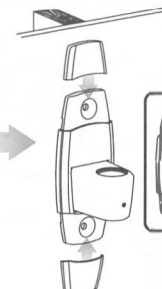
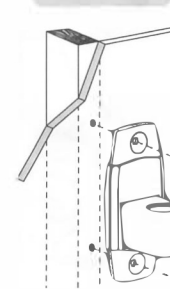

Table Thickness
20~60mm



D Wall-Mount

Wood (木質牆)



C Grommet



Table Thickness
20-60mm



Concrete(水泥壁)

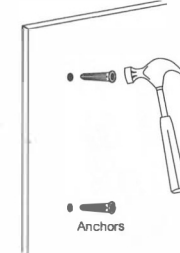
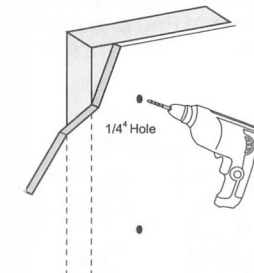

Anchors

Warranty effective since Year Month Day

Seal by Distributor

※

Please read carefully warranty details stated in the instruction manual.

71H016833-014

Arms Installation

ormal Type

Security Type

Installation

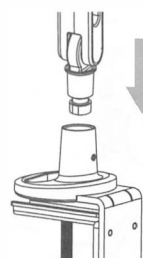

- A** Place mount set into the base mount.

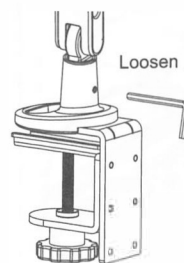

Loosen



Tighten

- B** Turn clockwise until fully tighten.

工具 Tool 2

工具 Tool 4 Security Type

ase Mount Security

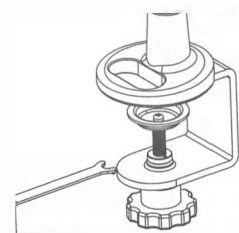

Clamping base set on the table before securing the base mount

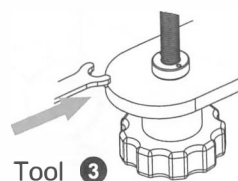

Tool 3

- A** Place the security key into the base mount with the key teeth facing down.

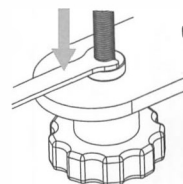

B

- Place the security key's teeth into the corresponding hole on security ring.

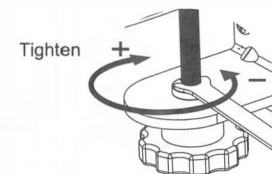

Tighten



Loosen

- C** Turn clockwise until fully tighten to complete the security.

hanging 2 in 1 C-Clamp to Grommet

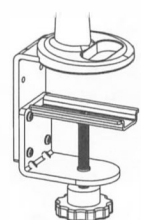

A

- Turn the product up side down then counter-clockwise the screws with allen key to dis- assembly the 2 in 1 base

M5 x14mm

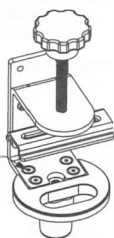

C

- Counter-clockwise the hand screw until it disassemble with the metal set

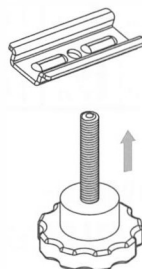

D

- Put hand screw through the horizontal metal plate

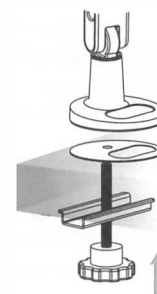
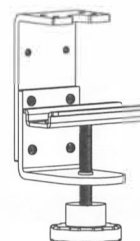

E

- Assembled the grommet set between both side of the table hole

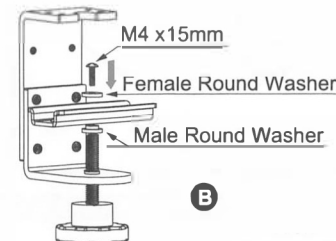

B

- Use cross head screw driver to disassemble the m4 screw on the 2 in 1 set

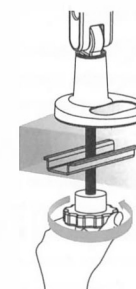

F

- Accomplished

3 Pad Installation

Normal Type Installation

Caution: Claws can only be adjust in "unlock" situation do not try to adjust the claws in "lock" situation.

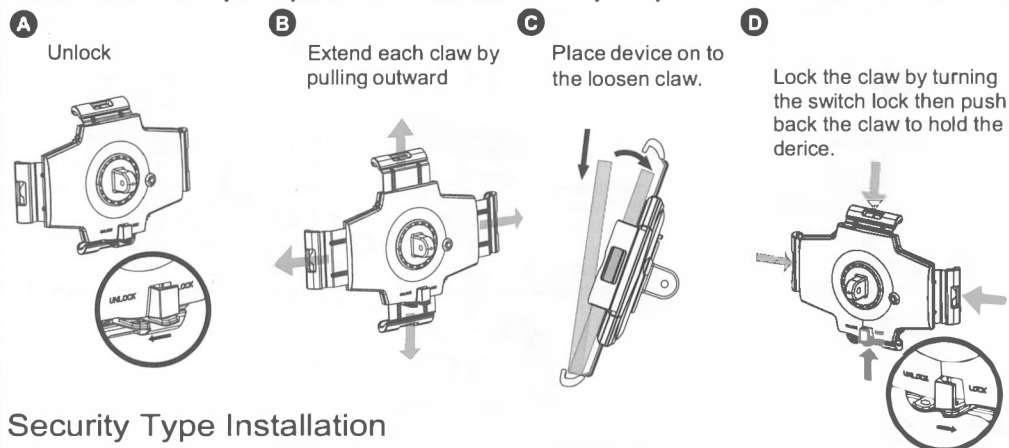

Security Type Installation

Caution: Claws can only be adjust in "unlock" situation do not try to adjust the claws in "lock" situation.

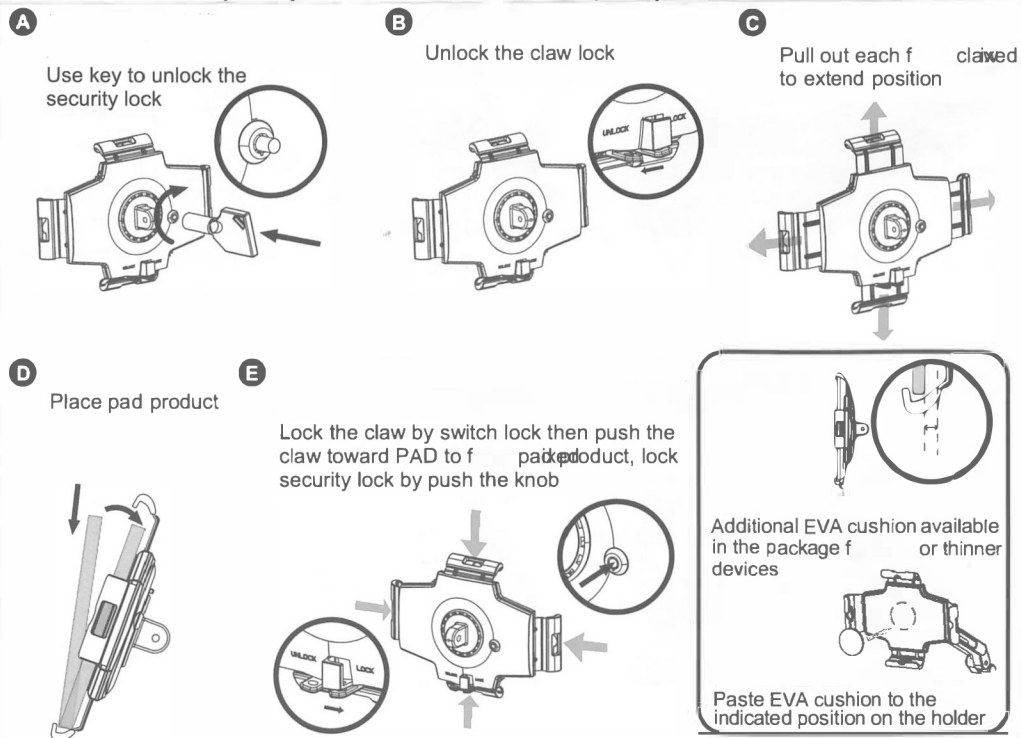

4 Features

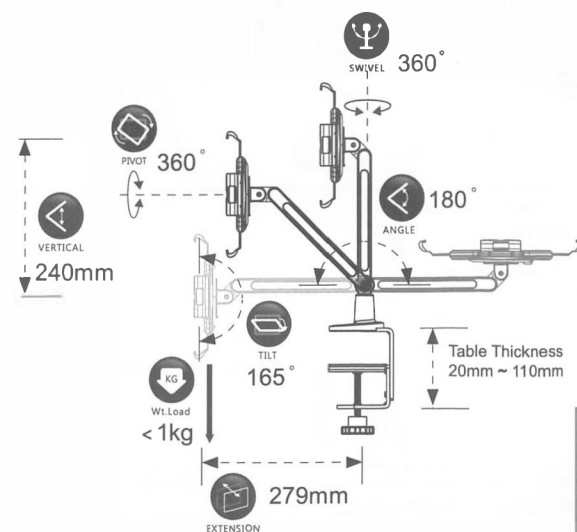
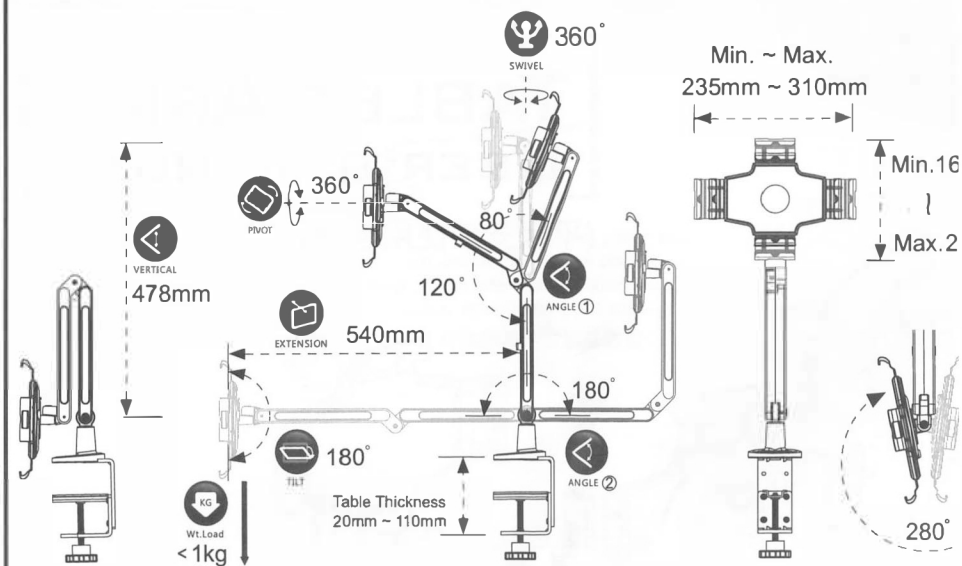

Charging

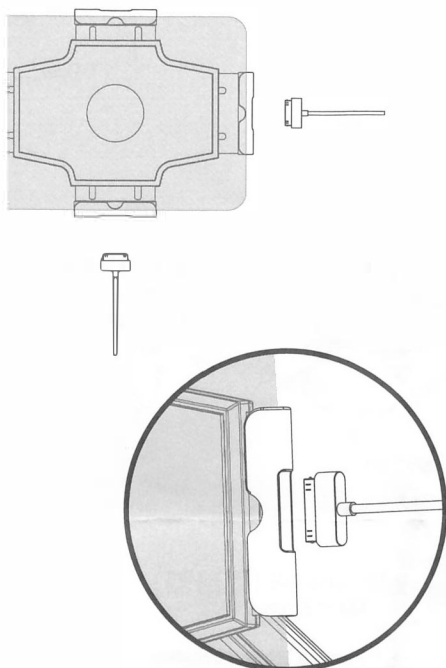

7 Cable Route

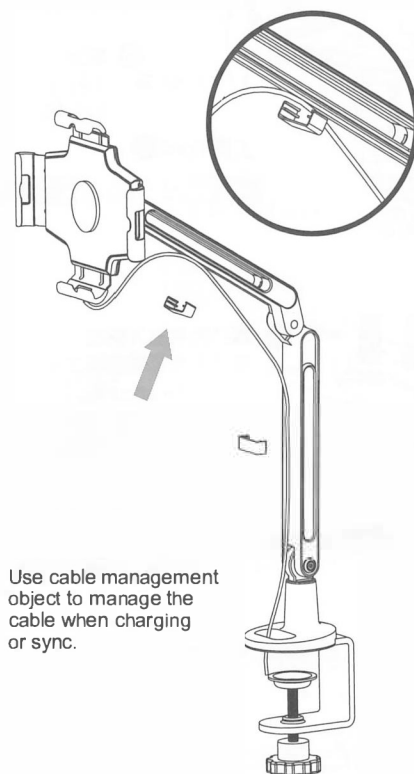

Use cable management object to manage the cable when charging or sync.

5 Tension Adjustment

Caution



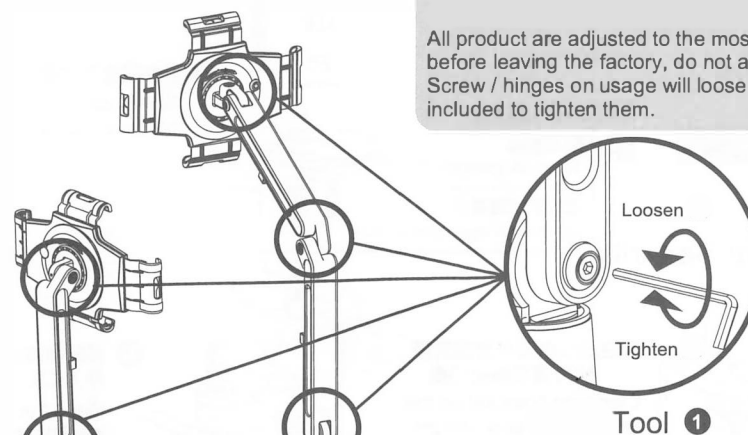

























All product are adjusted to the most suitable tension before leaving the factory, do not alter unless necessary. Screw / hinges on usage will loose, use the toolkit included to tighten them.

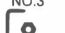

Tool ①

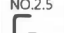
Each hinge of the product can be adjusted easily with the tool kit included in the package

Features and Specification

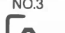
Type	Part		Accessories						Security Accessories		Remark
	Body	Base	Tool ①	Tool ②	Cable Management	Key	Anchor+Screw	EVA	Tool ③	Tool ④	
EPL3316	 x1	 x1	NO.2.5  x1		 x2	 x2		 x1	 x1	NO.3  x1	C-Clamp Security Type
EPL3364	 x1	 x1	NO.2.5  x1		 x2	 x2	 x2	 x1		NO.3  x1	Wall Mount Security Type
EPL2316	 x1	 x1	NO.2.5  x1		 x1	 x2		 x1	 x1	NO.3  x1	C-Clamp Security Type
EPL2364	 x1	 x1	NO.2.5  x1		 x1	 x2	 x2	 x1		NO.3  x1	Wall Mount Security Type

(Scope of Guarantee)

er's satisfaction with our products is the goal that we have been heading for. To assure the best after-sale service to
ers and ensure consumer's rights, please read carefully the information stated in the instruction manual.
nce our service efficiency, please provide purchase invoice or warranty card if request for product maintenance or
idise exchange.
ial date of purchase and affixed seal by distributor on warranty card is required. Free after-sale service will not be
ed even under warranty period should any incomplete purchase information.
is of components and maintenance will be at consumer's expense should the product is invalid for warranty period.
refer to specification limitation specified in the instruction manual for correct usage. Even under the warranty period, this
' does not cover the problems or damage resulting from the loading weight that exceeds the specification specified in the
on manual; and the costs of components and maintenance will be at consumer's expense.