

在您开始安装和组装本产品之前，请先阅读该说明书。
如果您对说明书和警告语有任何疑问或不明之处,请联系当地供货商寻求帮助。
Read the entire instruction manual before you start installation and assembly.
If you have any questions regarding any of the instructions or warnings,
Please contact your local distributor for assistance.

Wall-Mounted Monitor Arm

Assembly Instructions

SKU: WMONMTWH

- 注意:
- 不要超过所标的额载重量,否则会造成严重的伤害或财产损失!
- 1.支架一定要按照组装说明书上的要求来安装,不正确的安装可能会导致产品损坏或严重的人身伤害。

2.使用安全装置和合适的工具,由专业人员来安装。

3.确保支撑面能够安全支撑设备和所有配件的重量。

4.使用提供的附件包安装螺丝,注意不要过度拧紧安装螺丝。

5.本产品包含小的部件,如果被吞咽会造成窒息的危险,请放置在儿童接触不到的地方。

6.本产品仅适用于室内使用。在户外使用可能会导致产品损坏和引起人身伤害的风险。
- 重要:

在安装之前,根据提供的清单来确保您已经收到所有的部件。如果有任何部件缺失或损坏,请联系您的供货商。
- 维护:

每隔一段时间检查支架是否稳固和安全使用(至少每三个月)。

- CAUTION:
- Use with products heavier than the rated weights indicated may result in instability causing possible injury.
1. Mounts must be attached as specified in assembly instructions. Improper installation may result in damage or serious personal injury.

2. Safety gear and proper tools must be used. This product should only be installed by professionals.

3. Make sure that the supporting surface will safely support the combined weight of the equipment and all attached hardware and components.

4. Use the mounting screws provided and DO NOT OVER TIGHTEN mounting screws.

5. This product contains small items that could be a choking hazard if swallowed. Keep these items away from children.

6. This product is intended for indoor use only.Using this product outdoors could lead to product failure and personal injury.
- IMPORTANT:

Ensure that you have received all parts according to the component checklist prior to installation. If any parts are missing or faulty, telephone your local distributor for a replacement.

MAINTENANCE:

Check that the bracket is secure and safe to use at regular intervals (at least every three months)

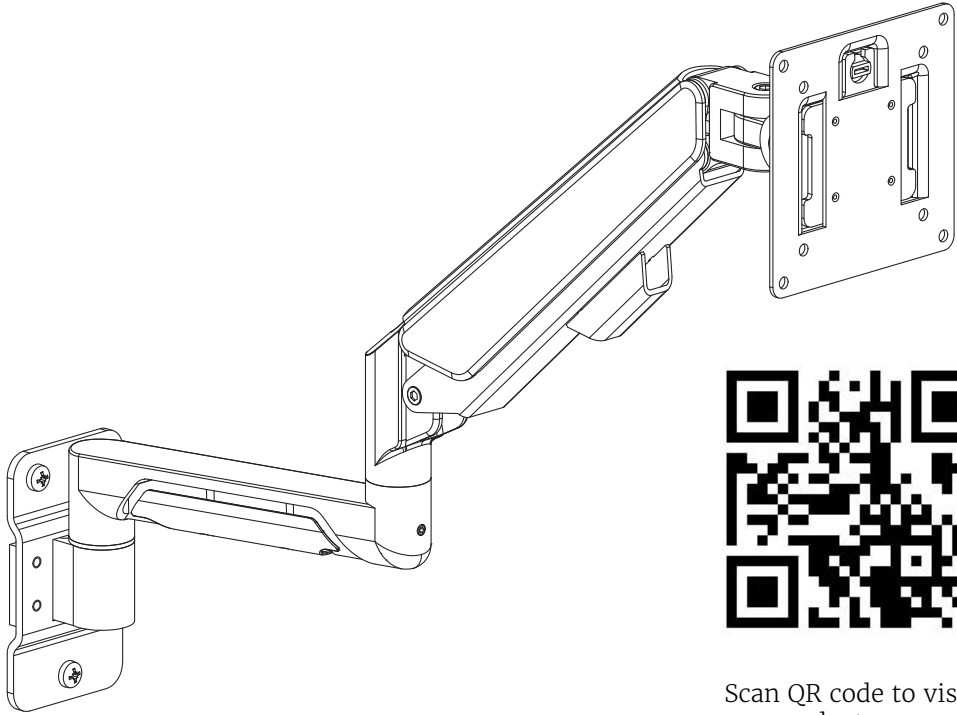

Scan QR code to visit
product page

If you have any questions regarding our products, please visit us
as displays2go.com or contact D2G Customer Service at
844-221-3388.

VESA
75X75
100X100

10° ~32°

max

2~9kg

85-579
MM



-90° +90°

STEP 4

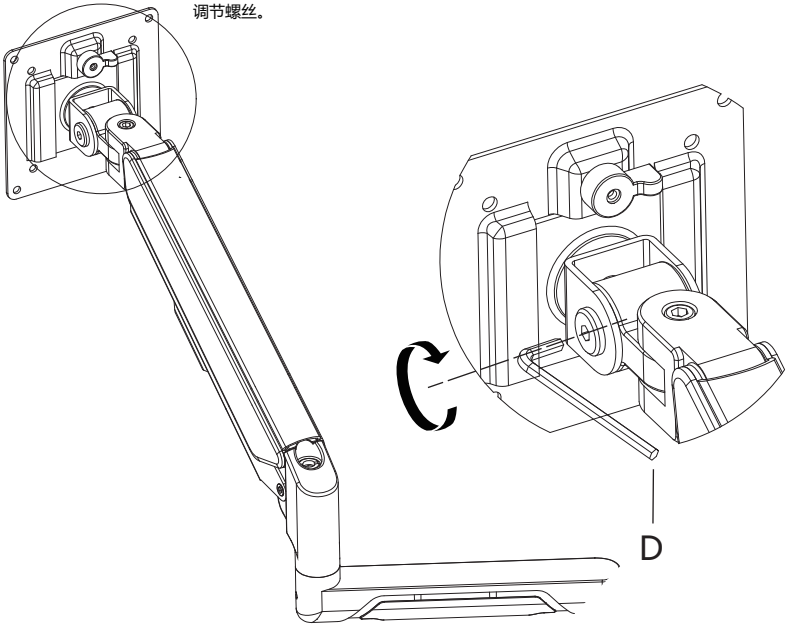
If you feel the pitching angle too tight or too loose
when adjusting the mount, please adjust the Screw
如果在调节显示器俯仰角时感觉过紧或过松,请使用扳手
调节螺丝。

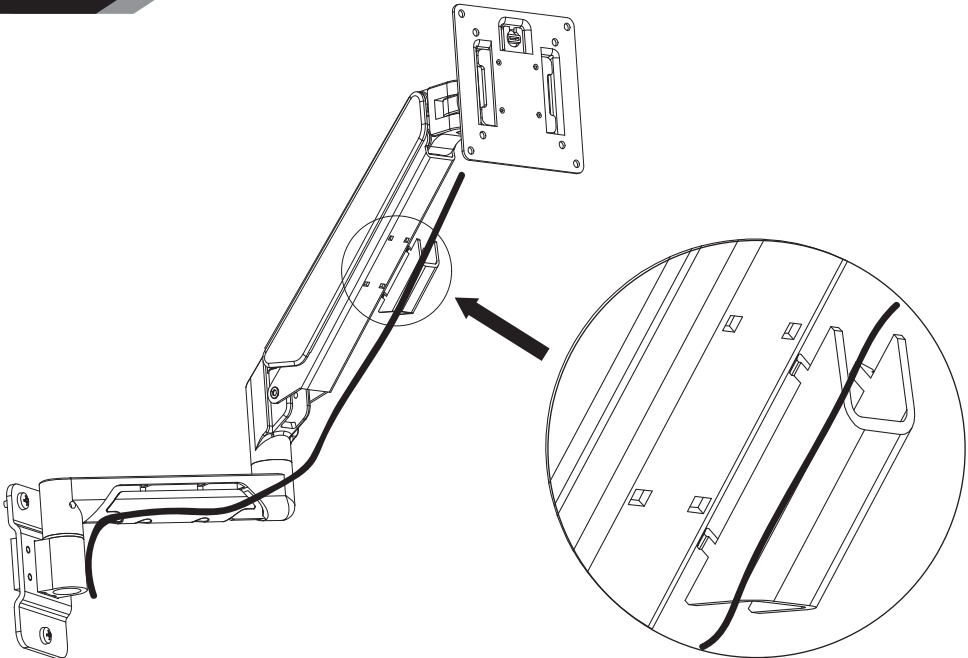

STEP 5



STEP 6

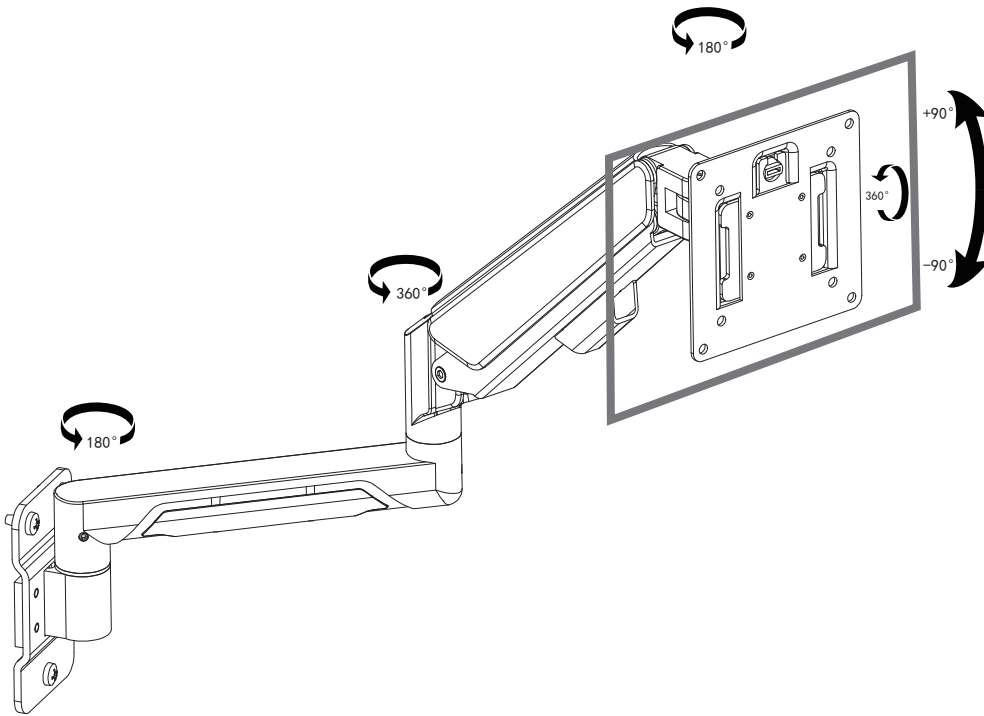

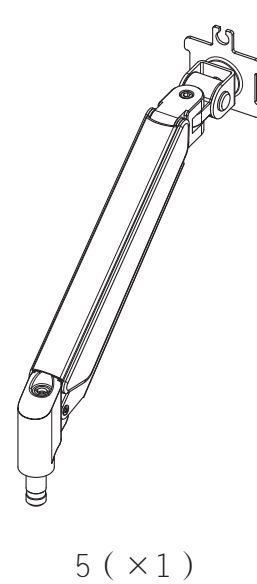
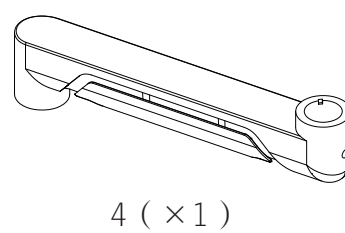
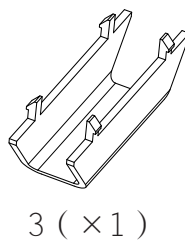
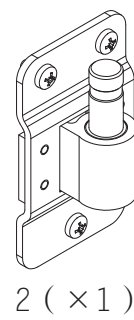
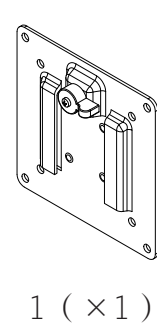
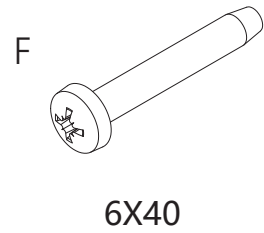
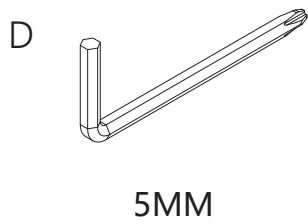
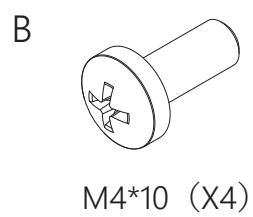
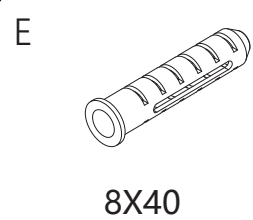
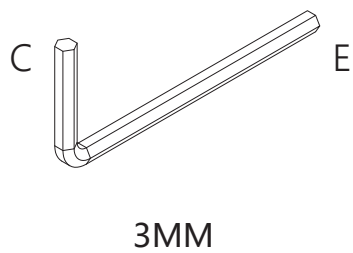
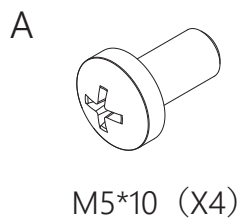

STEP 1

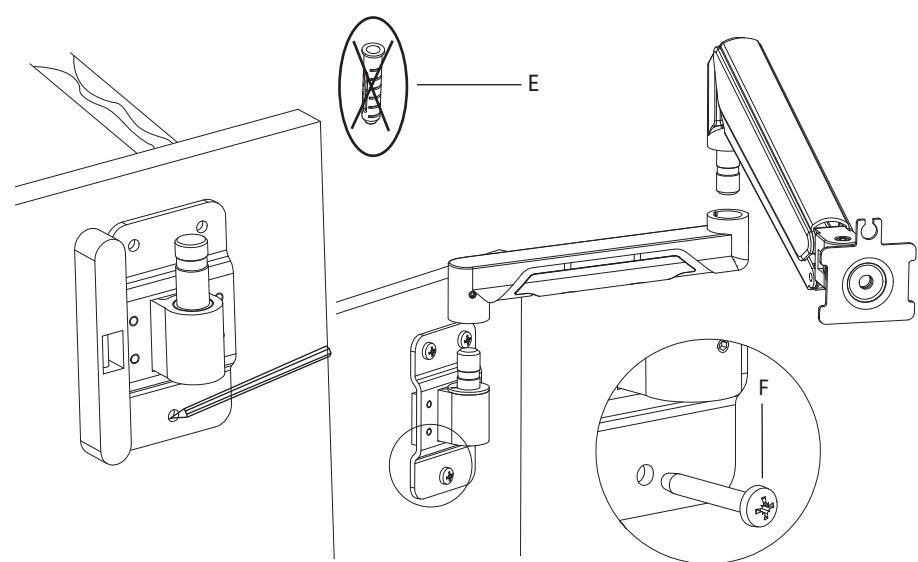
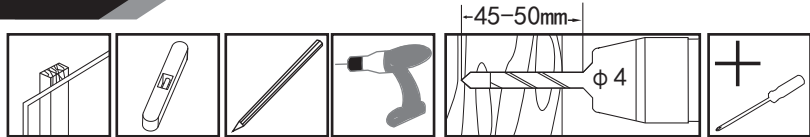

STEP 2

Use a wrench (H) to screw the screws (C/D) into the four holes at the back of the monitor to avoid damaging the monitor by over tightening the screws.
用扳手(H)将螺丝(C/D)拧入显示器后面的四个孔, 避免过度拧紧螺丝损坏监视器。

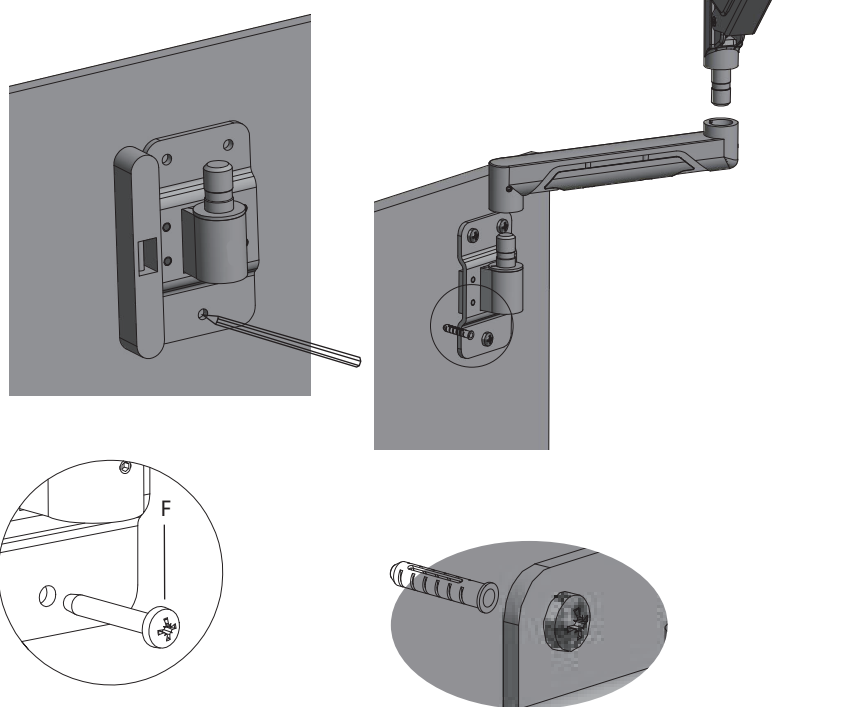
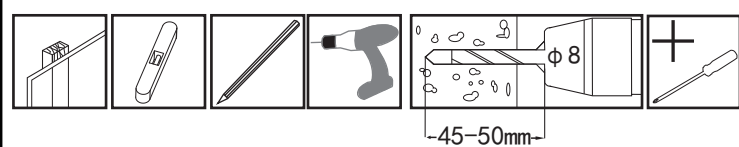
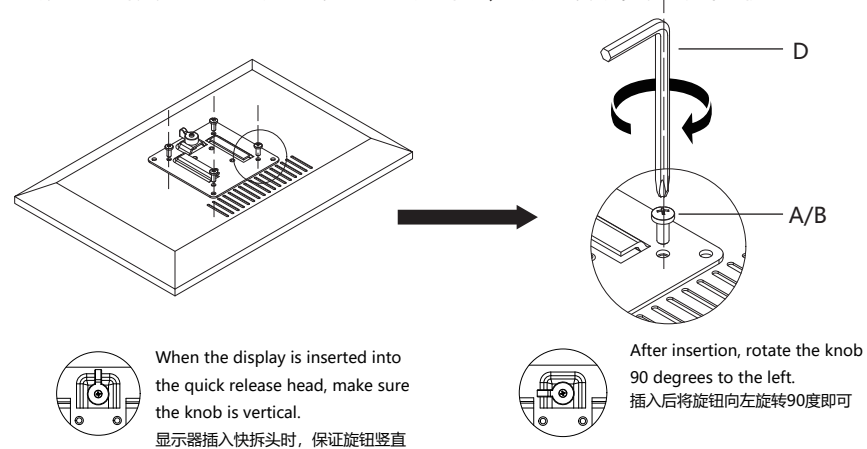

STEP 3

If you feel the pitching angle too tight or too loose when adjusting the mount, please adjust the Screw
如果在调节显示器俯仰角时感觉过紧或过松, 请使用扳手调节螺丝。

