

ASSEMBLY INSTRUCTIONS

ARTSNFF6 - Wooden Easel with Shelf



IMPORTANT SAFETY INFORMATION:

Read all instructions before start installing the unit. Displays2go is not responsible for any damage or injury caused by incorrect assembly or use.

PARTS LIST

A. Front Leg - Right	X1
B. Front Leg - Left	X1
C. Rear Leg	X1
D. Top Rail	X1
E. Block	X1
F. Pin	X1
G. Bottom Rail	X1
H. Canvas Shelf	X1
I. Secure Bar - Shelf	X1
J. Wood Screw	X3
K. Screw with Wing Nut	X2
L. Hex Screw with Lock Nut	X4
M. Hex key	X1

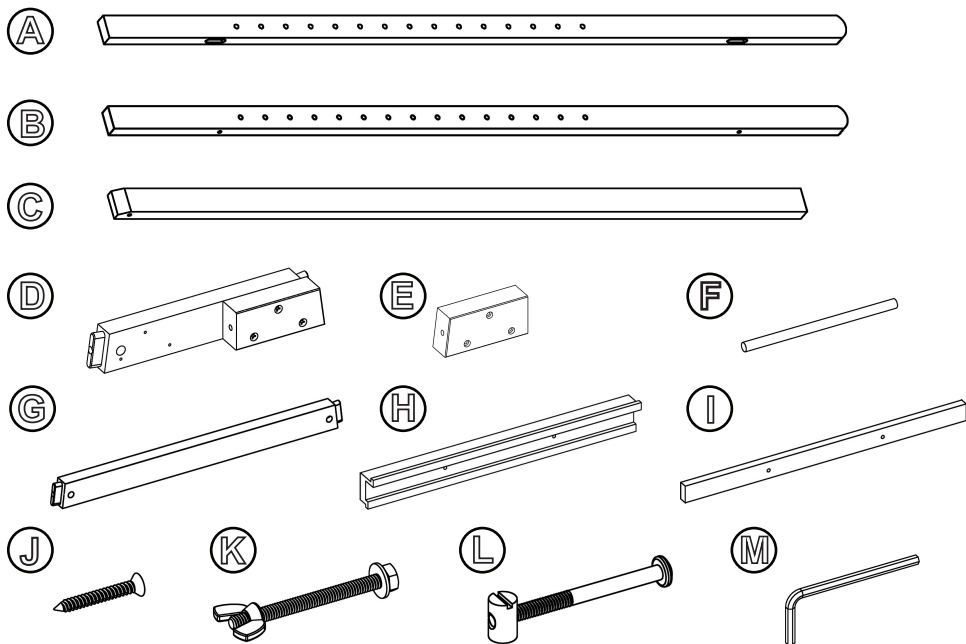

TOOLS NEEDED

- Flat-head Screwdriver
- Phillips Screwdriver



1. Connect rear leg (C), wood block (E) and top rail (D) with metal pin (F), see the image below. Secure the wood block by using wood screws (J) with a Phillips screwdriver.

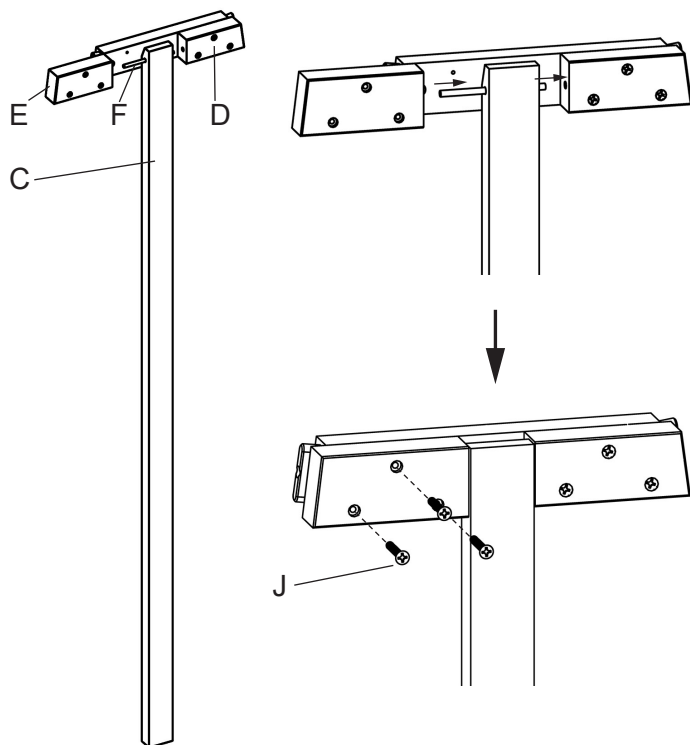

2. Connect 1 front leg (A) with the assembled rear leg. Unscrew and insert the lock nut (L) into the pre-drilled hole on the top rail, tighten the screw (L) from the side with provided hex key (M).

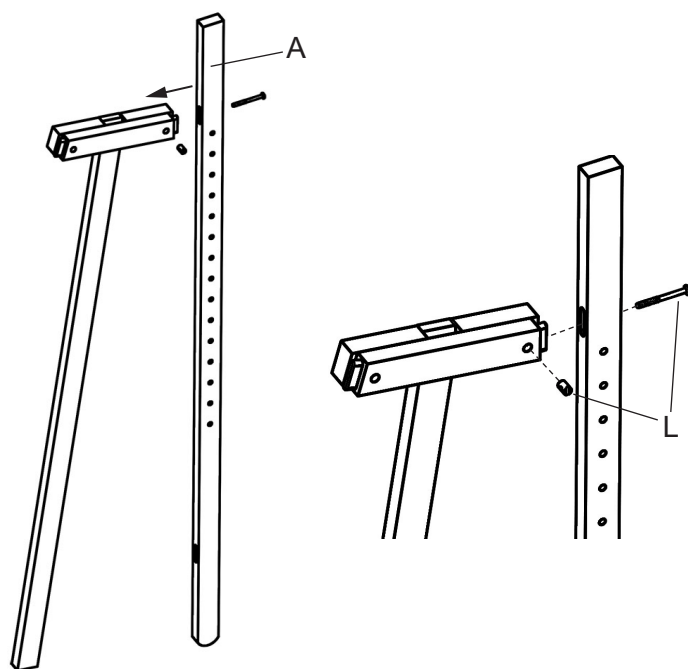

Tips: Adjust the lock nut with a flat head screw driver to help threading in the hex screw.

ASSEMBLY INSTRUCTIONS

ARTSNFF6 - Wooden Easel with Shelf

3. Attach the bottom rail (G) to the front leg at the bottom notch. Then secure the rail with the leg by using screw and lock nut (L) similar to Step 2.

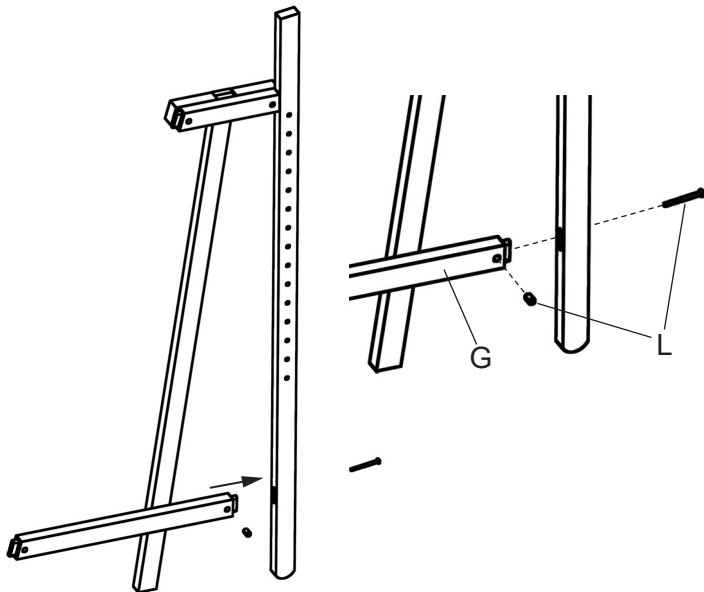

4. Assemble the other front leg (B) the same way.

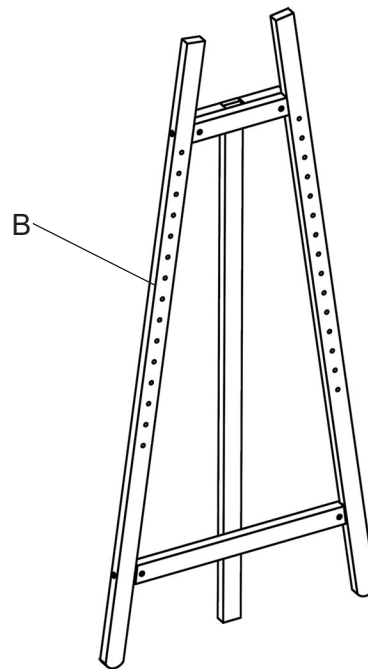

5. Install the canvas shelf (H) and secure bar (I) to the front and back of the front legs, respectively. Secure them by tightening the screws and wing nuts (K) as shown below.

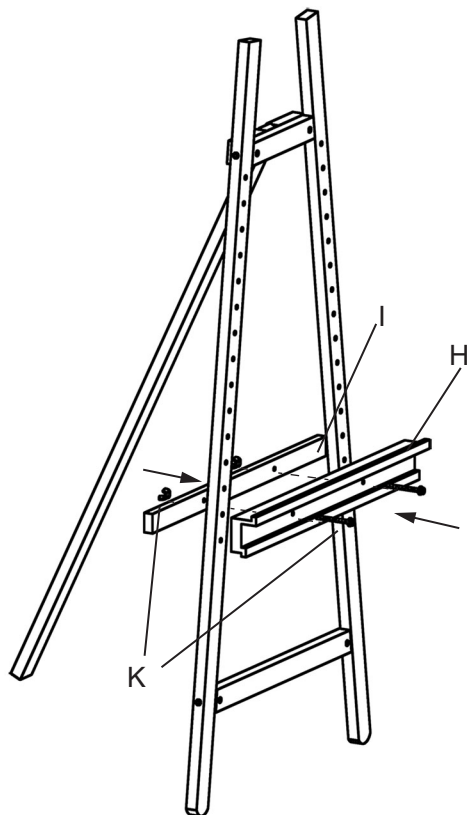

6. The assembly is finished. Adjust the height of the shelf as needed, and be sure it is level.

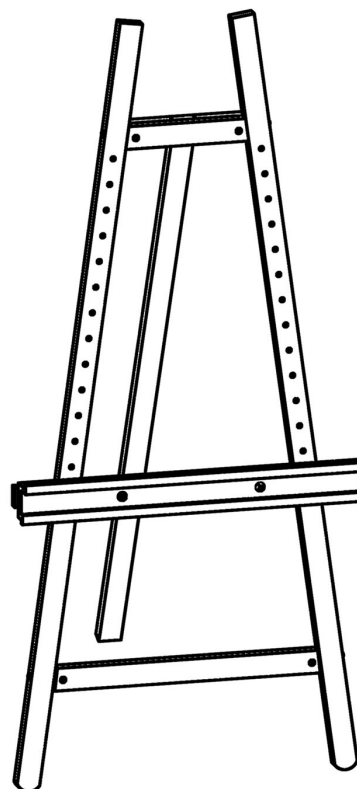

Scan QR code to visit the product page:



If you have any questions regarding our products, please visit us at www.displays2go.com or contact D2G customer service at 844-221-3388.