

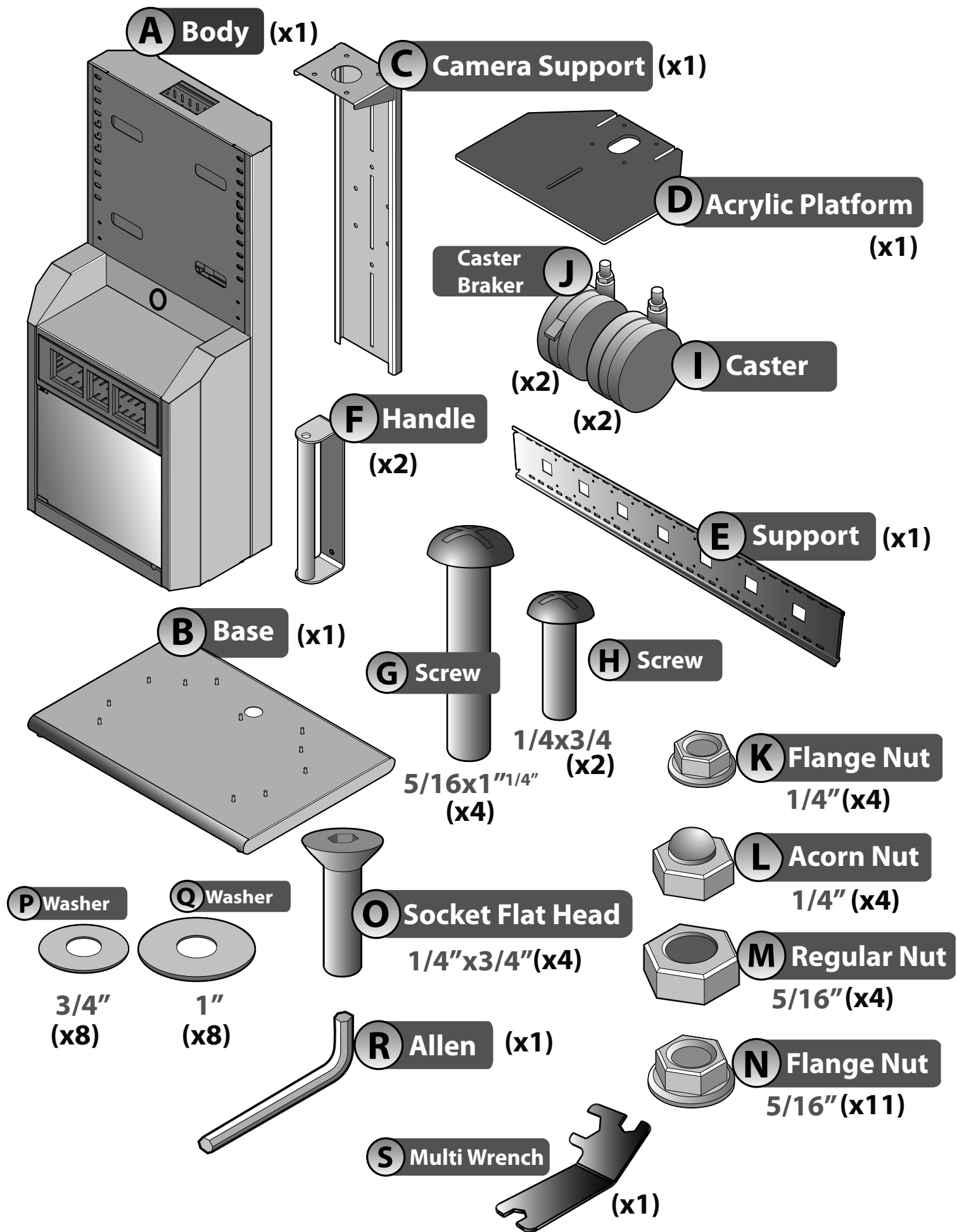

RPS800

Items Included

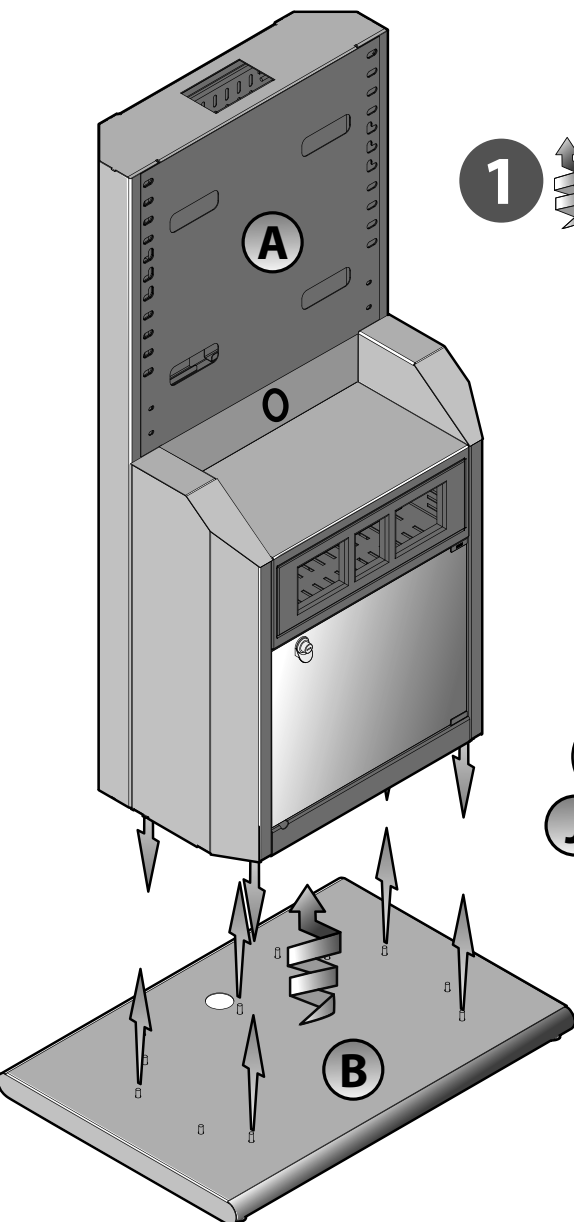



1

Place body(A) on base lining up bolts on base with holes on body(A), then secure the joint using flange nuts.

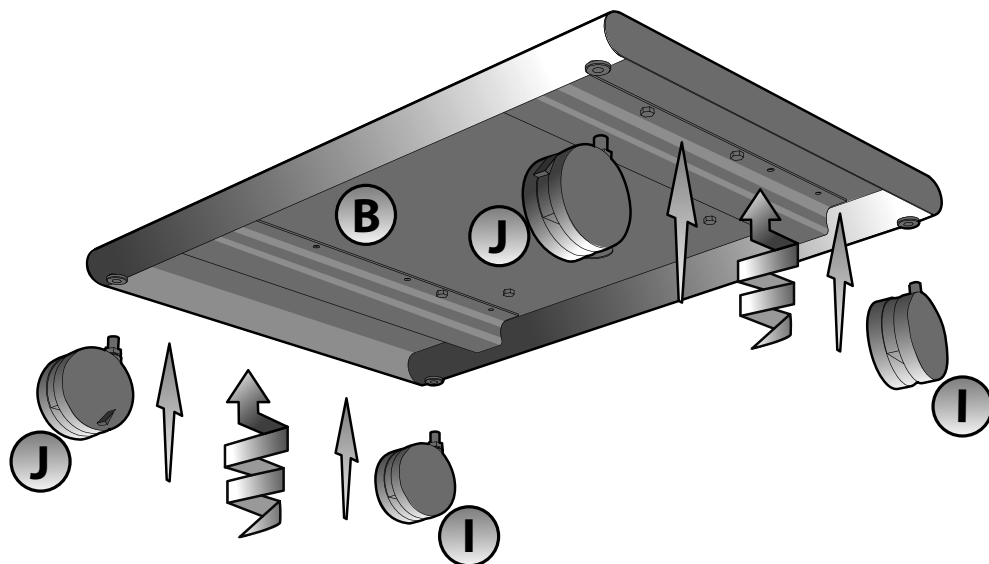
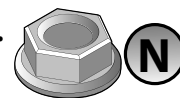

2

Assemble Casters (I, J) to base (B). Two in front with brake and two in the back without brake.

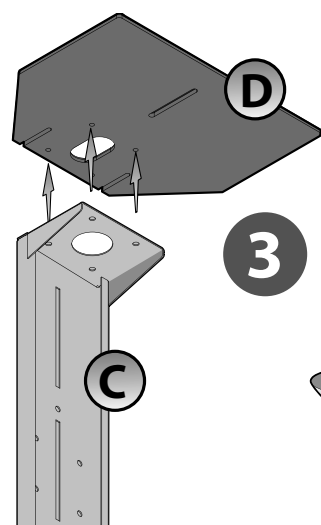

3

Assemble Acrylic Platform (D) to Camera Support (C) using 4 sockets flat head (O) and 4 acorn nuts (L)

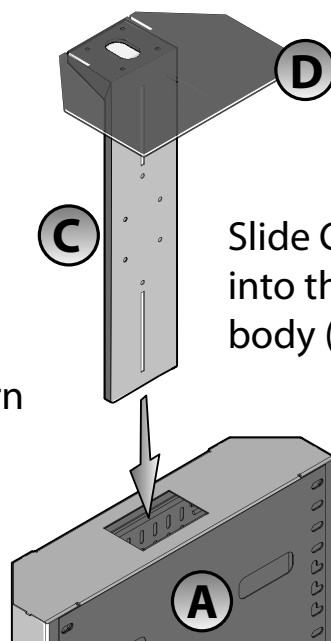
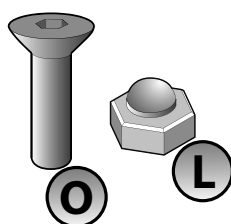

4

Slide Camera Support (C) into the hole on top of body (A)

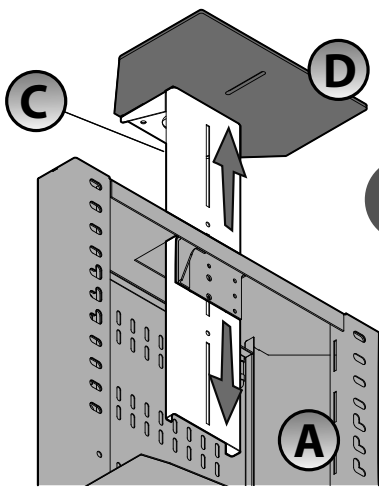

5

Adjust Camera Support (C) height according to the size of your TV and then secure the position using two 1/4"x3/4" screws



6

Refer to wall mount instructions.

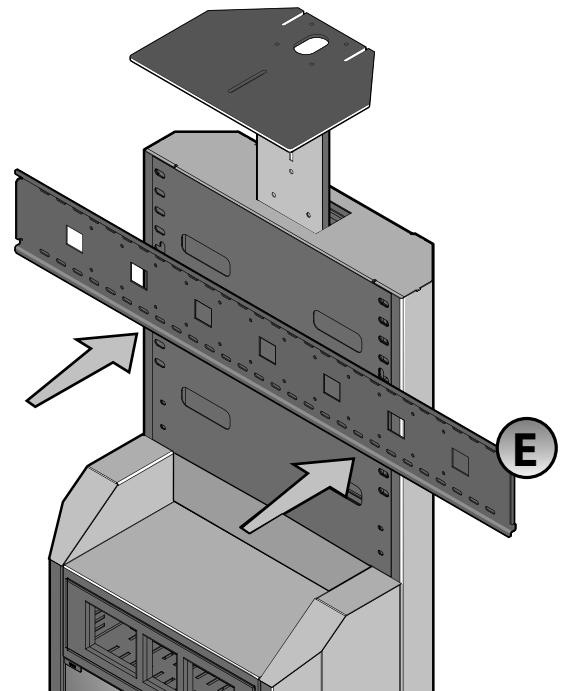
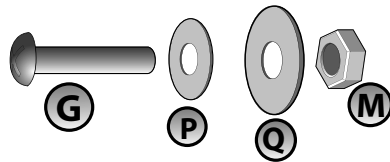
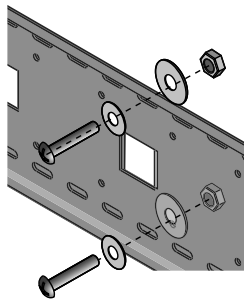

8

Hang the TV to the Support (E)

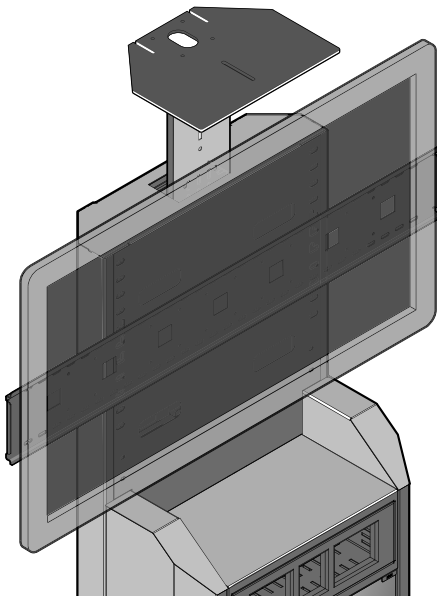

9

Assemble the handles (F) to the support (E) using the screws on the handle and 4 flang nut (K).

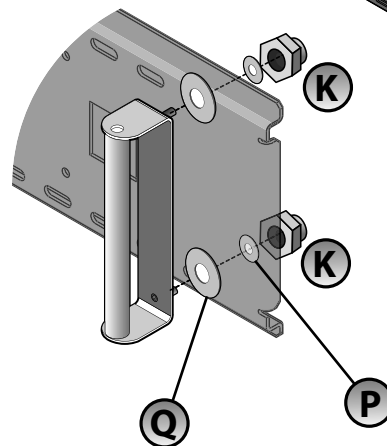
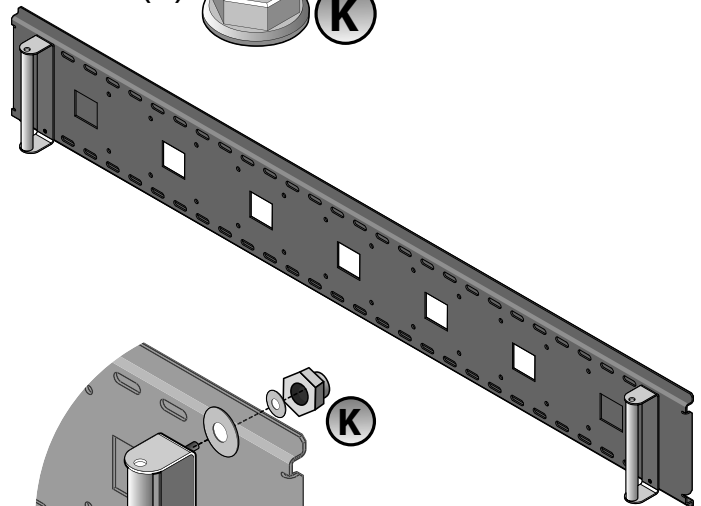
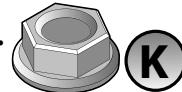

Lock Assembly

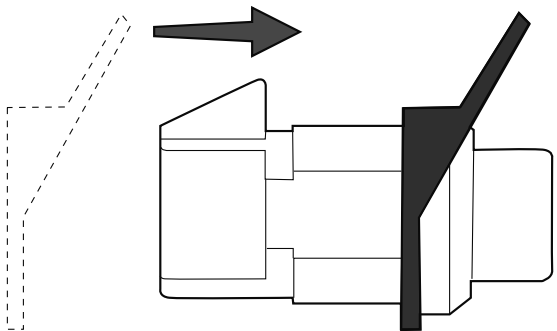
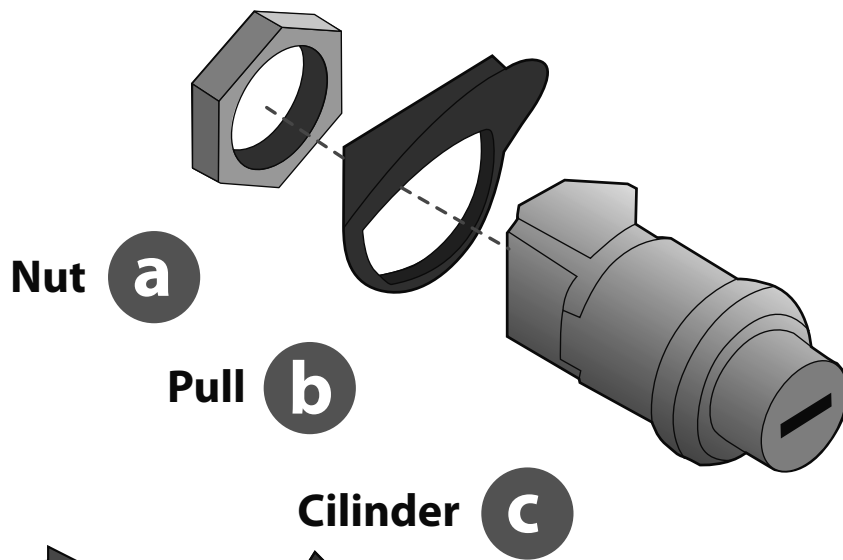

- 1** Slide Pull over Cylinder. The Flange must be as shown in the diagram

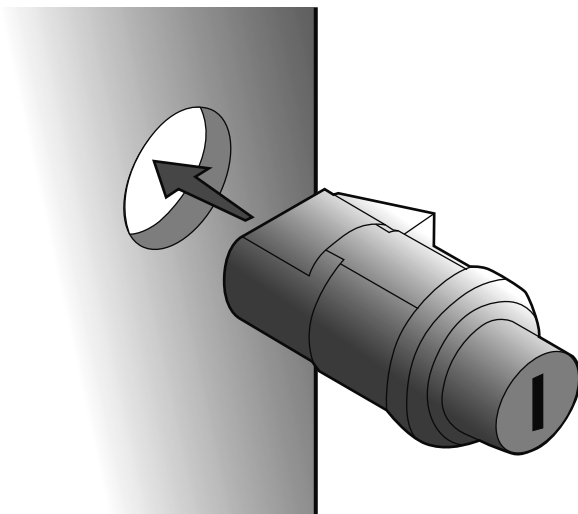

- 2** Slide Cylinder through hole in glass as shown in diagram

- 3** Twist Nut onto Cylinder as shown in diagram. Ensure that it's placed in the correct position as shown in diagram.

