

CTSLWSQ12 Assembly



WOOD SCREW
(x8)



BOLT
(x8)



#58 CAM LOCK
(x8)



DOWEL PIN
(x4)



SIDE PANEL A (x2)



SIDE PANEL B (x2)



BOTTOM PANEL C (x1)



TOP PANEL D (x1)



1. Insert 4 pcs bolt into both Side Panel B (insert total of 8 bolts).



2. Insert cam locks into holes of both Side Panel A.



3. With Panel A lying flat with cam locks facing up, align and insert bolts sticking out of Panel B with holes on the side of Panel A. Repeat with second Panel B. Tighten cam locks with screwdriver.

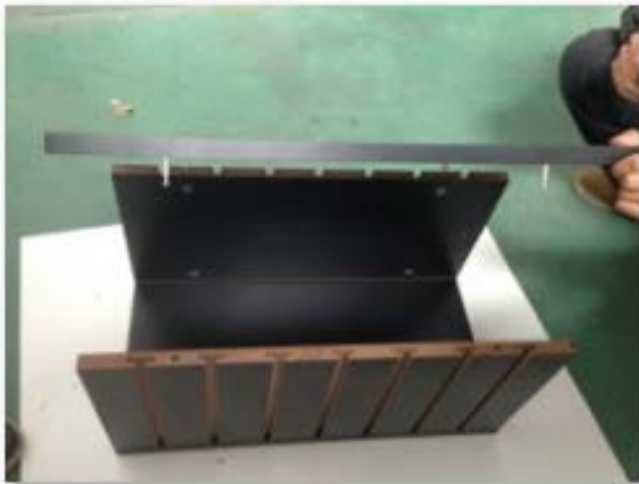

4. Aligning bolts with holes, attach final Side Panel A.



5. Again, tighten the 4 cam locks with a screwdriver.

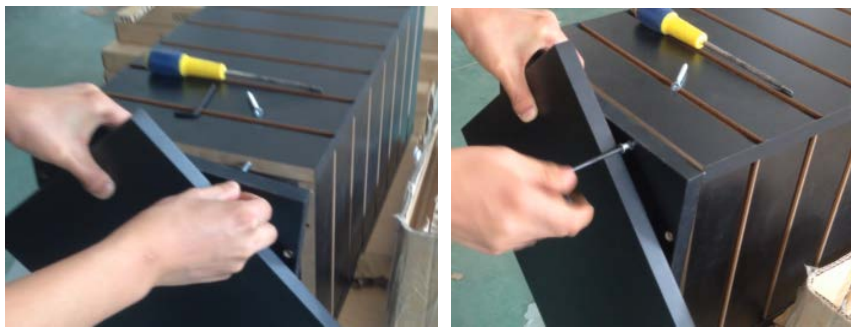

6. Align Bottom Panel C with the assembled square, rotating the base to reveal screw holes. Using the 8 wood screws and allen key, secure the base and assembled square together.



7. Flip spinner upright and insert 1pc wooden dowel on the upper inside of each panel (insert a total of 4pcs wooden dowels).



8. Insert Top Panel D into the assembled square, resting it on the wooden dowels.