

ASSEMBLY INSTRUCTIONS

DCKDWD - Floor Standing Wood Display Case - Single Door

IMPORTANT SAFETY INFORMATION:

Read all instructions before start installing the unit. Displays2go is not responsible for any damage or injury caused by incorrect installation, assembly or use. 2 people or more are required for assembling.

PARTS LIST

A. Top Panel	X1
B. Base (with feet)	X1
C. Corner Post	X4
D. Glass Panel (3 side panels, 1 door panel)	X4
E. Glass Shelf	X4
F. Shelf Peg	X16
G. Socket Head Screw	X8
H. Door Lock	X1
I. Glass Door Holder (with plastic insert)	X2
J. Glass Seal	

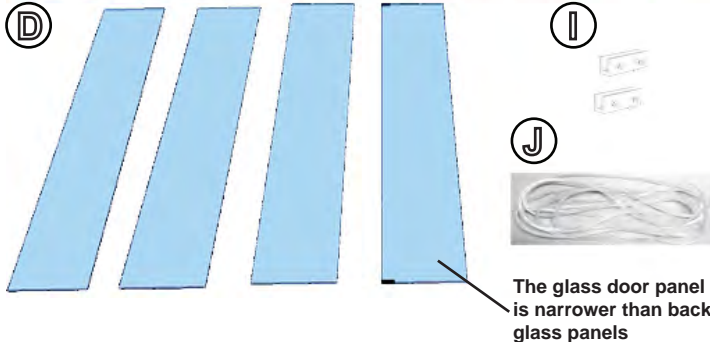
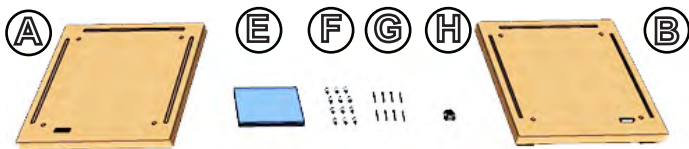

Included: Allen Key



TOOLS NEEDED

-Flat/Phillips Screwdriver



Scan QR code to visit the product page:



1. Insert 1 socket screw (G) from bottom of the Base (B) through the pre-drilled hole. Tighten the screw into the threaded channel in the corner post with provided Allen Key. Do this for all 4 corner posts.

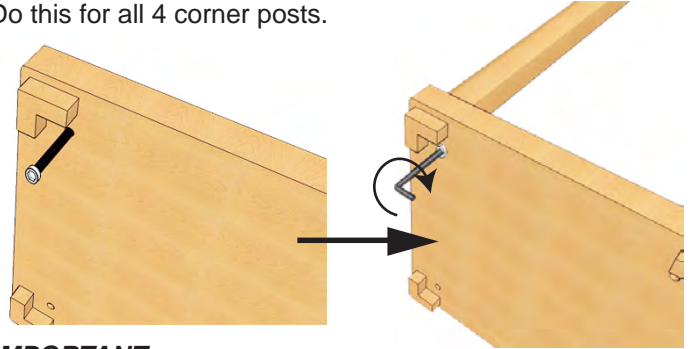

IMPORTANT:

Surfaces on wooden posts without grooves align with the no-groove side of bottom platform.

2. Slide 1 side glass panel (D) into the grooves in adjacent corner posts.

TIPS: Slightly push corner posts to sides to give glass panels more room for easy installation.

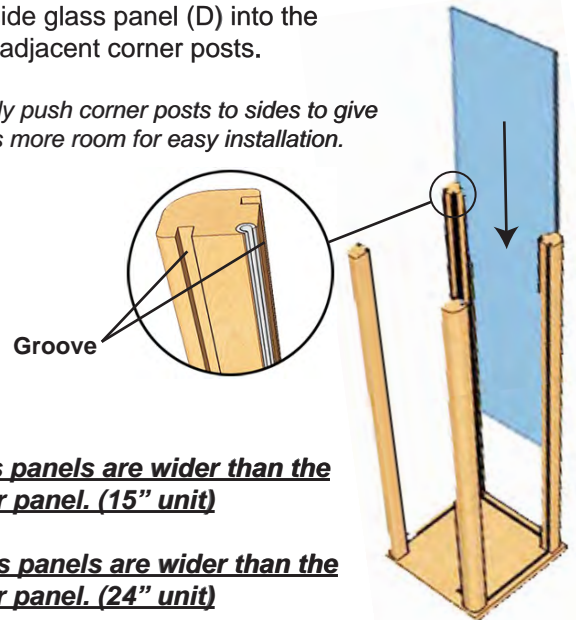

NOTE:

Side glass panels are wider than the glass door panel. (15" unit)

Back glass panels are wider than the glass door panel. (24" unit)

3. Assemble another 2 glass panels (D) to the sides with grooves the same way as shown in Step 2.

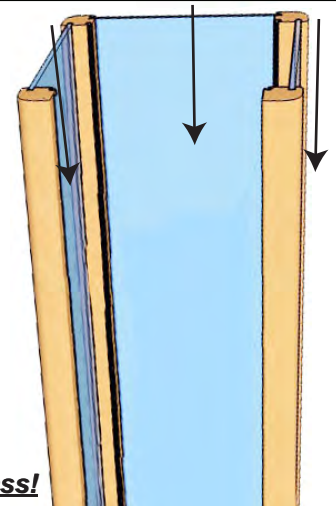

CAUTION:

Be careful when handling glass!

ASSEMBLY INSTRUCTIONS

DCKDWD - Floor Standing Wood Display Case - Single Door

4. Place the wooden top panel (A) on top of the assembled display case, with the no-groove side facing front (glass door side). Secure the top panel to the display case body with 4 screws by using the allen key.

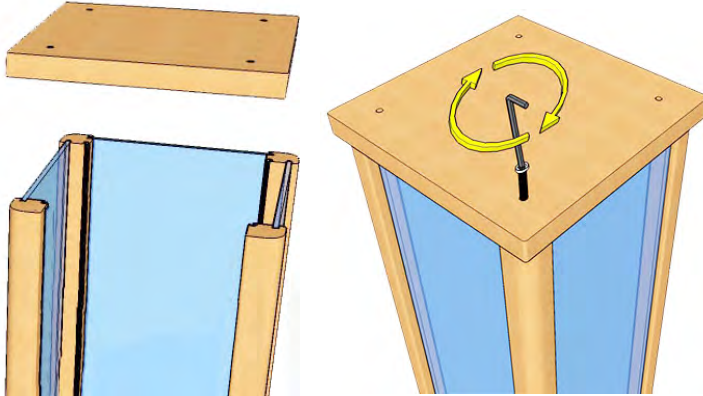

7. Assemble the door lock (H) by securing it on top of the glass door. Test the lock after assembling.

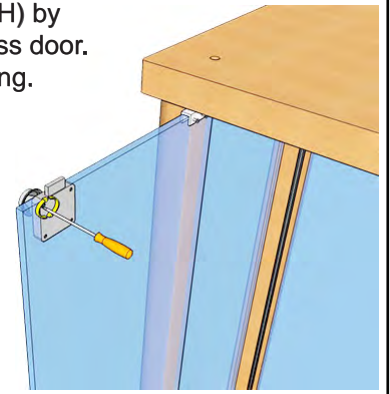

5. Push the plastic inserts into the top and bottom panel, and place the glass door holder (I) in place as shown below. Install the 2nd holder at the top the same way.

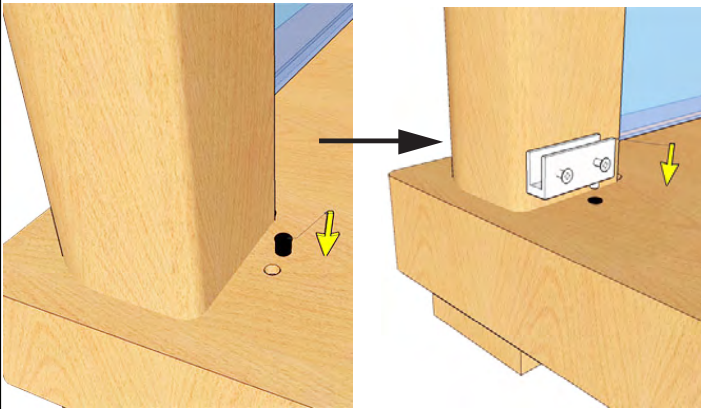

8. Adjust glass pegs on corner posts to desired height if needed. Be sure 4 pegs holding a glass shelf are on the same level. Carefully place 4 glass shelves on the pegs.

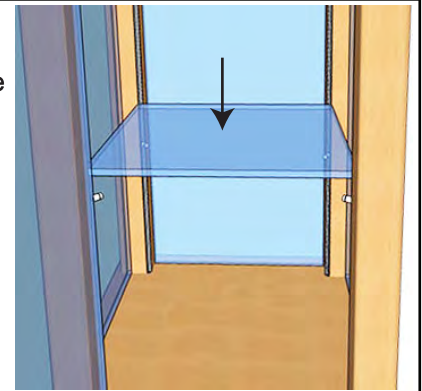

9. Insert the glass seal starting from 1 corner outside the display case. Apply silicon glass seal provided to all edges of the side glass panels.

Tips: Use a flat head screwdriver to help push in glass seals. The assembly is finished.

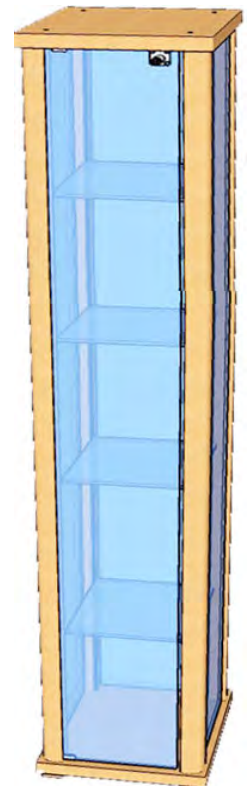
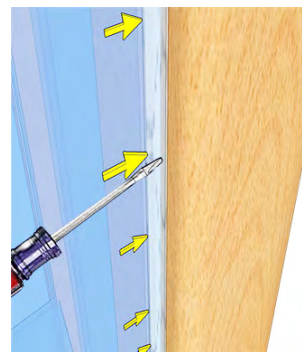
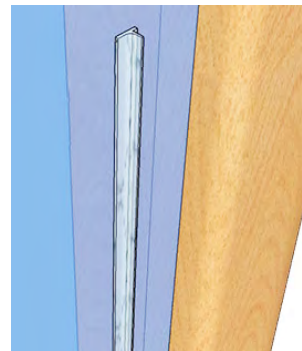

6. Carefully lift the glass door panel (D) and insert both ends into the metal brackets assembled in Step 5. Adjust the glass door to its best fit then tighten screws with screwdriver. *Tips: Open and close the glass panel to check if the door can move freely. Adjust as needed.*

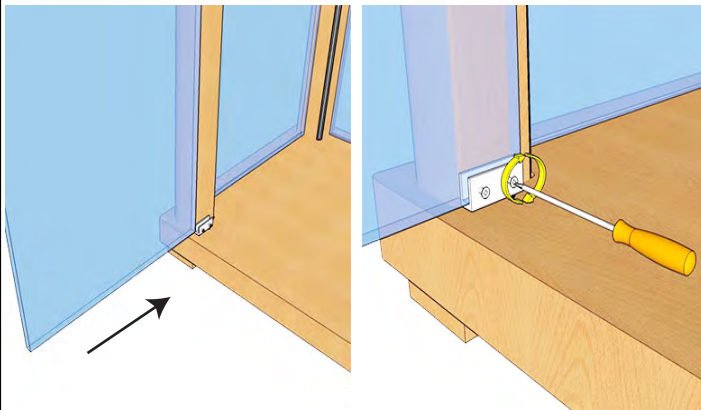

If you have any questions regarding our products, please visit us at www.displays2go.com or contact D2G customer service at 844-221-3388.