

ASSEMBLY INSTRUCTIONS

SMSFSSC35 - Floorstanding Sneeze Guard with Countertop

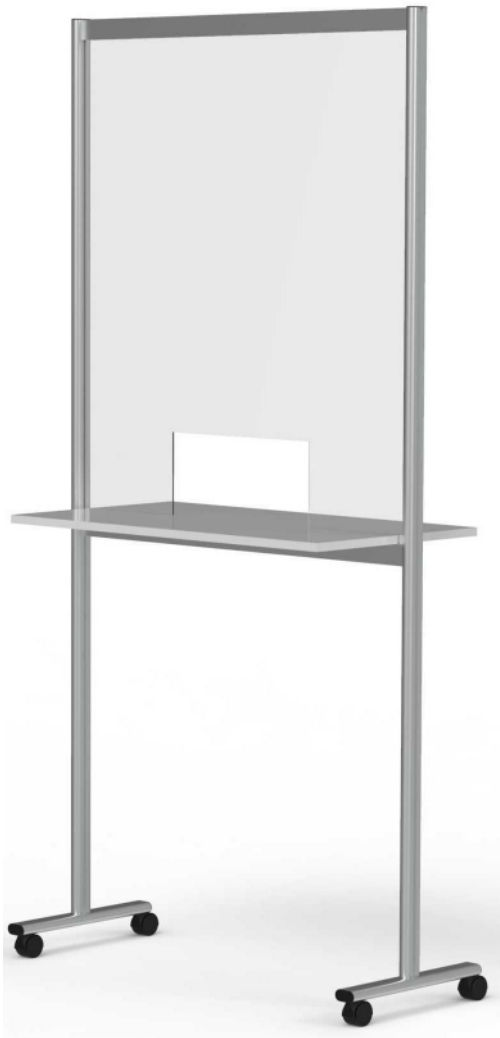

Open the box and place each part side by side on the cardboard.



Scan QR code to visit the product page:

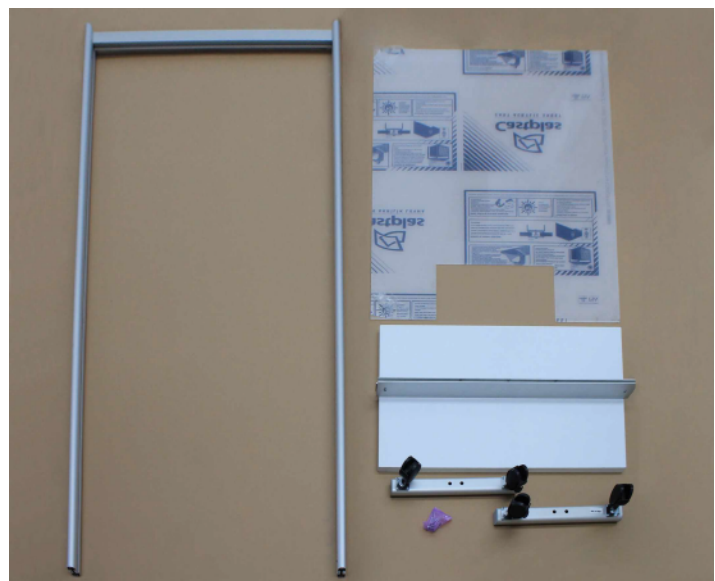

If you have any questions regarding our products, please visit us at www.displays2go.com or contact D2G customer service 844-221-3388.

ASSEMBLY INSTRUCTIONS

SMSFSSC35 - Floorstanding Sneeze Guard with Countertop

Place the aluminum frame on the ground with the open end on top. Insert the acrylic panel into T-slot on each side and slide down the panel from the top as shown. Keep the frame in this position.

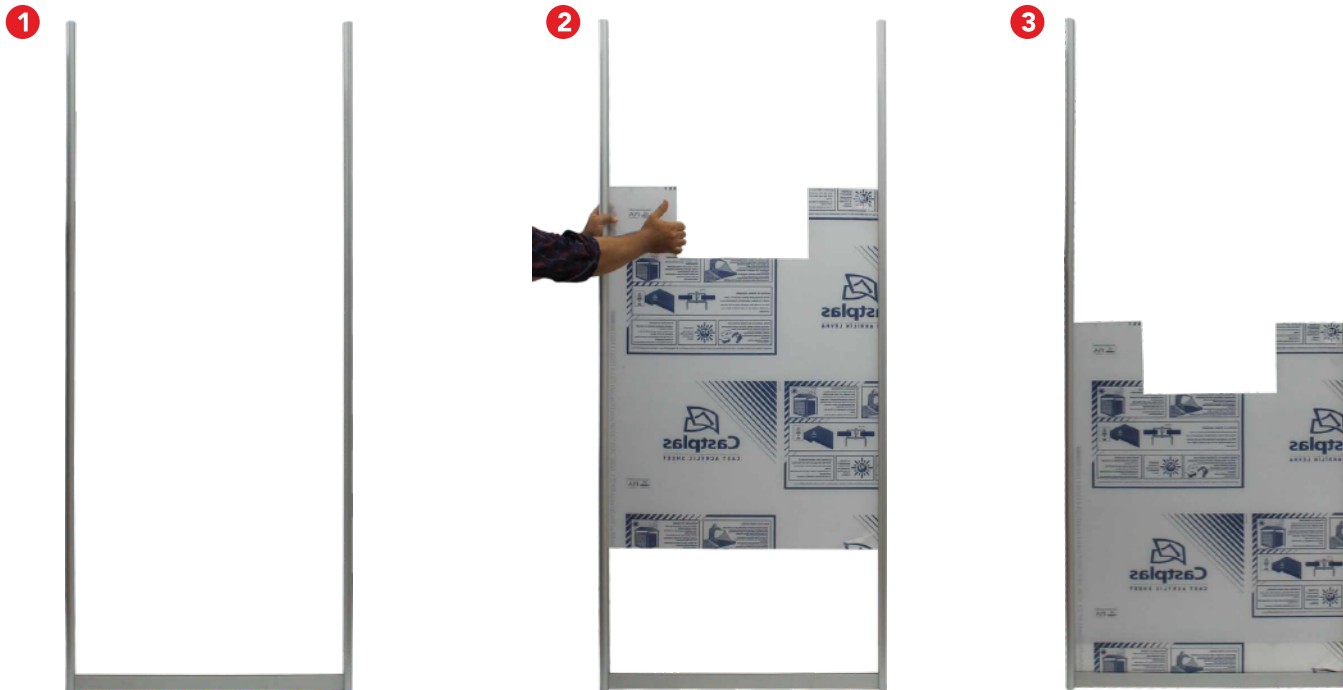

Place the MDF countertop on top of the acrylic panel with the bottom facing up. Make sure the T-anchor on each side are inserted into the T-slot on the frame.



Use the provided allen wrench to tighten the inserted anchors on both sides. Attach 1 foot with wheels to the bottom of the frame and fix it with the screws. Do the same to fix the other foot. Peel off the protective film on the acrylic and the assembly is finished.

