

ASSEMBLY INSTRUCTIONS
10'X20' SEG BACKWALL WITH LED LIGHT - SEGL1020W

IMPORTANT SAFETY INFORMATION:
Please take time to read all instructions before starting assembling the unit. Be sure you fully understand all of the steps needed to finish the assembly.

PARTS LIST

A. Corner Panel	X8
B. Middle Panel	X10
C. Support Bar - Horizontal	X5
D. Support Bar - Vertical	X12
E. Connecting Bar	X4
F. Corner Connector	X8
G. Foot Plate	X4
H. Flat Head Screw	X16
I. Wing Nut	X16
J. LED Light Panel	X4
K. LED Light Cable	X2
L. Plastic Clip	X32
M. Power Adapter	X2
N. Insert Nut	X16

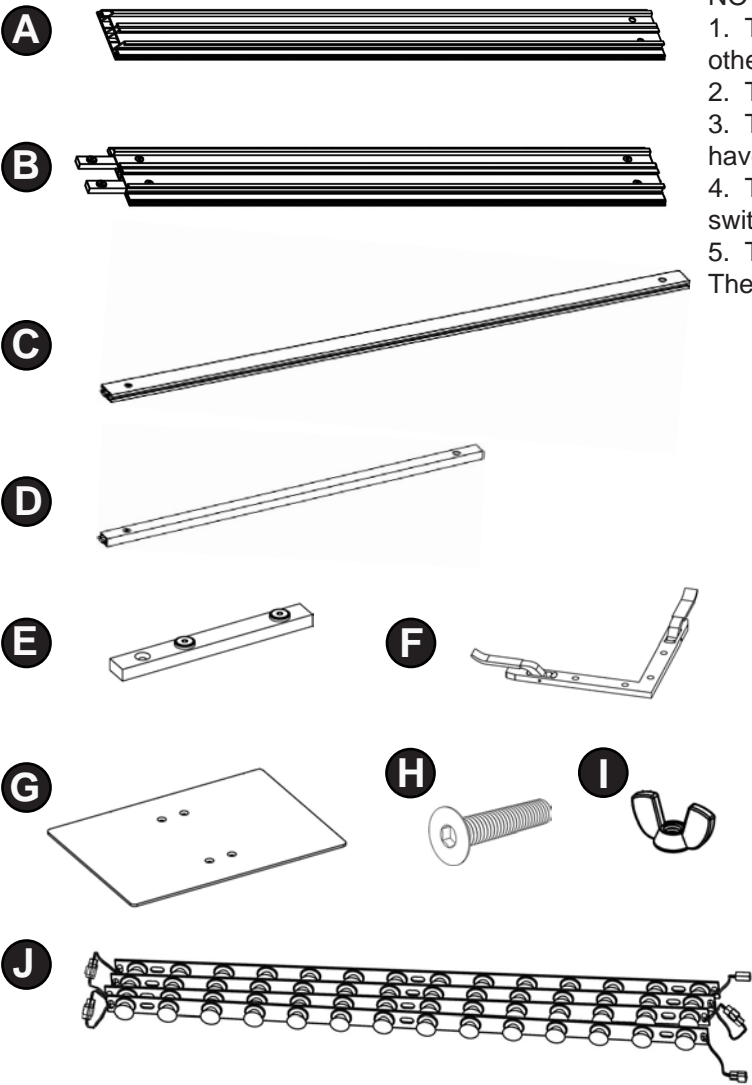

NOTE:
1. The corner panels have 45° miter cut for joining other corner panels.
2. The vertical panels have wire clips attached.
3. The bottom panels that connect with foot plates, have through holes drilled.
4. The vertical panels with power outlet and power switch are to be assembled to bottom corner.
5. The Horizontal Support Bar is 47.6 inches. The Vertical Support Bar is 29.13 inches.

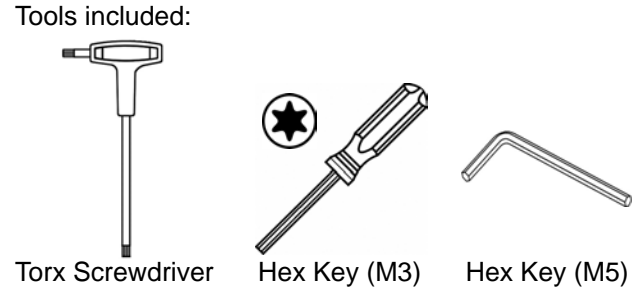
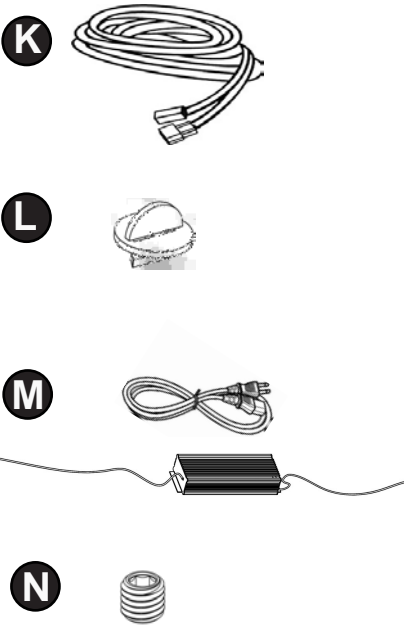

NOTE:
(1) At least 3 persons are required to complete the assembly.
(2) Make sure that you have all included parts and hand tools before you begin the assembling process.
(3) The SEG frame is 10' in height and 20' in width. The assembling space must be large enough to house the entire frame.
(4) For your safety, DO NOT use ladder when assembling the SEG backwall.

ASSEMBLY INSTRUCTIONS

10'X20' SEG BACKWALL WITH LED LIGHT - SEGL1020W

DISPLAYS2GO

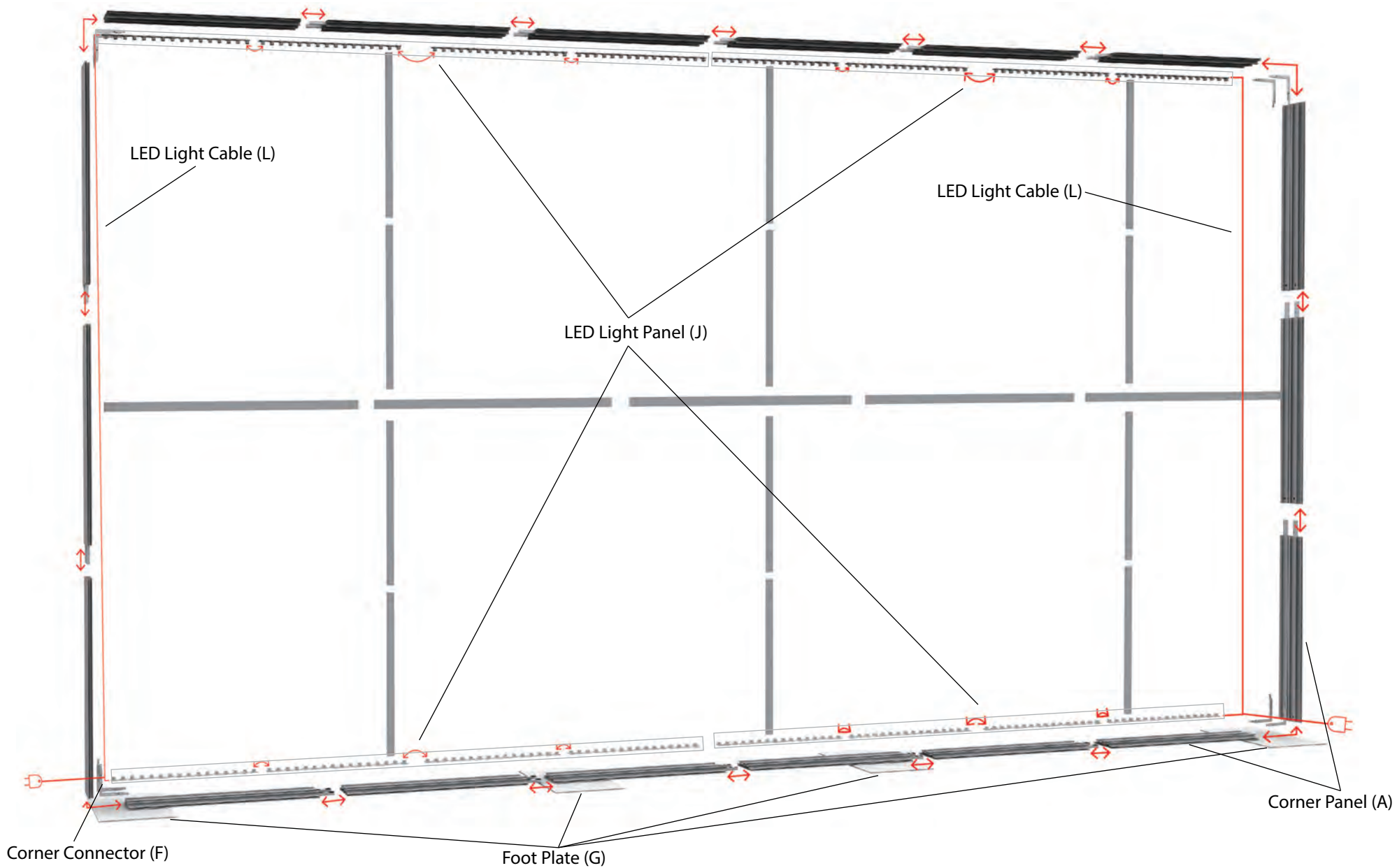

TIPS:

1. Unpack and remove all aluminum extrusion panels from the shipping bag. Identify each part and lay them on a clean, non-abrasive surface to avoid any scratch.
2. All panels and bars are labeled for easy assembling. **Lay out each part at its position by matching the numbers before you start assembling.**

ASSEMBLY INSTRUCTIONS

10'X20' SEG BACKWALL WITH LED LIGHT - SEGL1020W

DISPLAYS2GO

Step 1. Assemble the top panel, bottom panel, and side panels using Corner Panel (A) and Middle Panel (B).

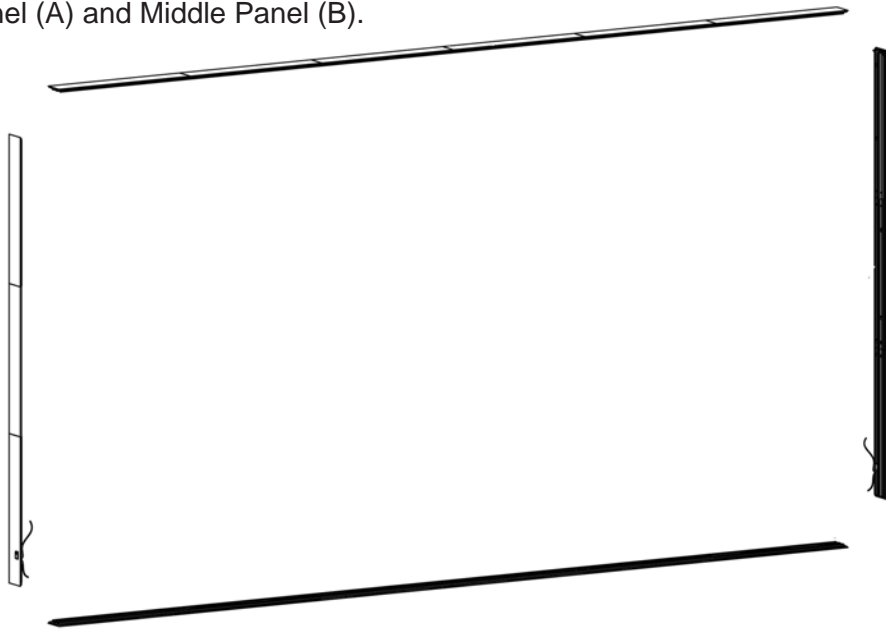

Remove screws from bar connectors on one panel. Insert bar connectors into the corresponding panel, and fix two panels by tightening screws back onto the bar connectors.

Tips: Use the provided Torx Screwdriver.

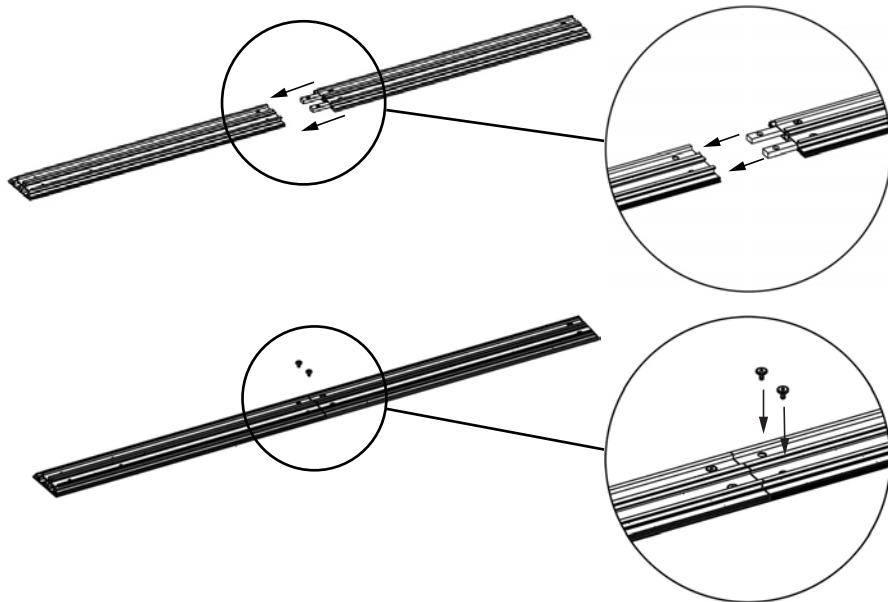

Step 2. Connect panel assembly together with Corner Connectors (F) by matching the number on the label.

Insert Corner Connectors (F) into the channels on sides of the frame panel. Make sure the panels connect with no gap, then tighten the insert screw with the provided Allen key (M3). Secure the angle connector by pushing down the handles on both sides.

Repeat the step for other corners until the frame is securely assembled.

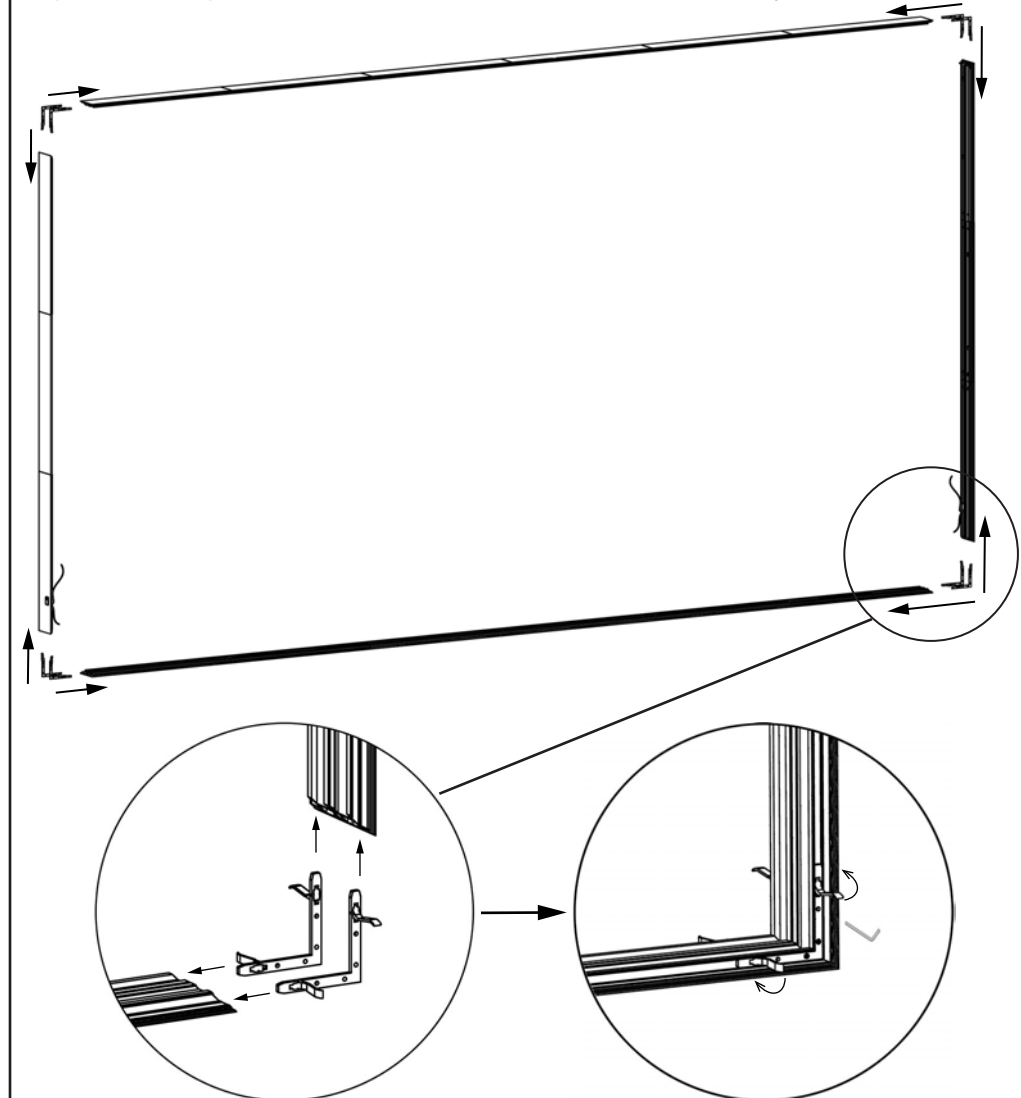

Optional: Fasten the included Insert Nuts (N) to the angle connectors to enhance stability.

ASSEMBLY INSTRUCTIONS

10'X20' SEG BACKWALL WITH LED LIGHT - SEGL1020W

DISPLAYS2GO

Step 3. Assemble 5 horizontal Support Bars (C) together with 4 Connecting Bar (E). Place the assembled support bar in the middle of the SEG frame by matching the numbers on parts. Secure the support bar to the center "T" slot by tightening the screws at both ends. Pair 2 matching Vertical Support Bars (D) and secure them with the connecting bar. You should get 6 vertical bar assembly. Secure 2 assembled bars with the horizontal bar and the SEG frame by tightening the screws as shown.

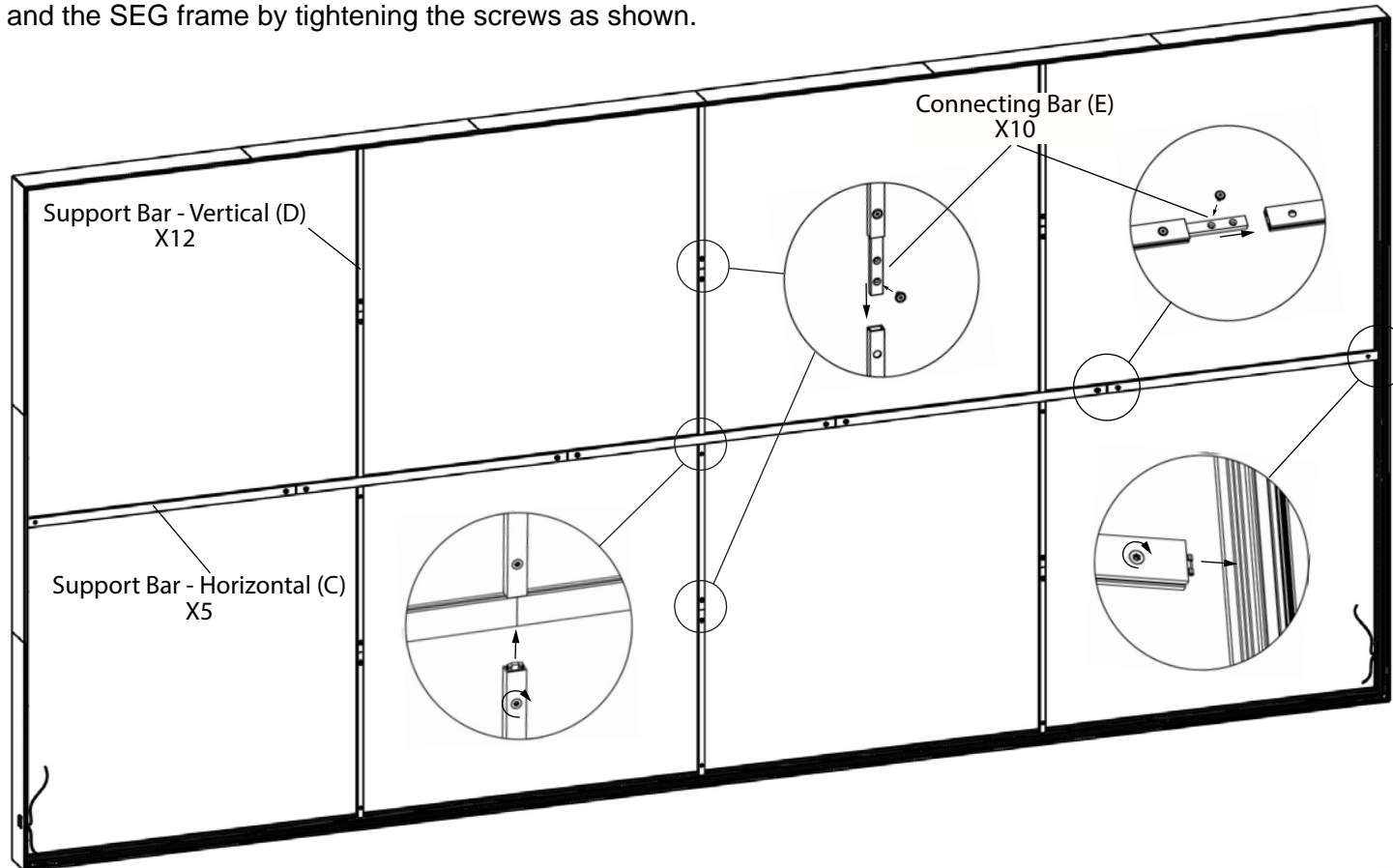

Step 4. Fix Foot Plates (G) to the bottom of the assembled SEG frame by using Hex Screws (H) and Wing Nuts (I).

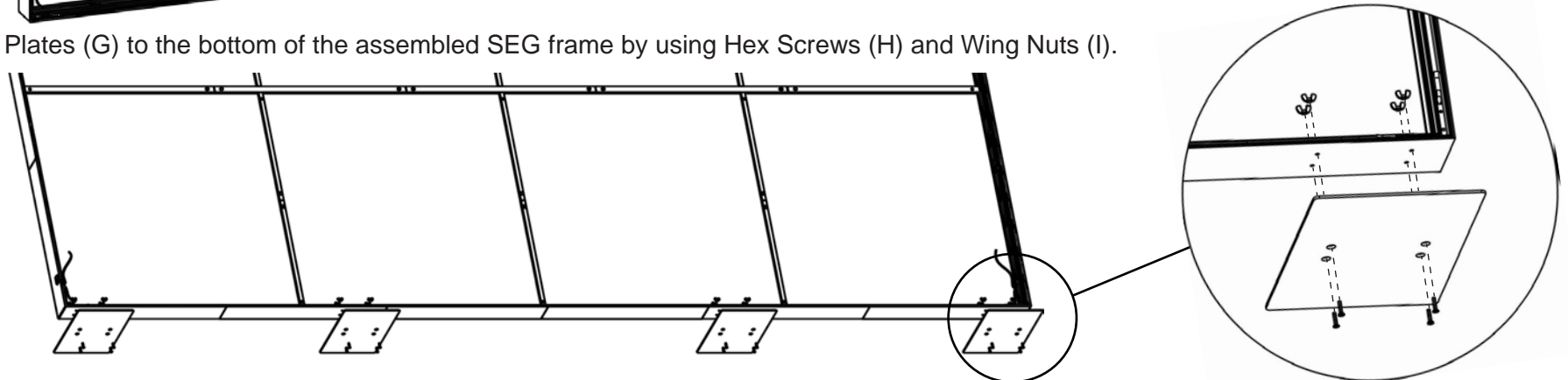

ASSEMBLY INSTRUCTIONS

10'X20' SEG BACKWALL WITH LED LIGHT - SEGL1020W

DISPLAYS2GO

Step 5. Lay 1 LED Light Panel (J) onto the center groove in the bottom SEG panel, and connect the LED panel with power module. Fix the LED Panel to the SEG frame by inserting the Plastic Clips (L) into the slot in the LED Panel. Turn the clips clockwise to lock. Fix the other 3 LED light panels to the bottom the same way, and use the Light cable (K) to connect the LED light with the power module on both sides. Use wire clips inside SEG frame to fix light cables to vertical panels.

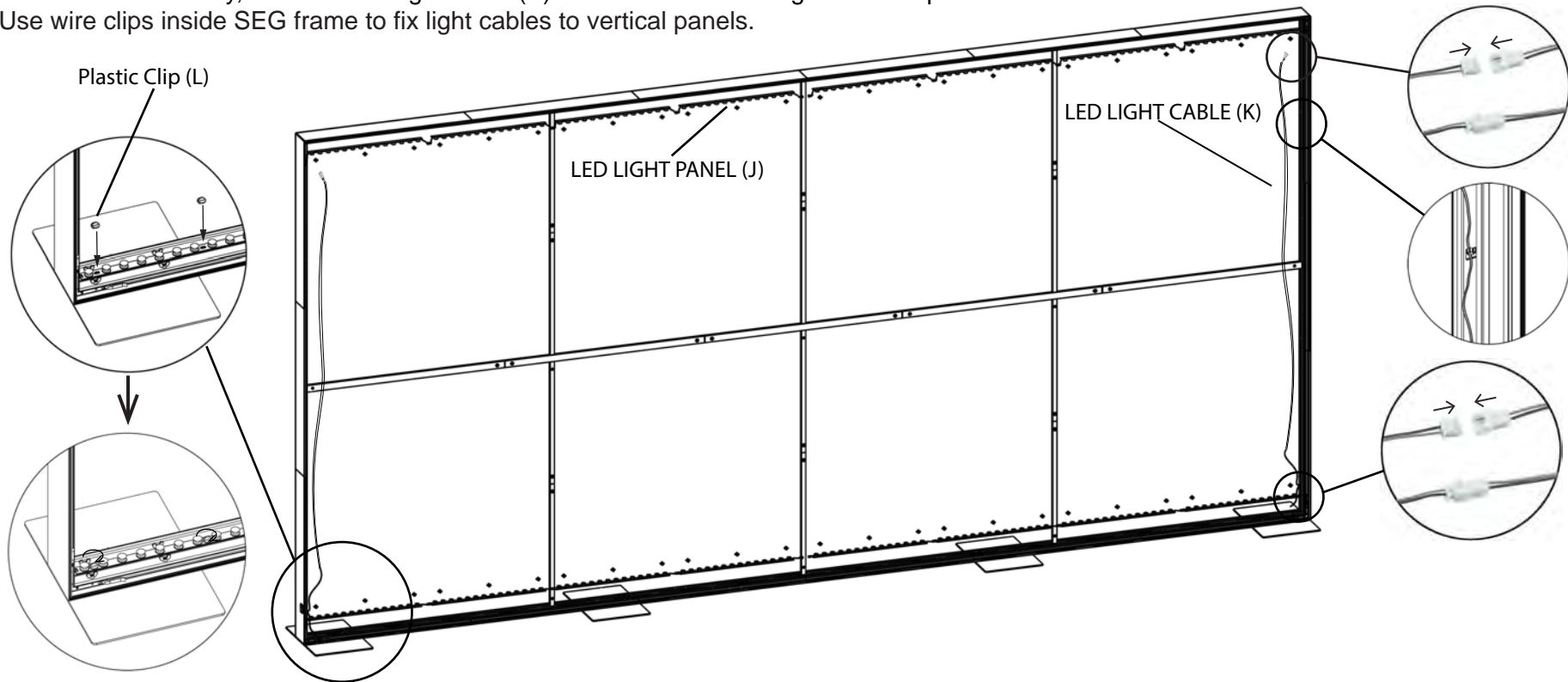

Step 6. Assemble the SEG graphics to one side of the frame by inserting the silicon edges into the grooves on the side of the frame. Carefully flip the assembled SEG frame and assemble the other side the same way. Make sure the graphic is fully stretched.

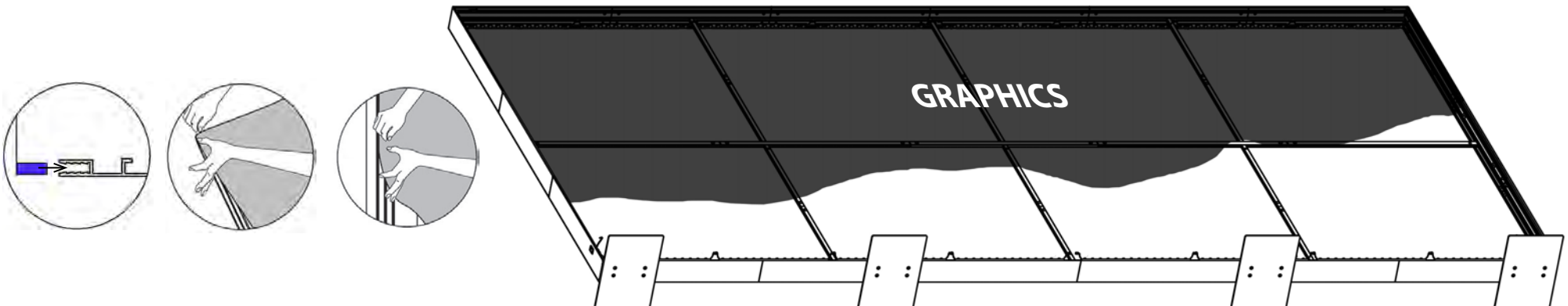

ASSEMBLY INSTRUCTIONS

10'X20' SEG BACKWALL WITH LED LIGHT - SEGL1020W

DISPLAYS2GO

Step 8. Carefully lift up the assembled SEG backwall to its standing position. Connect Power Adapters (M) to the power modules on both sides from the outside of the SEG frame, then plug in to the power outlet.

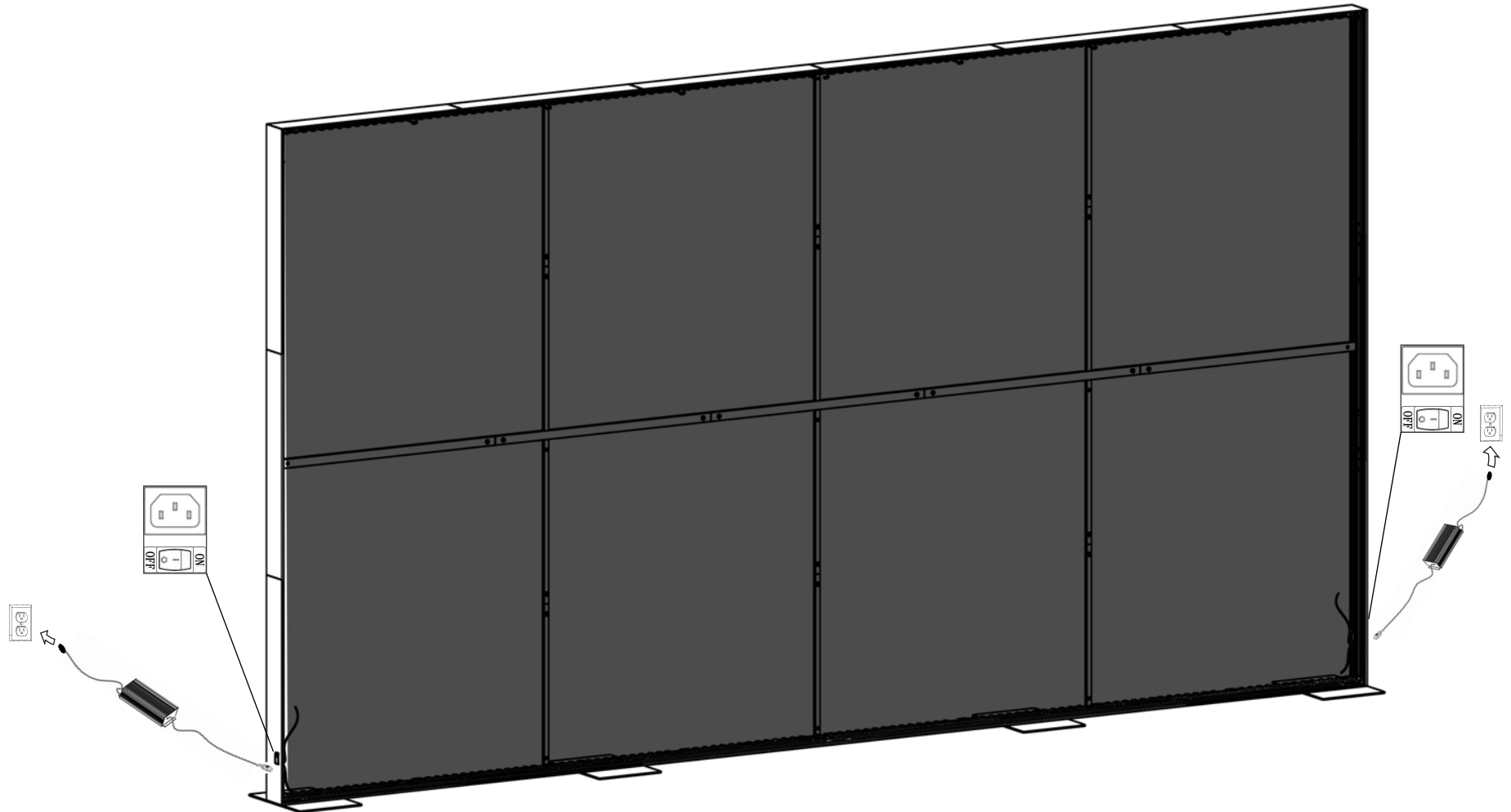

Turn on the power switch at the bottom. The assembly is finished.

Scan QR code to visit
the product page:

