

ASSEMBLY INSTRUCTIONS

POLECLIP - Clamps for Foam Boards

Rev 21.05

1. Separate the clamp by loosening the screws. Install the clamp onto your pole and tighten the screw to fix the clamp at the desired height.
2. Turn the thumb screw back and place the printed foam board inside the clamp.

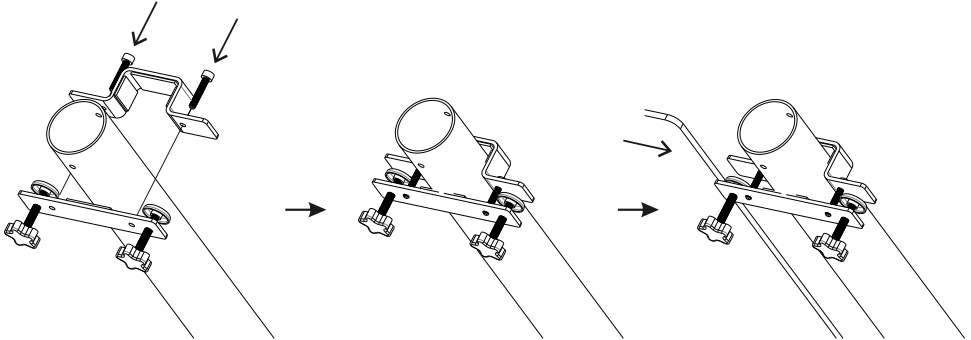

3. Tighten the thumb screws on both top and bottom clamps to secure the foam at the place.
4. Attach the 2nd foam board at the same height on the other side and the assembly is finished.

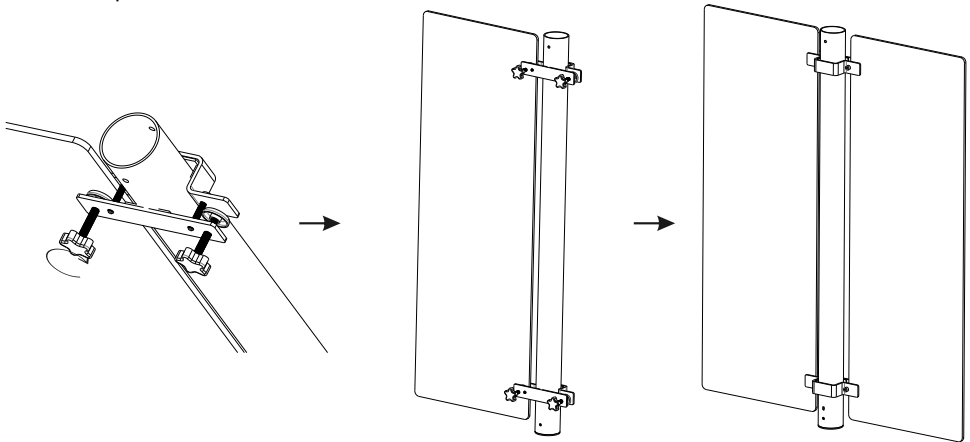

If you have any questions regarding our products, please visit us at www.displays2go.com or contact D2G customer service 844-221-3388.