

ASSEMBLY INSTRUCTIONS

DGCLRSR5572 - Floor Standing Sneeze Shield

Steps:

1. Attach vertical poles to bases with screws provided.
2. Lay the rolled-up clear screen between the vertical poles. Slide 1 horizontal pole into the top pocket of the screen.
3. Attach the top pole with screen to the holes at the top of the vertical poles by using the screw-knobs.
4. Extend the vertical poles while slowly unrolling the screen until it is hanging freely. Tighten each telescoping pole securely by hand.
5. Slide the other horizontal pole through the pocket at the bottom of the screen.
6. Attach the horizontal pole with screen to the holes at bottom of the vertical poles with screw-knobs. Adjust the height on each side as needed.

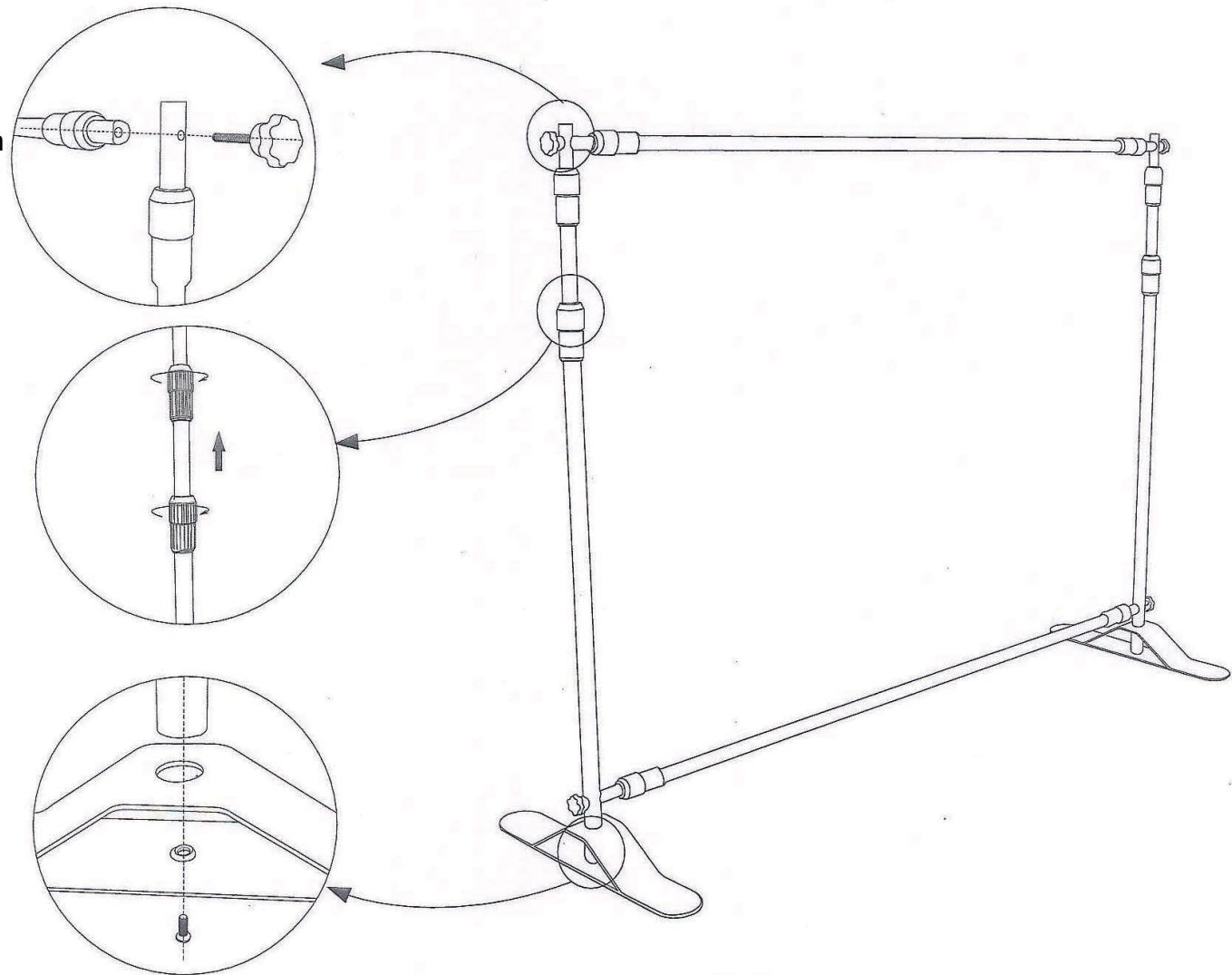

Scan QR code to visit
the product page:

