

ASSEMBLY INSTRUCTIONS

FGSSBSBKCP, FGSSBLBKCP, FGSSBSSLCP, FGSSBLSLCP Sidewalk Street Barrier with Graphics

V21.05

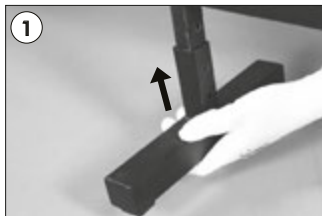

1. Attach the iron feet to the profiles that are under the frame.

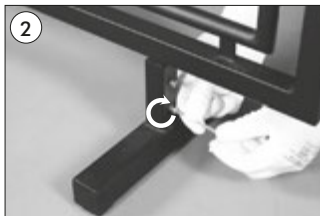

2. Tighten the screws on the side using allen key and fix the feet to profiles.



3. Fit the plastic buttons into the rivet from both sides.



4. Secure the plastic buttons with screw.

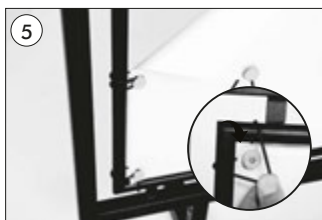

5. Starting from a corner, fix the poster inside the frame using elastic straps.



Scan QR code to visit the product page:

