

Tape Shaft Assembly:

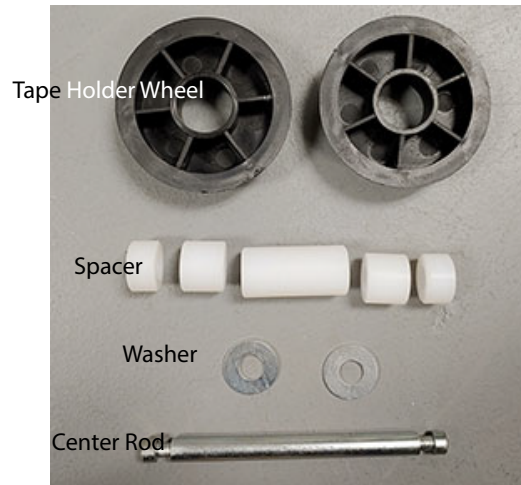

Scan QR code to visit the product page:



How to install the tape:

1. Select the spacer rings that best fit your tape roll width and slide them onto the core rod.
2. Sandwich the tape roll (sold separately) with 2 holder wheels from the side.
3. Slide the assembled tape roller onto the spacer rings and the core rod.

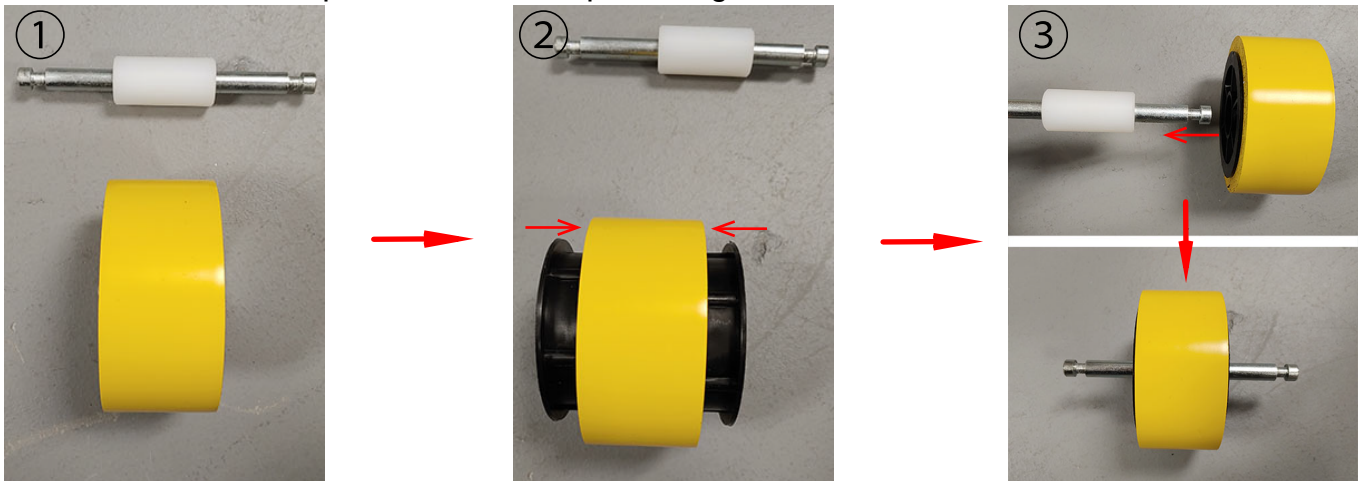

4. Assemble 1 washer on each side to hold the tape. Assemble the remaining spacers from both sides.
5. Place the assembled tape and rod onto the roller brackets.
6. Unwind the tape with adhesive side up and feed on to the tape press wheel at the front as shown.



If you have any questions regarding our products, please visit us at [www.displays2go.com](http://www.displays2go.com) or contact D2G customer service 844-221-3388.