

ASSEMBLY INSTRUCTIONS

LEDDCP - Illuminated Metal Pedestal

Ver. 10/19

IMPORTANT

Read all instructions before assembling the unit. Displays2go is not responsible for any damage or injury caused by incorrect installation, assembly or use.

PARTS LIST

| | |
|-----------------------------|----|
| A. Frame Module | X1 |
| B. Frame Module with Door | X1 |
| C. Aluminum Bar - Top | X2 |
| D. Aluminum Bar - Mid & Bot | X4 |
| E. Side Panel - Clear | X2 |
| F. Side Panel - Black F1 | X1 |
| Side Panel - Black F2 | X1 |
| G. Top Panel - Clear | X1 |
| H. Bottom Panel - Black | X1 |
| I. LED lighting Panel | X1 |
| J. White Panel | X1 |
| K. Plastic Endcap | X4 |
| L. M3X12 Pointed Screws | X8 |
| M. M4X8 Machine Screws | X4 |
| N. Torx Wrench | X1 |
| O. Power Adapter Charger | X1 |

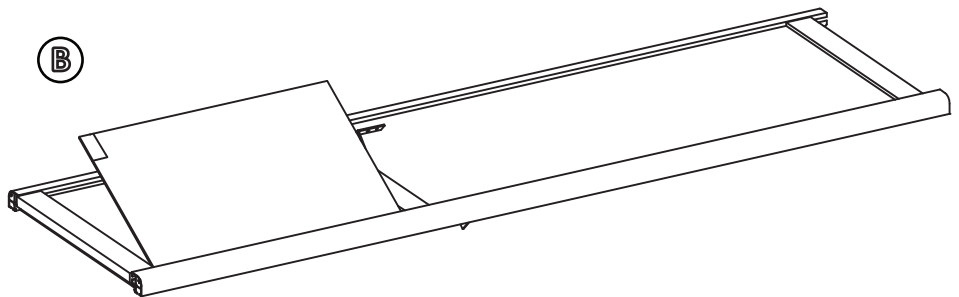
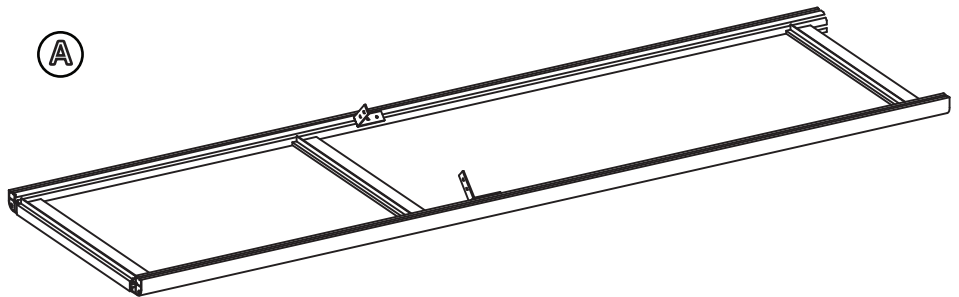

(C)



(G)

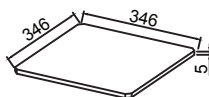

(K)



(D)



(H)



(L)



(E)

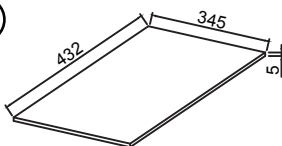

(I)

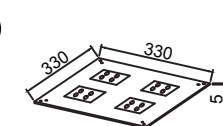

(M)



(F)

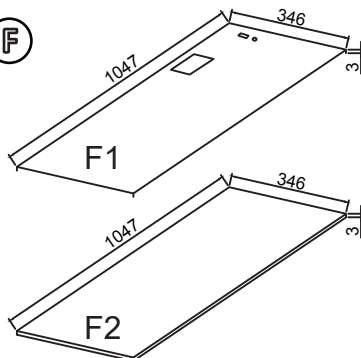

(J)

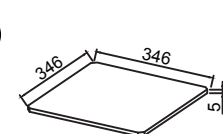

(N)

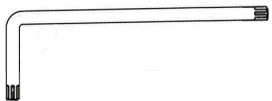

(O)

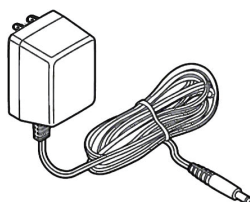

ASSEMBLY INSTRUCTIONS

LEDDCP - Illuminated Metal Pedestal

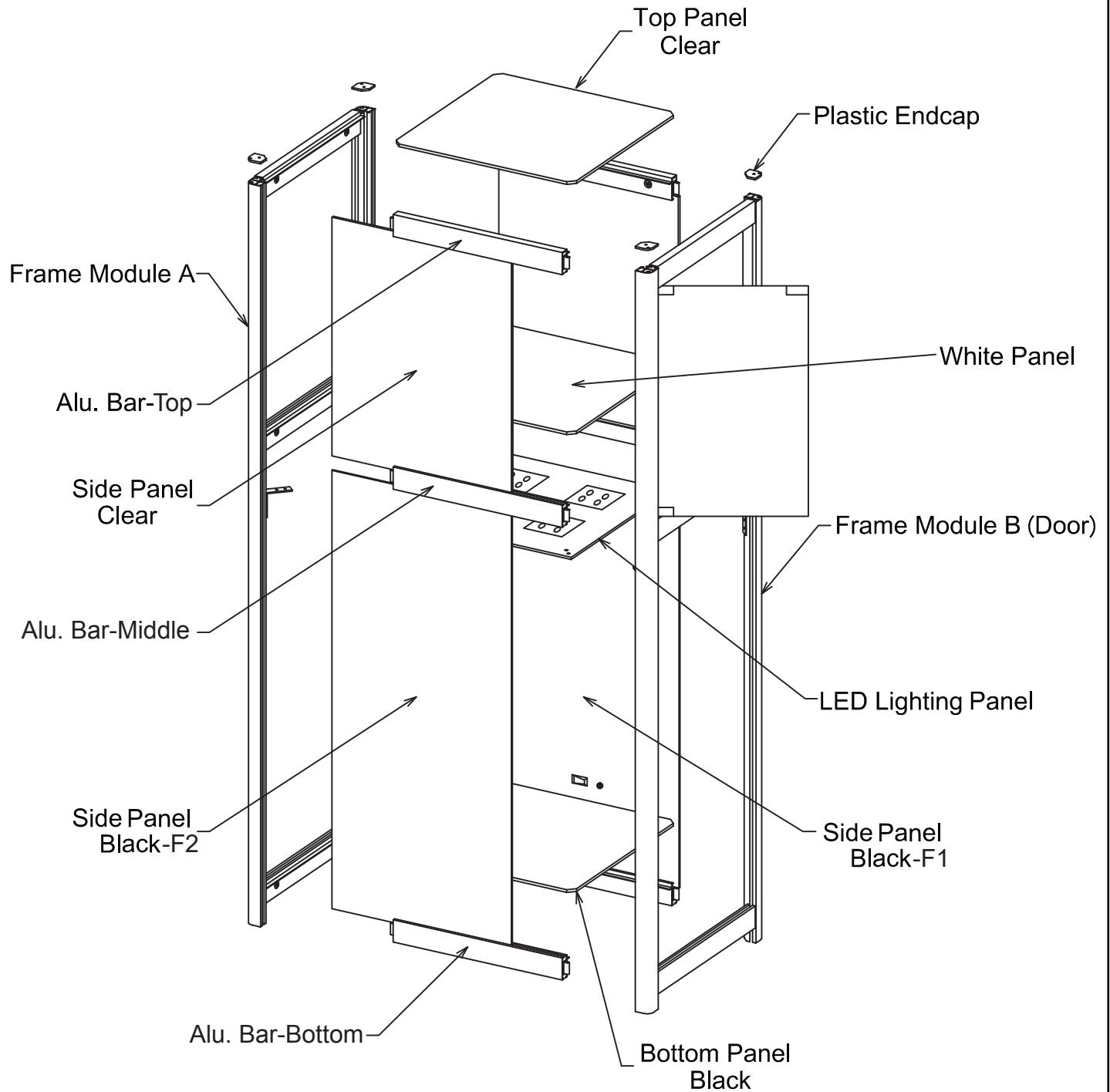

NOTE:

1. Top aluminum bar has T-slot on one side ONLY.
2. Middle and Bottom aluminum bars have T-slot on both sides.
3. Bottom aluminum bar has velcro glued on the bottom.

ASSEMBLY INSTRUCTIONS

LEDDCP - Illuminated Metal Pedestal

STEP 1

Place Frame Module (A) on a flat surface. Insert the aluminum bars into the grooves on both sides of the Frame Module, then fix alu bars by fastening the screws with the wrench (N).

NOTE: DO NOT tighten completely at this point.

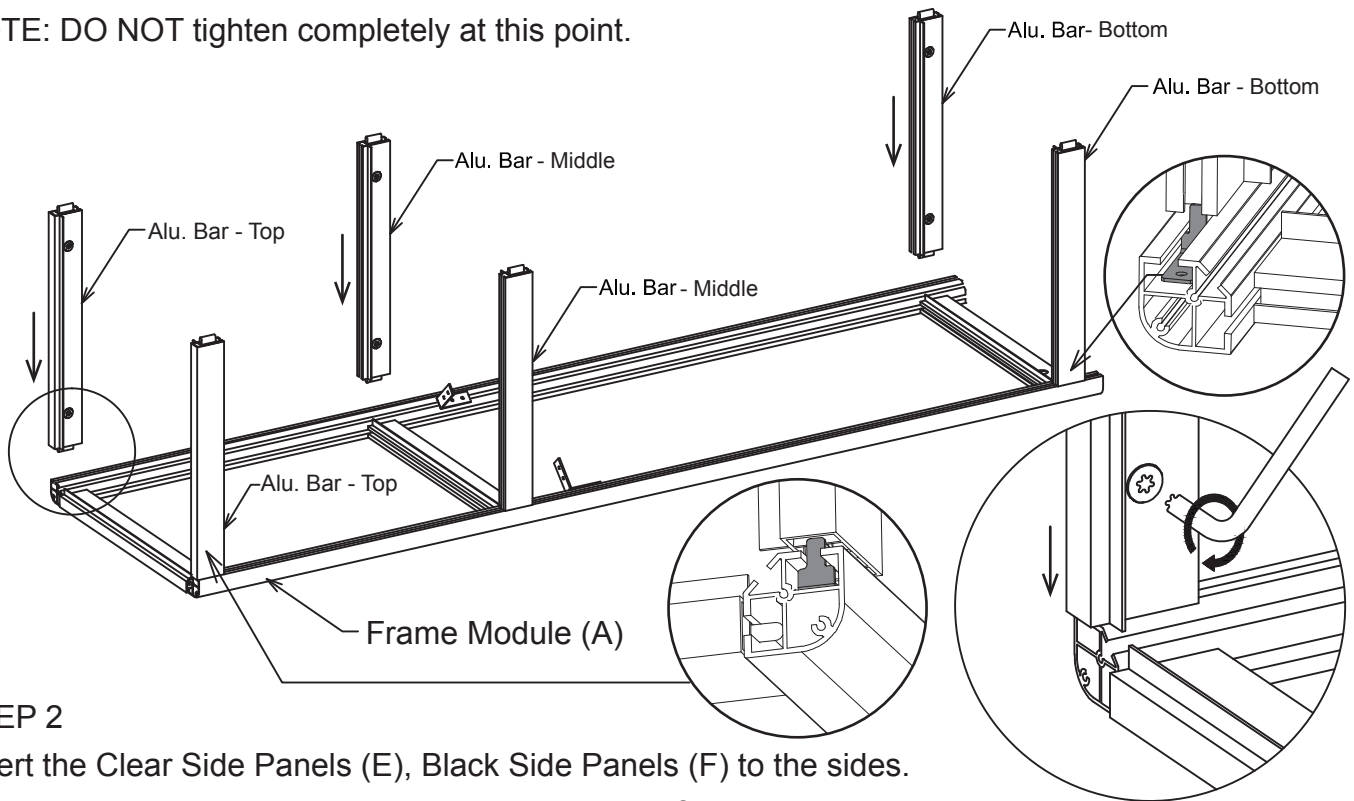

STEP 2

Insert the Clear Side Panels (E), Black Side Panels (F) to the sides.

Attach Black Bottom Panel (H) to the velcro on the fixed aluminum bars.

Make sure all the panels fit inside grooves and tighten the screws in the aluminum bars that connecting with Frame Module (A).

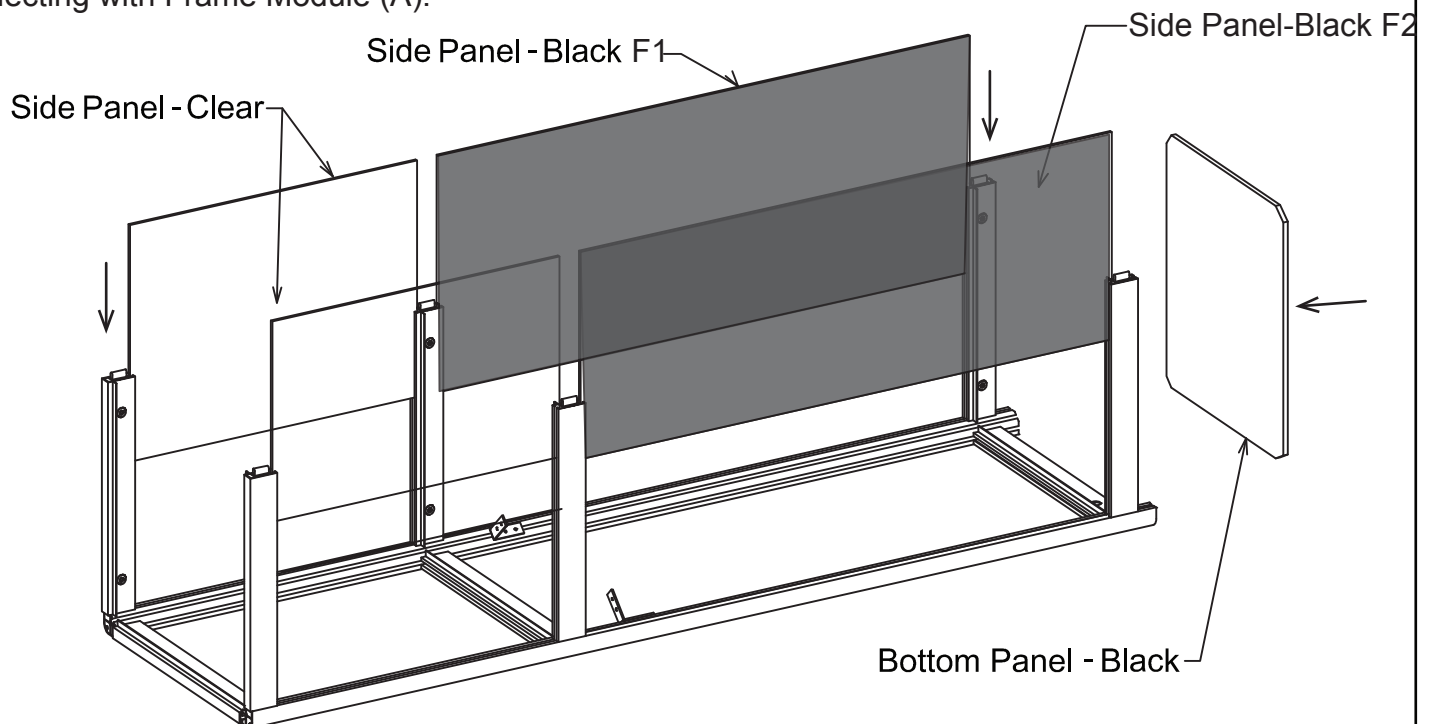

ASSEMBLY INSTRUCTIONS

LEDDCP - Illuminated Metal Pedestal

STEP 3

Connect the Frame Module with Door (B) with the assembled pedestal body. Be sure all the bar connectors and all panels inserted into the grooves on the Frame Module (B).

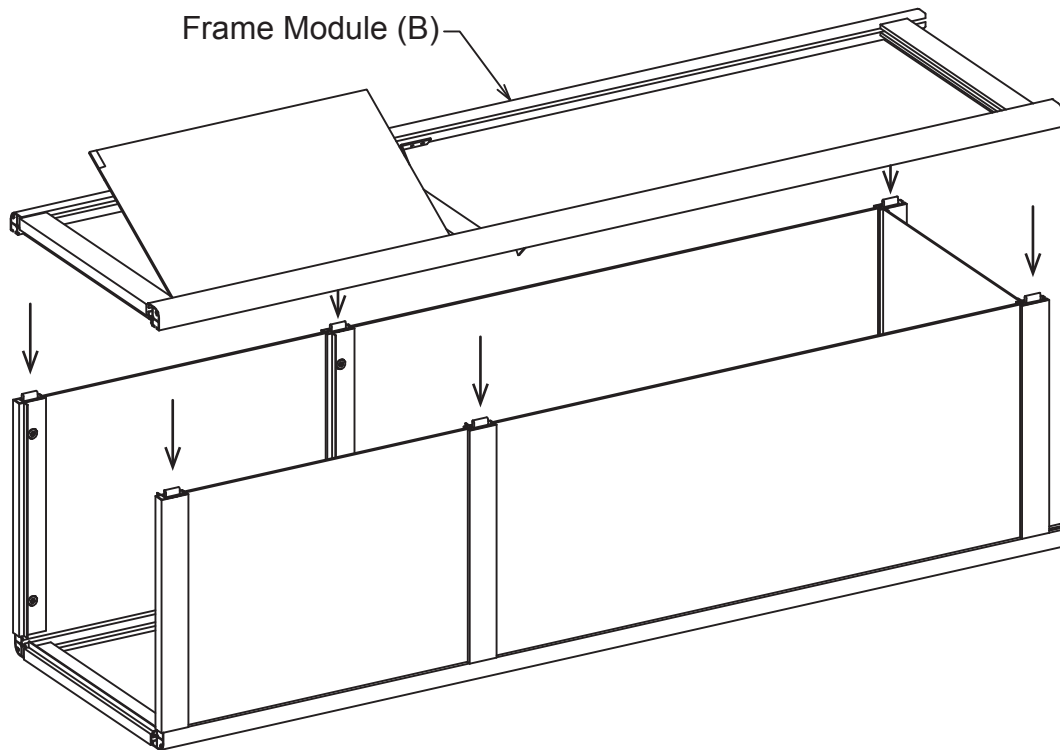

Secure the Frame by tightening all screws in the aluminum bars that connecting with Frame Module with Door (B).

Tips: Open the door with included keys and tighten the screws on the middle bar.

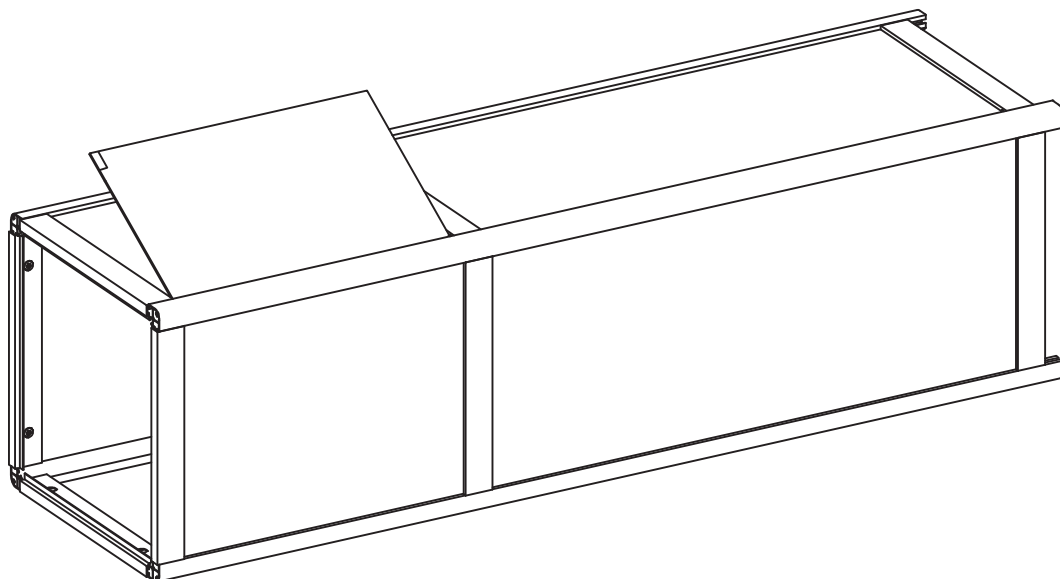

ASSEMBLY INSTRUCTIONS

LEDDCP - Illuminated Metal Pedestal

STEP 4

Carefully lift the assembled pedestal to its standing position.

Open the door on the pedestal and connect the DC wire inside the pedestal with the wire at the bottom of the LED Lighting Panel (I). Place the LED panel on the brackets.

Fix the LED panel by tightening M4X8 Machine screws (M) at 4 corners.

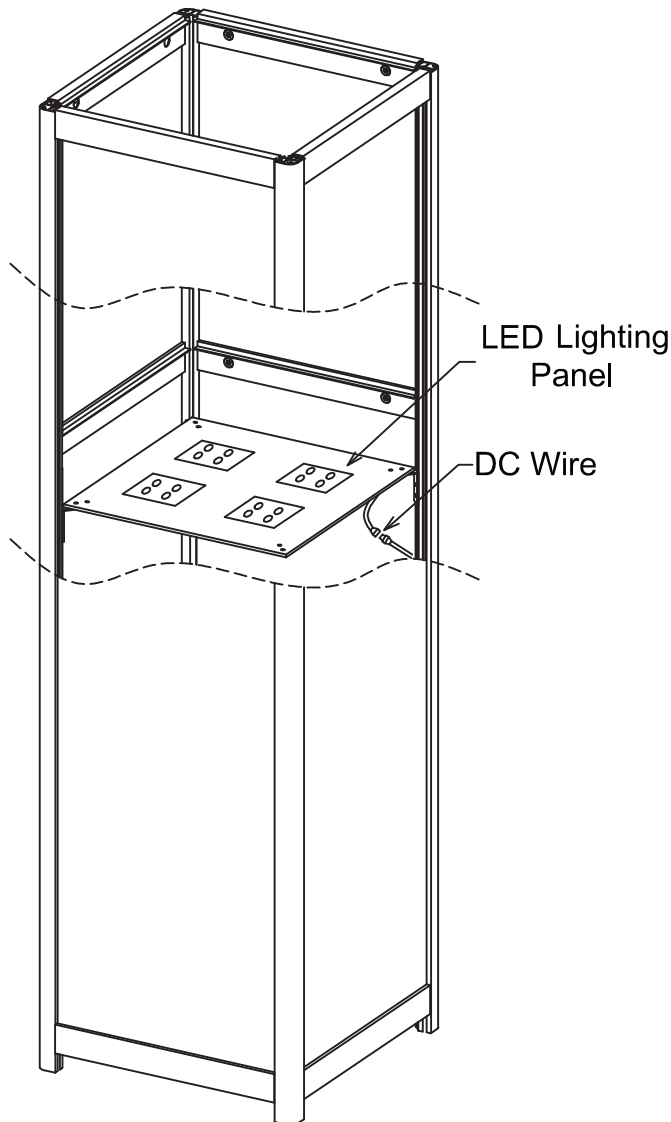

STEP 5

Place the White Panel (J) above the LED lighting Panel as shown below:

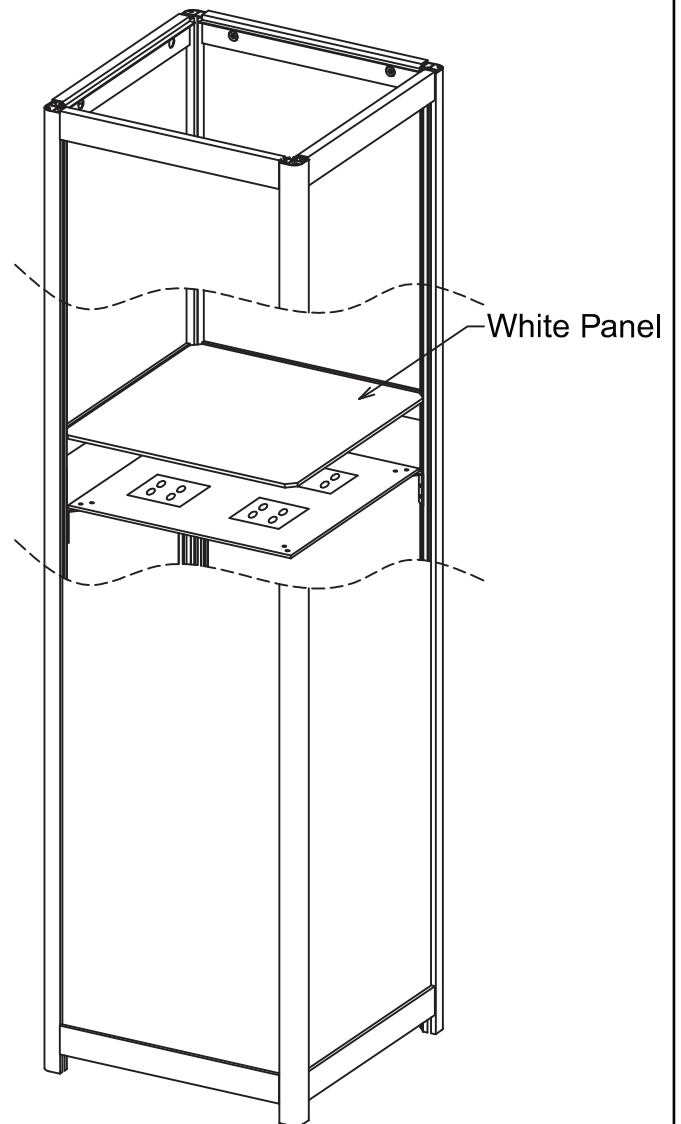

ASSEMBLY INSTRUCTIONS

LEDDCP - Illuminated Metal Pedestal

STEP 6

Place the Top Panel (G) on the top of the pedestal.

Fix the endcaps (K) at 4 top corners by using M3X12 pointed screws (L).

Plug in the power adapter (O) to charge and power the unit. Turn on the switch and the assembly is finished.

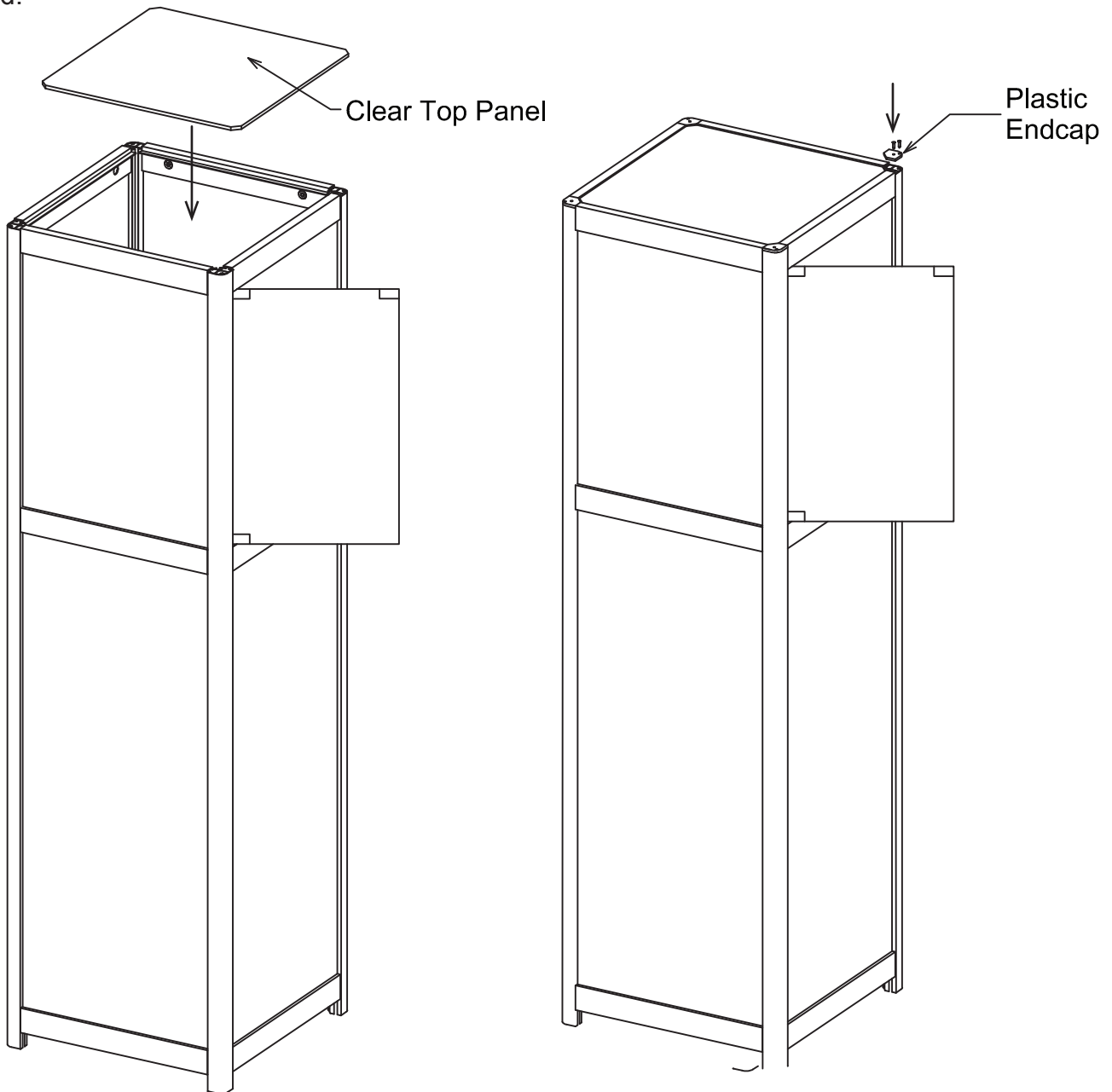

Scan QR code to visit the product page:



If you have any questions regarding our products, please visit us at www.displays2go.com or contact D2G customer service at 844-221-3388.