

# LBSHDR8, LBSHDR12, LBSHDR95, Assembly Instructions

1. If attaching panels to poles use the provided hardware thread the bolt through the brass fitting, through the panel into the weld nut. leave loose. Once all four have been threaded slide weld nut down into rails and tighten at desired height. Screw stainless steel caps onto brass fitting.

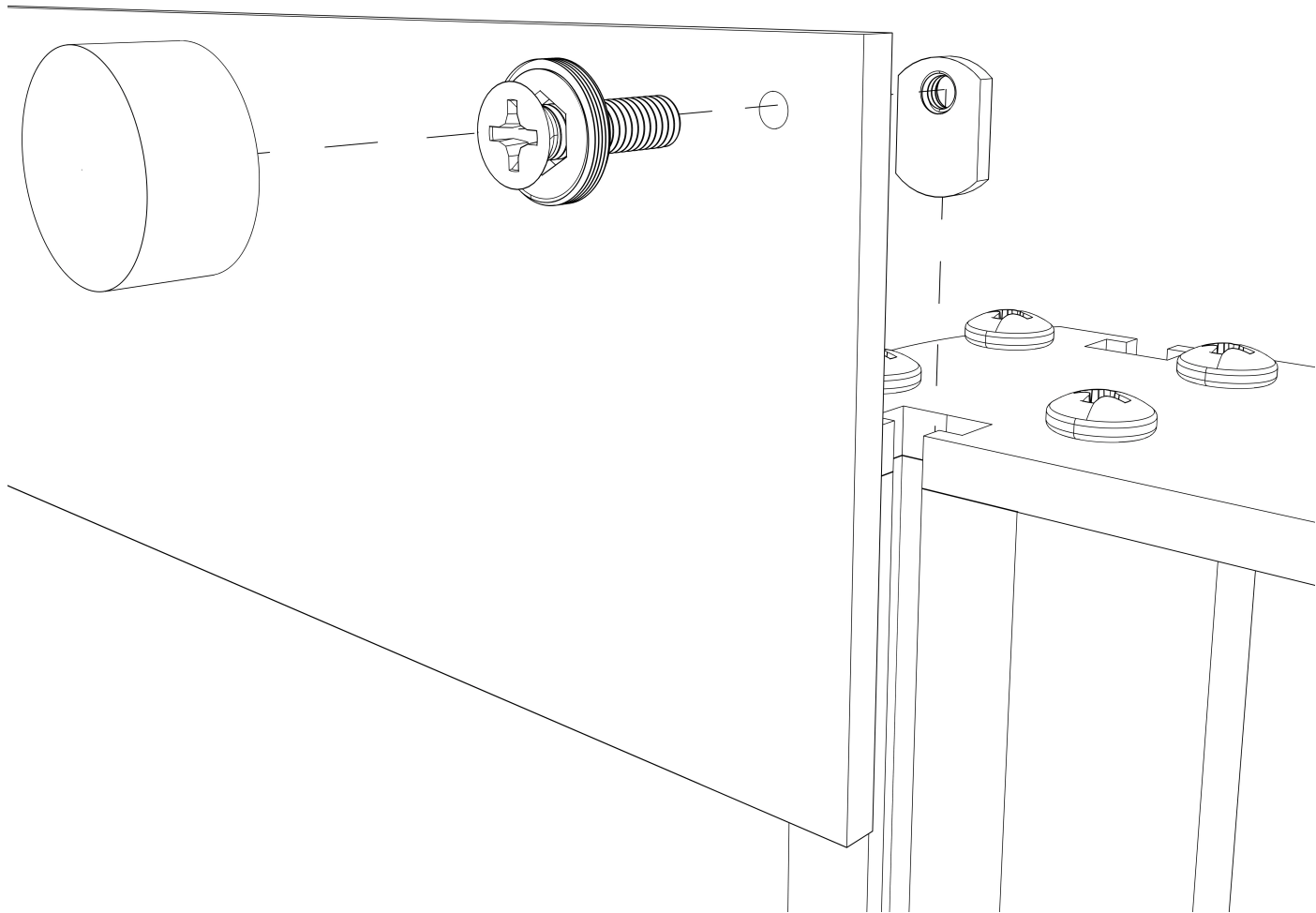

2. If mounting to a wall use the panel as a template for the hole locations. Drill and insert the wall anchor. Thread the screw through the brass fitting, through the panel into the wall anchor. Screw stainless steel caps onto brass fitting.

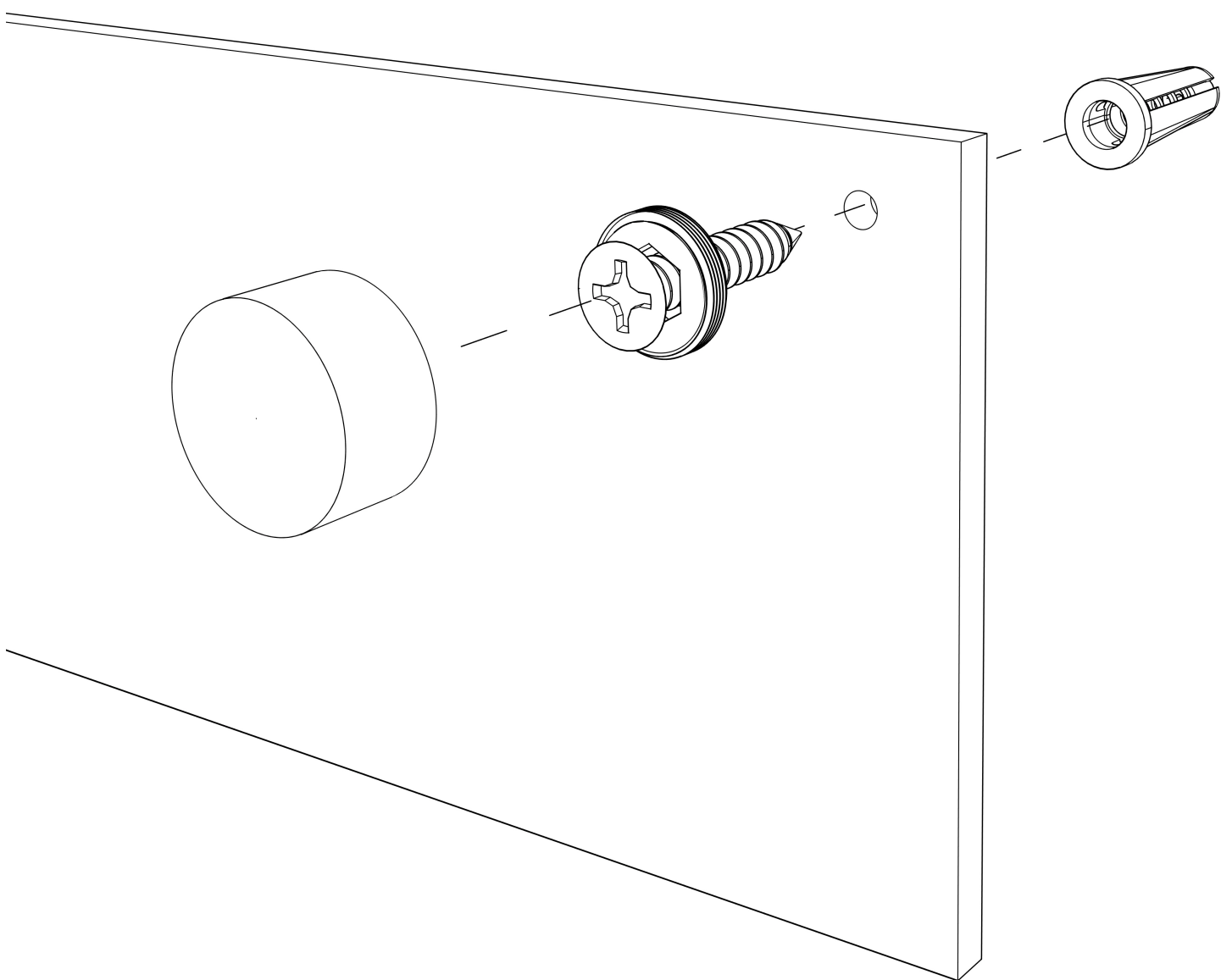

## Standoff Covers

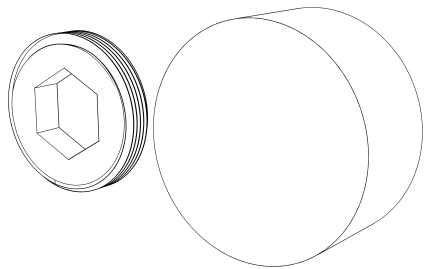

## Wall Screws

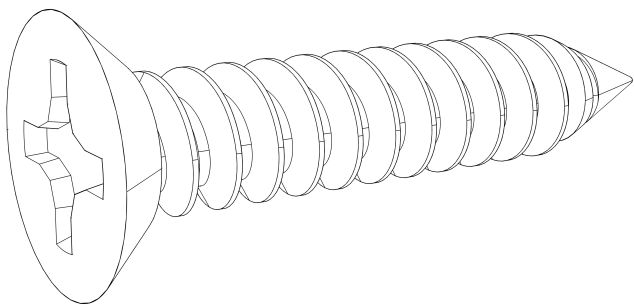

## Wall Anchors

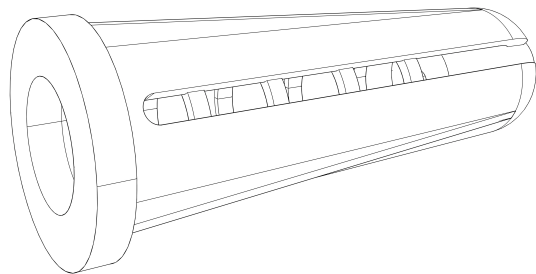

## Flat Head Bolt

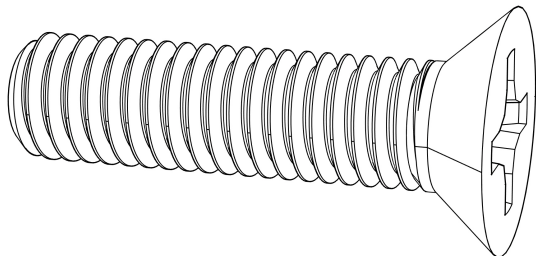

## Weld Nut

