

Components:

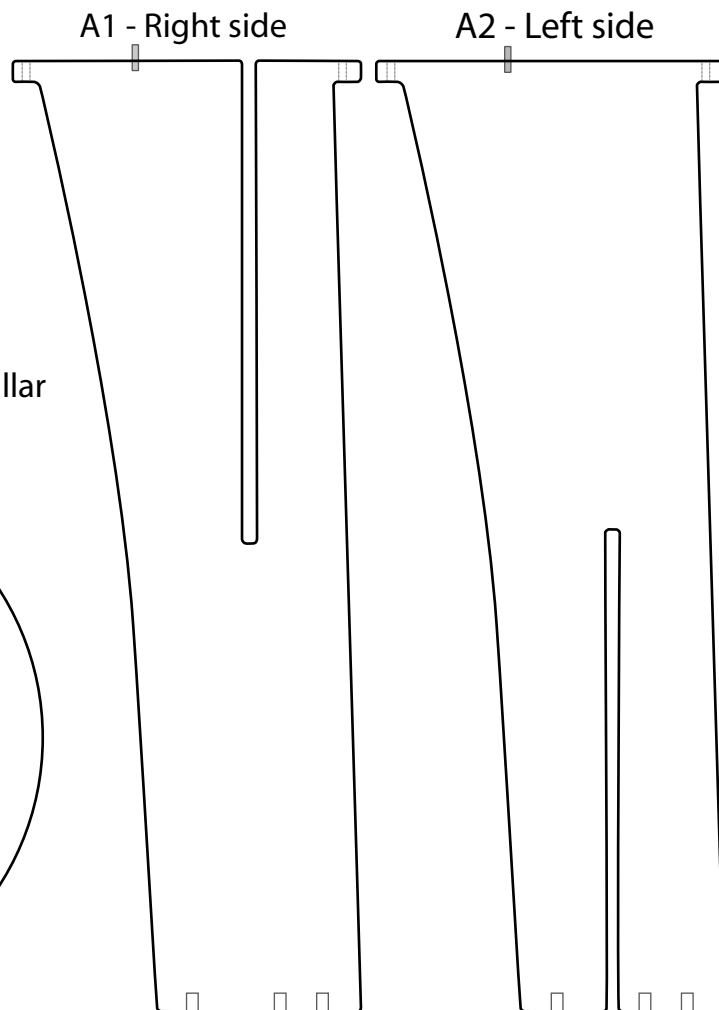

E1 - Small Pillar

E2 - Large Pillar

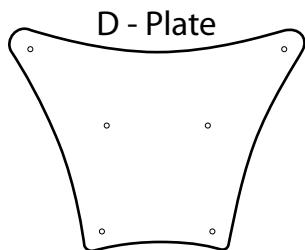
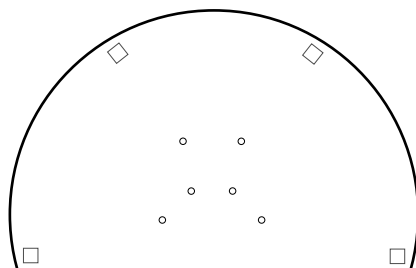
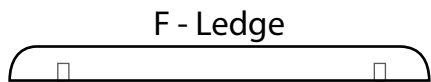
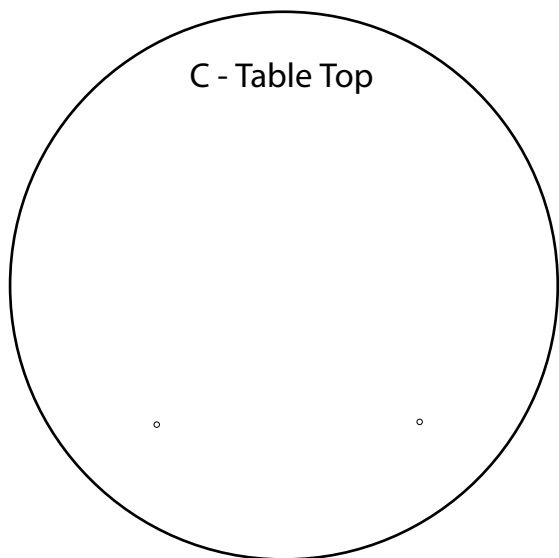

Hardware:

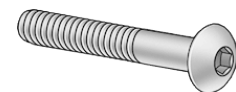

1.5" Screw [x4]

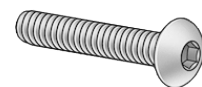

1" Screw [x12]



Wrench



Washer [x16]

Care:



8oz bottle of Novus 1[®]
acrylic cleaner



Soft cloth

Instructions:

Flat-Top Lectern

1. Slide sides (A1 and A2) together with narrow ends facing up.
2. Place base (B) on top of the now joined sides and align holes in the base with threaded inserts on the top edge of the sides.
3. Insert and tighten a 1" screw into each hole using the wrench. Be sure to put on a washer with each screw.
4. Flip over lectern.
5. Place table top (C) on the top of the sides and align the holes in the side to edges to the threaded inserts in the table top.
6. Insert and tighten a 1" screw into each hole using the wrench. Be sure to put on a washer with each screw.
7. If you wish to clean off any dirt or smudges that occurred during assembly, use the soft cloth and Novus 1 cleaning solution provided to clean and de-static your lectern.
8. Enjoy!

Angled Lectern

1. Slide sides (A1 and A2) together with narrow ends facing up.
2. Place base (B) on top of the now joined sides and align holes in the base with threaded inserts on the top edge of the sides. [fig. 2]
3. Insert and tighten a 1" screw into each hole using the wrench. Be sure to put on a washer with each screw.
4. Flip over lectern.
5. Take the table top (C) and attach the pillars (E1 and E2) as shown in [fig. 3] using 1" screws. Be sure to put on a washer with each screw. Do not spin the pillars to tighten them, only use the wrench. Spinning the pillars WILL SCRATCH the acrylic surface.
6. Place the plate (D) on top of the upright sides and align the holes with those on the side pieces. [fig.4]
7. Flip over the table top (with pillars attached) and place on top of the plate.
8. Align the holes in the pillars, plate, and sides. Insert and tighten a 1.5" screw into each hole using the wrench. Remember to not spin the pillars. Also be sure to put on a washer with each screw.
9. Place the ledge (F) on the table top and align the holes with the ledge's inserts.
10. Insert and tighten a 1" screw into each hole using the wrench. Be sure to put on a washer with each screw. [fig.5]
11. If you wish to clean off any dirt or smudges that occurred during assembly, use the soft cloth and Novus 1 cleaning solution provided to clean and de-static your lectern.
12. Enjoy!