

LEDOD Series

Graphic Insertion Instructions

Please Note:

This sign does not come with pre-installed, printed graphics. Customer supplied graphics should be inserted prior to sign installation per the following instructions.



1. Unlock frame using supplied key.
2. Open door.
3. Lift magnetic poster rails located on inside of door.
4. Insert poster in channel below magnetic poster rails.
5. Flip down magnetic strip to secure poster in place.
6. Close frame door.
7. Secure door by pressing center of lock flush with frame. No key required.

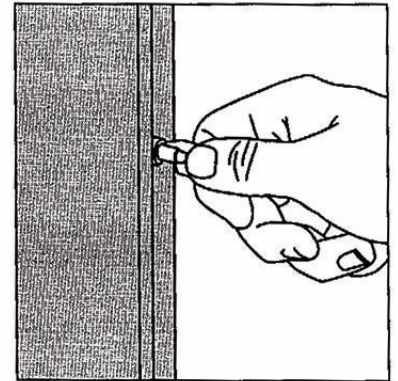

1: Unlock Frame using supplied key.

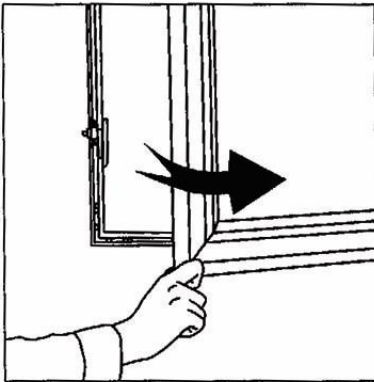

2: Open Door.

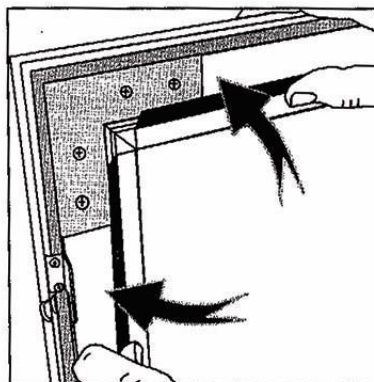

3: Lift magnetic poster rails located on inside of door.

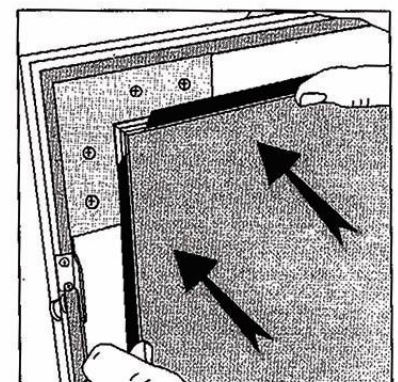

4: Insert poster in channel below magnetic poster rails.

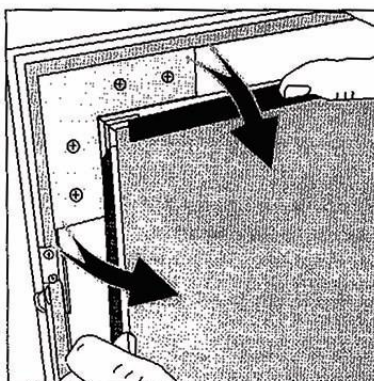

5: Flip down magnetic strip securing poster in place.

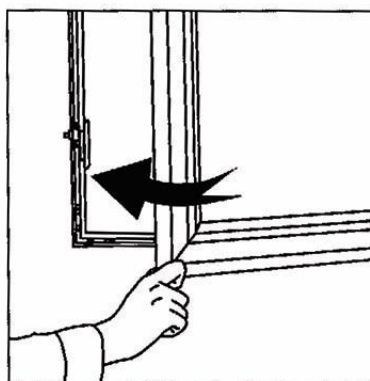

6: Close frame door

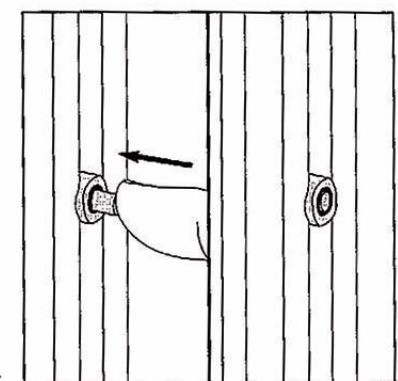

7: Secure door by pressing center of lock flush with frame. No key required.