

Frame is constructed used snap buttons

Step 2

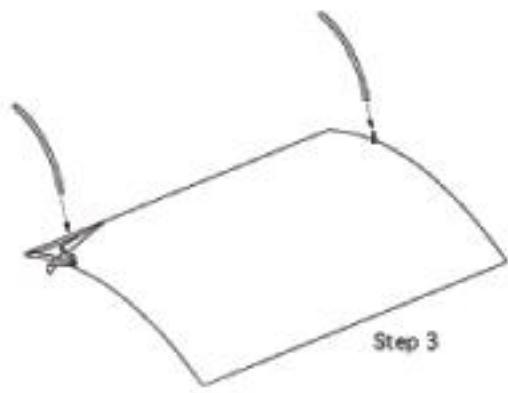

Step 3



Step 4

Fabric structure assembly

Step 1. Unpack small items from case then pull out large tube bag. Ground cloth should be used to keep frame & fabric clean.

Step 2. Assemble frame in numerical order as shown on right. Numbers will be on the back side of the tube. It is best to assemble with the frame laying flat as shown and set upright after the fabric is attached.

Step 3. Stretch fabric over frame.

- When working with fabric use gloves or clean hands and keep fabric away from dirty surfaces.

Pull fabric over frame and secure with zipper. Add legs to back of unit.

Step 4. Stand unit upright.

Adjust leveling feet on back of legs if needed.

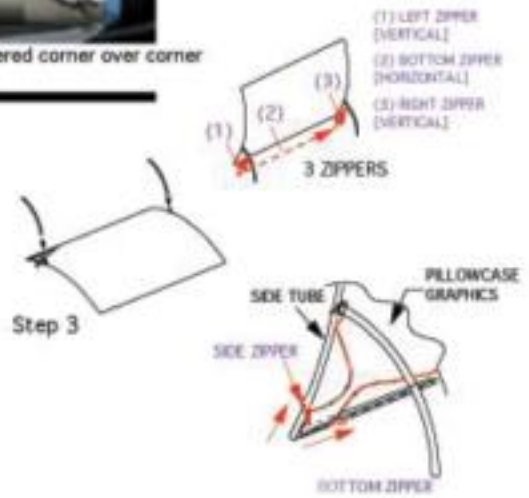
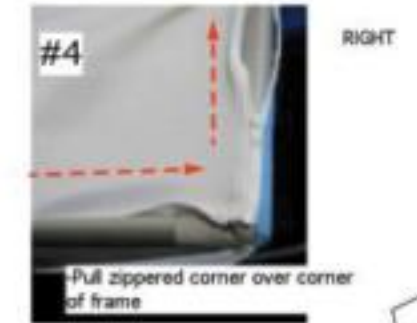

Fabric COVER assembly

Step 3. Stretch fabric over frame.

-When working with fabric use gloves or clean hands and keep fabric away from dirty surfaces.

-Pull fabric over frame. Start all zippers before pulling over the frame. See detail. Work to keep the zippers evenly aligned along the bottom tube.

- Add legs to back of unit

Step 4. Stand unit upright.

- Adjust leveling feet on back of legs if needed.