

DISPLAYS2GO

SKU: TBSH3WT

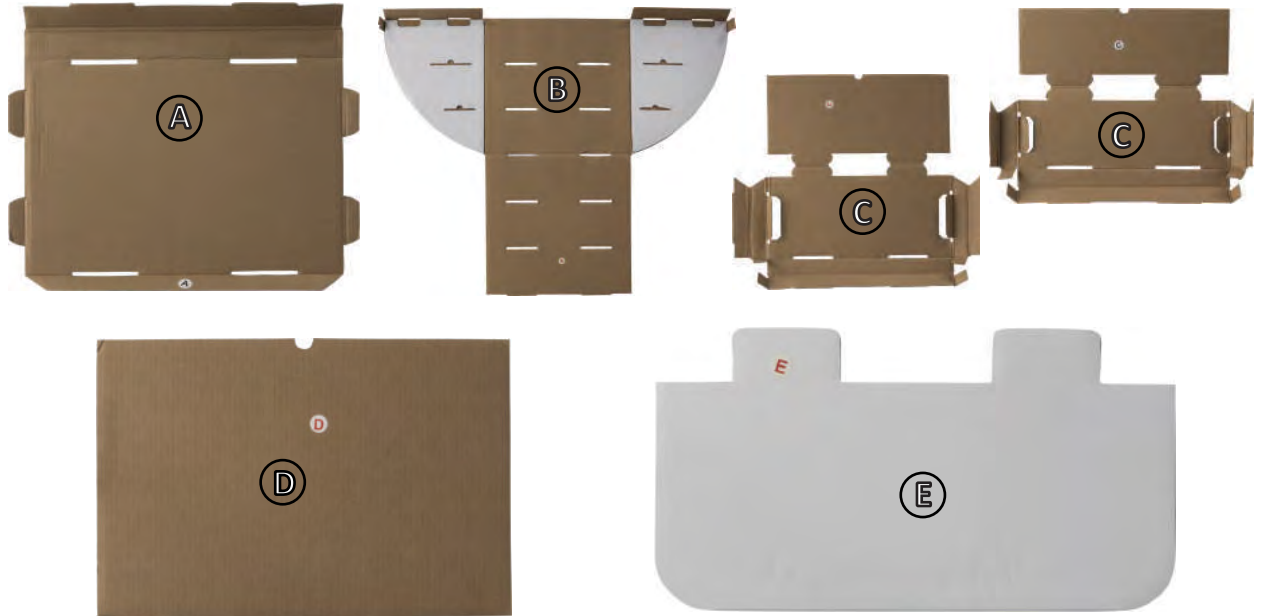

Included Pieces:



Scan QR code to visit the product page:



ASSEMBLY INSTRUCTIONS

1. Lay the Body (B) flat on a flat and clean surface.
2. Fold up one side of Base (A) and insert between 2 boards on Body (B).
NOTE: Small tabs on Base should be at front.
3. Keep the Body upright and insert tabs on sides of Body (B) into Base (A).



4. Insert the Bottom Shelf Cover (D) into the Base and press down.



5. Fold the front lip of Base (A) over to form the bottom tray.



6. To form Shelves (C), fold the front perforated lip up and over the tabs on the shelf sides.

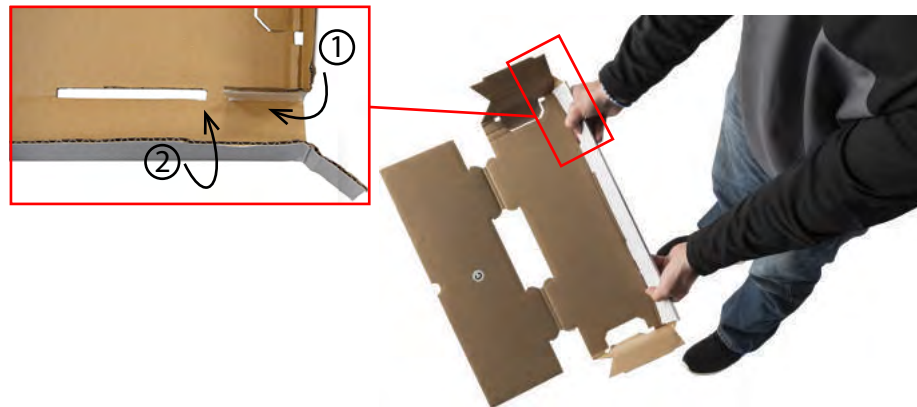

7. Insert tabs on the front lip into the corresponding cutouts in the base of the tray.



8. Fold the side flaps over the tab on the front. insert tabs into the corresponding cutout in the base.

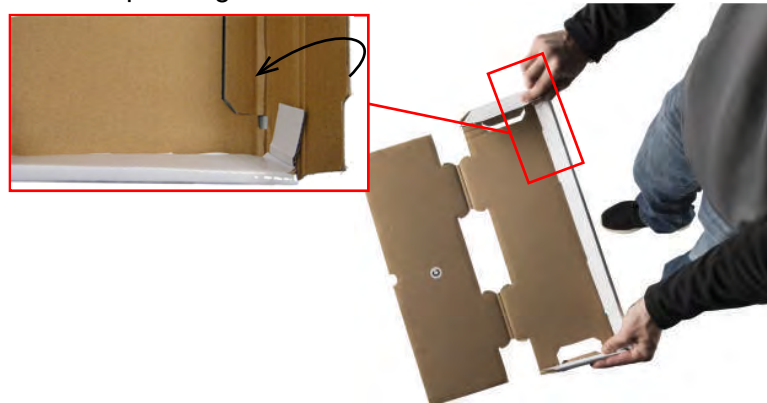

9. Fold the bottom cover over into place. Repeat Step 6 to 9 to form the other shelf.



10. Insert tabs on the shelf into the cutouts on the back of the base body.

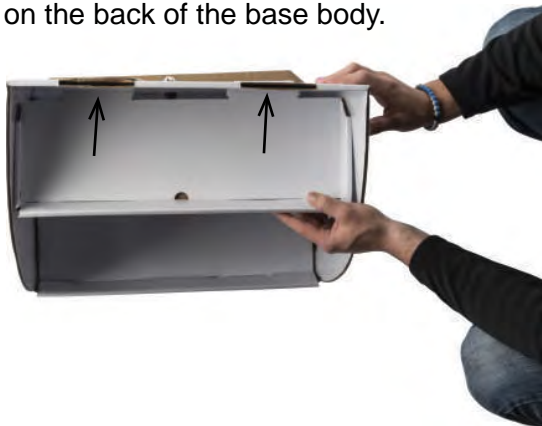

11. Fold the side tabs at the bottom of the shelves down and insert tabs into the corresponding slots on the side of the base.



12. Assemble the other shelf the same way. Insert the Header (E) on top and the assembly is finished.



If you have any questions regarding our products, please visit us at www.displays2go.com or contact D2G customer service 844-221-3388.