

Fold both triangular flaps inward, inserting small tabs into slots.

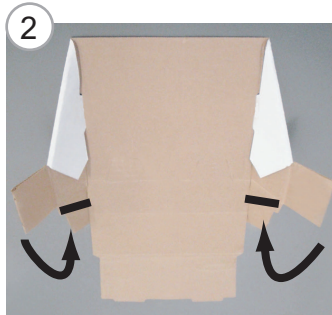

Fold both downward/side tabs upward 90 degrees.

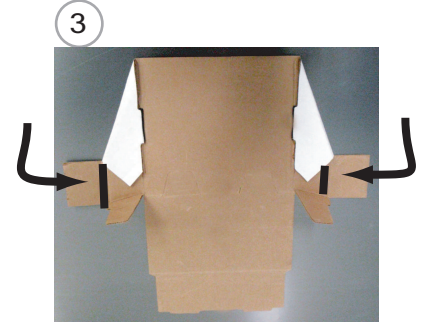

Fold both side tabs inward 90 degrees.

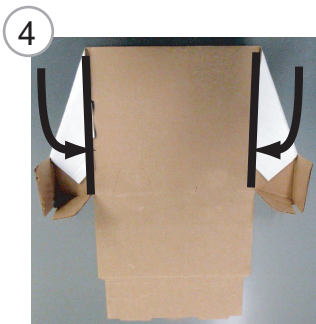

Bring vertical folds inward, creating sides.



Fold up at horizontal line in picture, creating bottom of display.

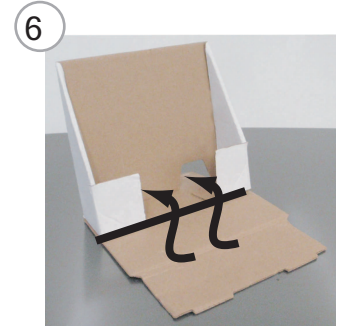

Press the 2 back support flaps out while folding at the mid- horizontal fold line.

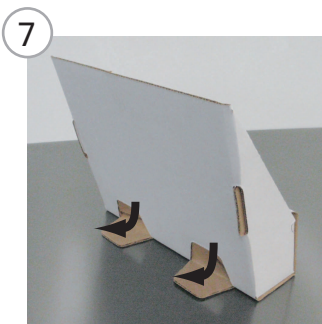

Here you see both back support tabs pressed out.



Finally fold at last horizontal line, tucking it inside, completing your display box.



Your display box is done.