

Assembly Instructions

Wall Mounted Phone Charging

1

Open front panel by unlocking the two locks at the top.

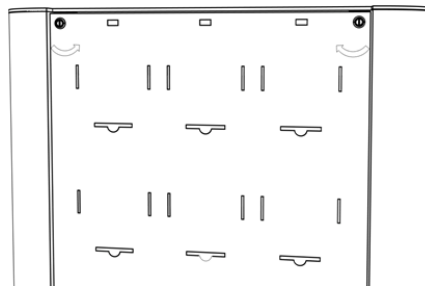

2

Run power cable through the opening in the back of the unit and plug it into the power hub.

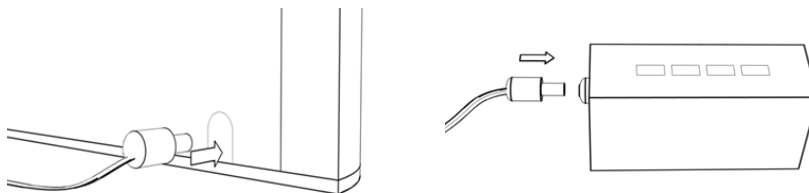

3

Feed USB cables through each "A" opening.

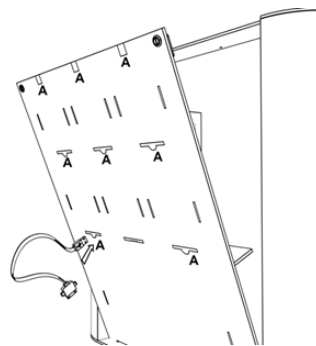

main unit

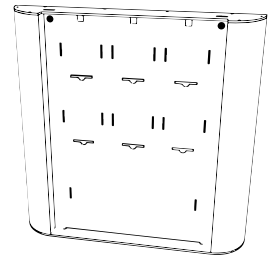

power cable/source

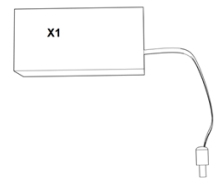

power hub



device pockets



USB cable

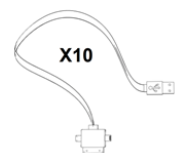

4

Plug USB cables into power hub.

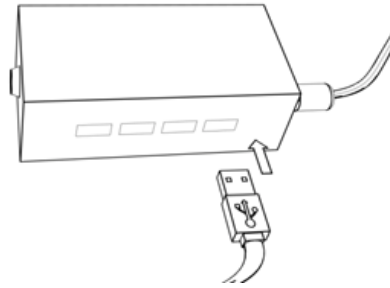

5

Close front panel and lock to secure.

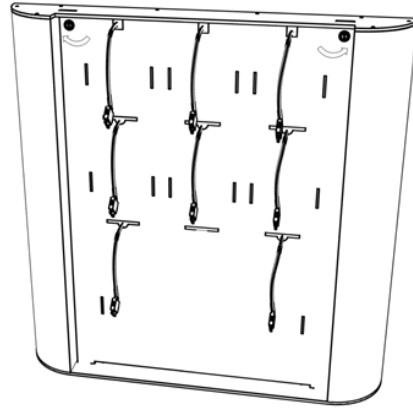

6

Attach device pockets by sliding hook tabs into slots. Push in and down on center of pocket. Pockets will snap into place. Repeat for all pockets.

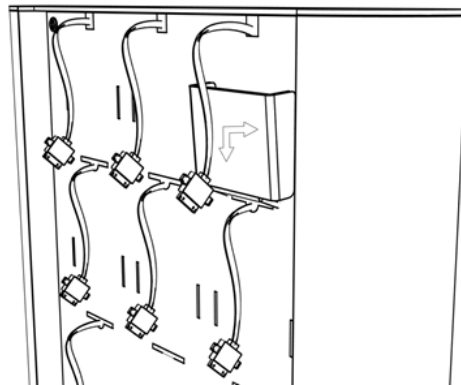

SKUs:

WMCHG8HD, WMCHG8HDCM, WMCHG8HDS1, WMCHG8HDS2, WMCHG8HDS3